

RIGHT ANGLE SECTION OF BARREL
THERE ARE 34 "C" BARS IN SECTION OF BARREL

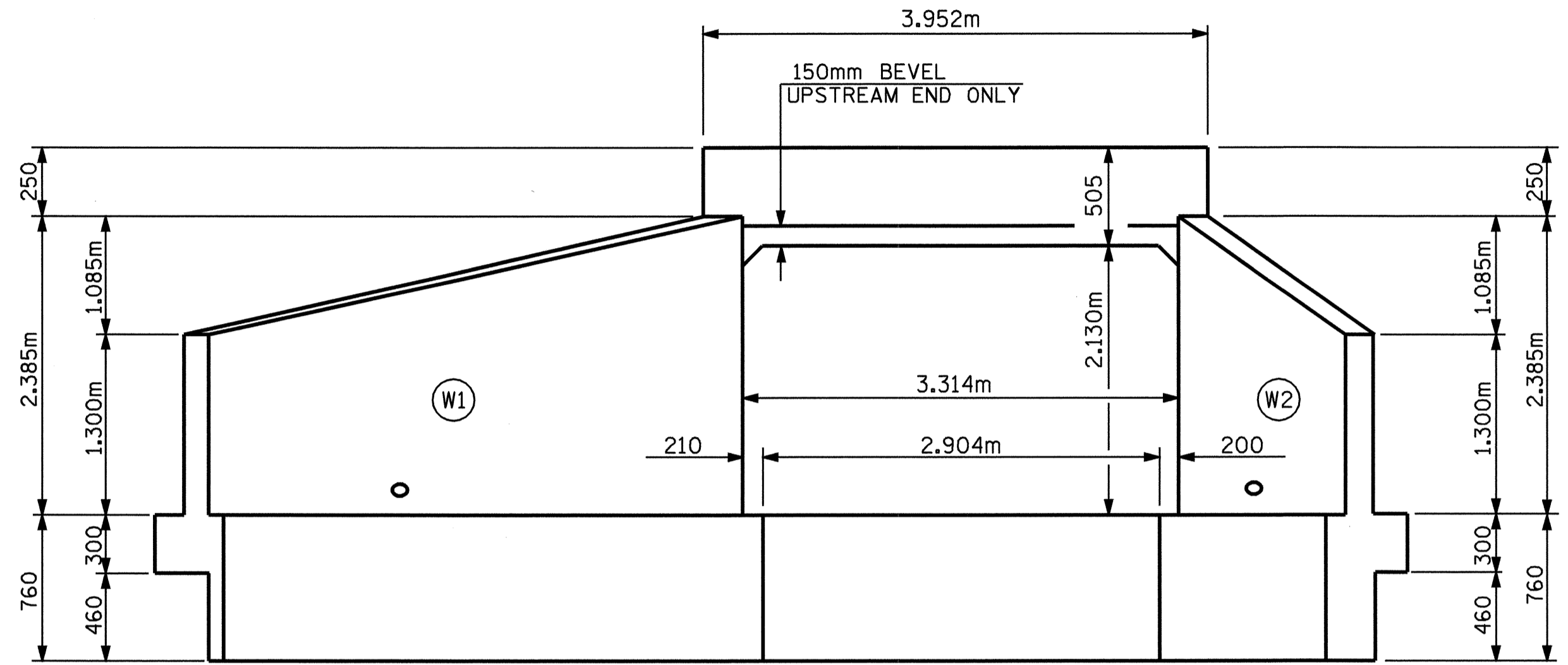

END ELEVATION NORMAL TO SKEW

| BILL OF MATERIAL FOR BARREL | | | | | |
|-----------------------------|-----|------|------|--------|---------|
| BAR | NO. | SIZE | TYPE | LENGTH | WEIGHT |
| A100 | 128 | 16 | STR | 2360 | 469 |
| A101 | 2 | 16 | STR | 2000 | 6 |
| A102 | 2 | 16 | STR | 1660 | 5 |
| A103 | 2 | 16 | STR | 1300 | 4 |
| A104 | 2 | 16 | STR | 960 | 3 |
| A105 | 2 | 16 | STR | 600 | 2 |
| A106 | 1 | 16 | STR | 2360 | 4 |
| A151 | 2 | 16 | STR | 1940 | 6 |
| A152 | 2 | 16 | STR | 1520 | 5 |
| A153 | 2 | 16 | STR | 1100 | 3 |
| A154 | 2 | 16 | STR | 680 | 2 |
| A200 | 142 | 16 | STR | 2360 | 520 |
| A201 | 3 | 16 | STR | 1880 | 9 |
| A202 | 3 | 16 | STR | 1420 | 7 |
| A203 | 3 | 16 | STR | 940 | 4 |
| A204 | 1 | 16 | STR | 2360 | 4 |
| A251 | 2 | 16 | STR | 1980 | 6 |
| A252 | 2 | 16 | STR | 1600 | 5 |
| A253 | 2 | 16 | STR | 1220 | 4 |
| A254 | 2 | 16 | STR | 840 | 3 |
| A1 | 350 | 13 | 6 | 1280 | 445 |
| A2 | 350 | 13 | 6 | 1240 | 431 |
| B1 | 238 | 13 | STR | 2360 | 558 |
| B2 | 350 | 13 | STR | 1880 | 654 |
| C1 | 136 | 13 | STR | 7920 | 1071 |
| D1 | 24 | 19 | STR | 760 | 41 |
| G1 | 2 | 13 | STR | 3740 | 7 |
| S2 | 6 | 25 | STR | 3740 | 89 |
| S3 | 6 | 25 | STR | 3400 | 81 |
| TOTAL | | | | | 4448 kg |

| SPLICE LENGTH CHART | | |
|---------------------|------|---------------|
| BAR | SIZE | SPLICE LENGTH |
| B1 | 13 | 540 |
| C1 | 13 | 590 MIN. |

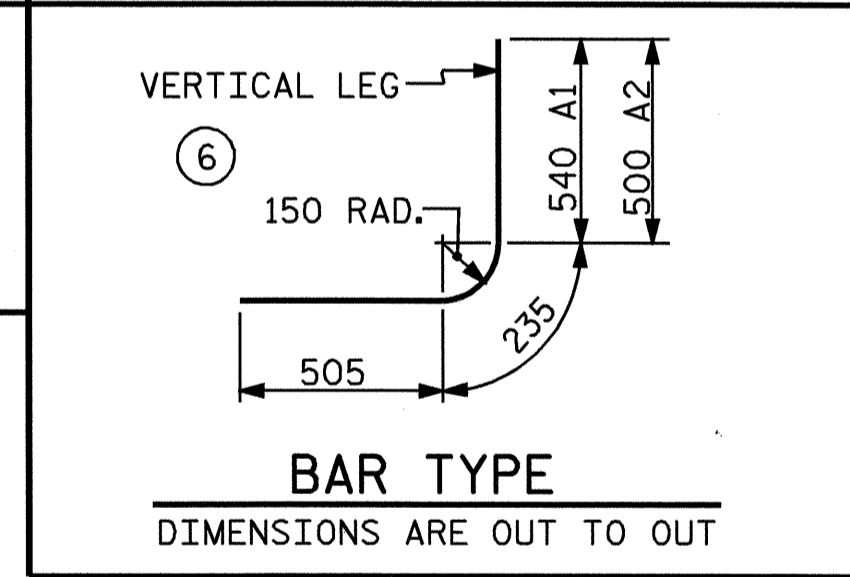

PROJECT NO. R-2610A
CHATHAM COUNTY
STATION: 62+33.970 -L-

SHEET 5 OF 6
STATE OF NORTH CAROLINA
DEPARTMENT OF TRANSPORTATION
RALEIGH
SINGLE
2.130m X 2.130m
CONCRETE BOX CULVERT
EXTENSION

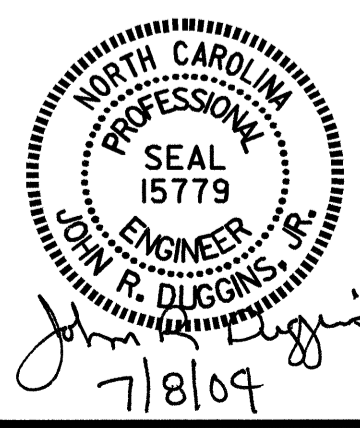

| | |
|---------------------------|--------------|
| ASSEMBLED BY : J. LAMBERT | DATE : 10/03 |
| CHECKED BY : S. PEARCE | DATE : 11/03 |
| DRAWN BY : EEM | 6/97 |
| CHECKED BY : ARB | 7/97 |

| REVISIONS | | | | | SHEET NO. |
|-----------|-----|-------|-----|-----|-----------|
| NO. | BY: | DATE: | NO. | BY: | DATE: |
| 1 | | | 3 | | |
| 2 | | | 4 | | |

TOTAL SHEETS 18