

STATE OF NORTH CAROLINA  
DEPARTMENT OF TRANSPORTATION

TIP NO. R-2610A	SHEET NO. SIGN-1
--------------------	---------------------



**SIGNING PLANS  
CHATHAM COUNTY**

**LOCATION: US 421 FROM 4 LANES APPROX. 200M SOUTH  
OF SR 1007 AT GULF TO APPROX. 1 KM  
NORTH OF SR 1010**

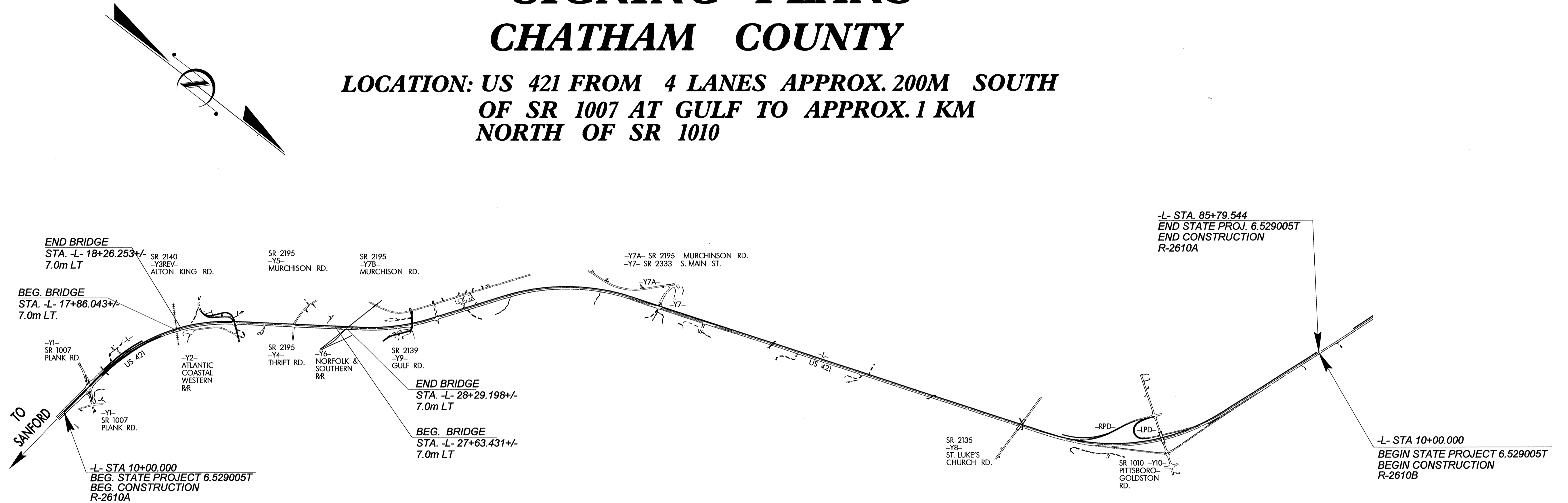

**T.I.P.: R-2610A**

**CONTRACT: C200820**

PLAN REVIEWED BY: N.C.D.O.T. SIGNING SECTION

R.W. KING, PE SIGNING ENGINEER

A.I. ALQUDWAH, PE SIGNING PROJECT ENGINEER

S. PIOTROWSKI SIGNING DESIGN ENGINEER

PLAN PREPARED BY:

**SEPI ENGINEERING GROUP**

2300 Rexwoods Drive  
Suite 370  
Raleigh, NC 27607  
Tel: 919-789-9977 Fax: 789-9591

SEAL

PLANS REVIEWED BY: **SEPIDEH ASEFNIA, PE**

PLANS DESIGNED BY: **RICHARD DRAYTON**

PLANS PREPARED BY: **RICHARD DRAYTON**

**INDEX**

SHEET NO.	DESCRIPTION
1	TITLE SHEET
2	SUMMARY OF QUANTITIES and applicable ROADWAY STANDARD DRAWINGS
3	NOTES
4	SUPPORT INFORMATION
5 and 6	E SHEETS
7	F SHEETS
8 - 14	EXISTING SIGN ROADWAY SHEETS
15 - 23	PROPOSED SIGN ROADWAY SHEETS