	PROJECT REFERENCE NO.	SHEET NO.
	R-2610 A	EC-46/CONST.20
	R/W SHEET NO.	
	ROADWAY DESIGN ENGINEER	HYDRAULICS ENGINEER
CONST.REV.		

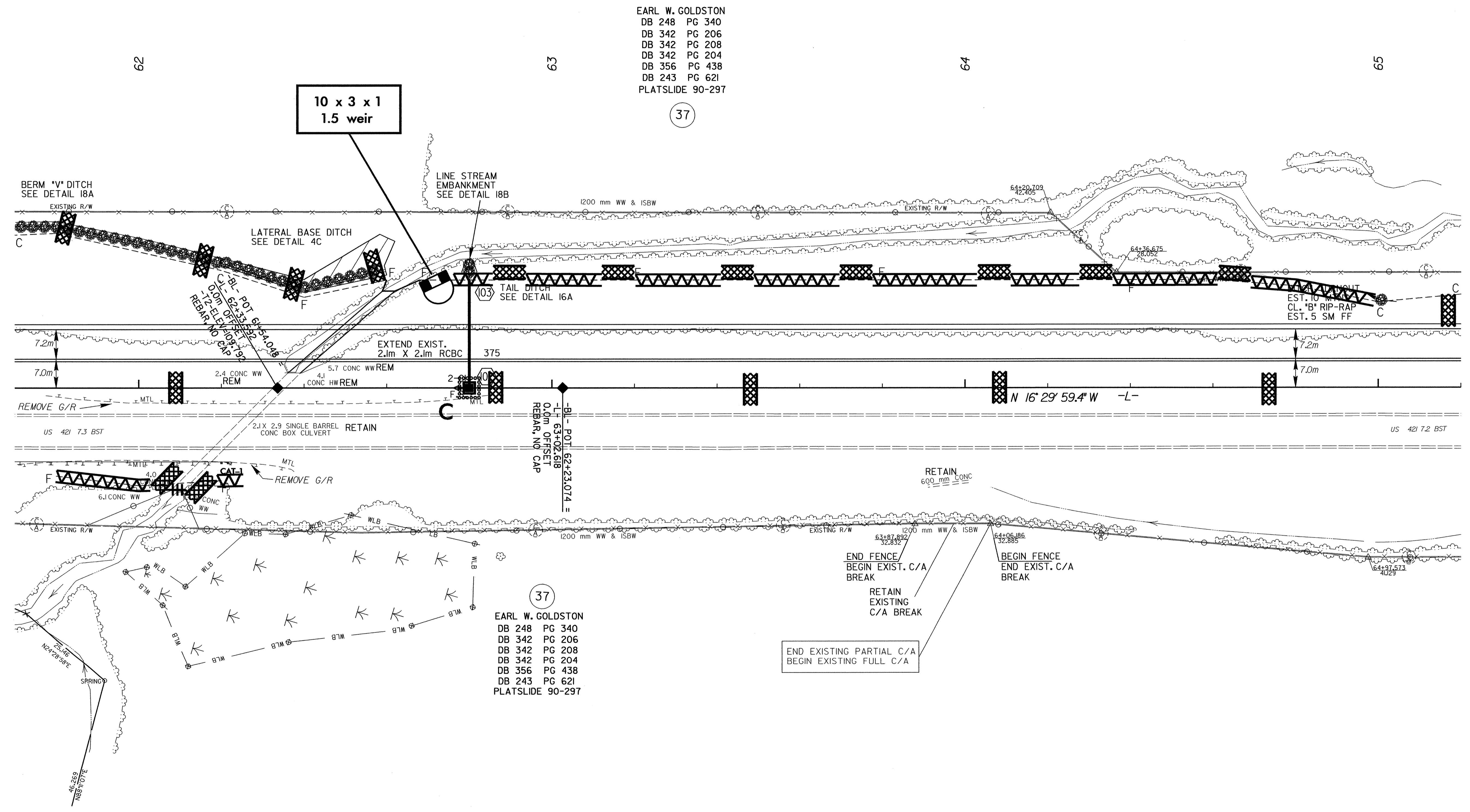

EARL W. GOLDSTON
 DB 248 PG 340
 DB 342 PG 206
 DB 342 PG 208
 DB 342 PG 204
 DB 356 PG 438
 DB 243 PG 621
 PLATSLIDE 90-297

(37)

(37)

EARL W. GOLDSTON
 DB 248 PG 340
 DB 342 PG 206
 DB 342 PG 208
 DB 342 PG 204
 DB 356 PG 438
 DB 243 PG 621
 PLATSLIDE 90-297

END EXISTING PARTIAL C/A
 BEGIN EXISTING FULL C/A