

ROADWAY DESIGN ENGINEER HYDRAULICS ENGINEER

**PRELIMINARY PLANS**  
DO NOT USE FOR CONSTRUCTION

**INCOMPLETE PLANS**  
DO NOT USE FOR R/W ACQUISITION

BM #1 ELEVATION = 395.26'  
N = 987709 E = 1935583  
-BL STATION 5+69 43' RIGHT  
RR SPIKE SET IN 12" CEDAR

BM #2 ELEVATION = 389.05'  
N = 987775 E = 1936158  
-BL STATION 11+35 164' RIGHT  
RR SPIKE SET IN 16" OAK

**CULVERT HYDRAULIC DATA**

|                       |   |     |
|-----------------------|---|-----|
| DESIGN DISCHARGE      | = | CFS |
| DESIGN FREQUENCY      | = | YRS |
| DESIGN HW ELEVATION   | = | FT  |
| BASE DISCHARGE        | = | CFS |
| BASE FREQUENCY        | = | YRS |
| BASE HW ELEVATION     | = | FT  |
| OVERTOPPING DISCHARGE | = | CFS |
| OVERTOPPING FREQUENCY | = | YRS |
| OVERTOPPING ELEVATION | = | FT  |

**CULVERT @ STA. 15+91 -L- OVER PRONG OF COUNTRY LINE CREEK**

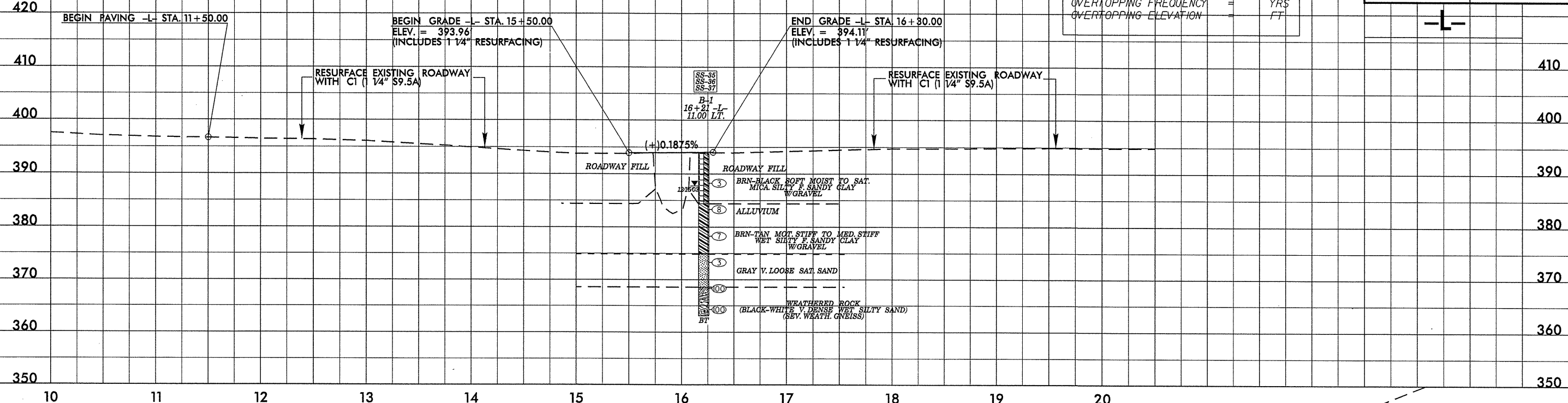

BM #3 ELEVATION = 387.46'  
N = 988000 E = 1937193  
-BL STATION 22+00 274' RIGHT  
RR SPIKE SET IN 16" OAK

BEGIN GRADE -L- STA. 24+50.00  
ELEV. = 394.41'  
(INCLUDES 1 1/4" RESURFACING)

**BRIDGE NO. 11 OVER COUNTRY LINE CREEK**

DESIGN EXCEPTION REQUIRED FOR SAG VERTICAL CURVE AND MAXIMUM GRADE.

RESURFACE EXISTING ROADWAY WITH C1 (1 1/4" S9.5A)

END GRADE -L- STA. 32+00.00  
ELEV. = 412.71'  
(INCLUDES 1 1/4" RESURFACING)

BM #4 ELEVATION = 421.46'  
N = 988274 E = 1937796  
-BL STATION 28+78 126' RIGHT  
RR SPIKE SET IN 16" PINE

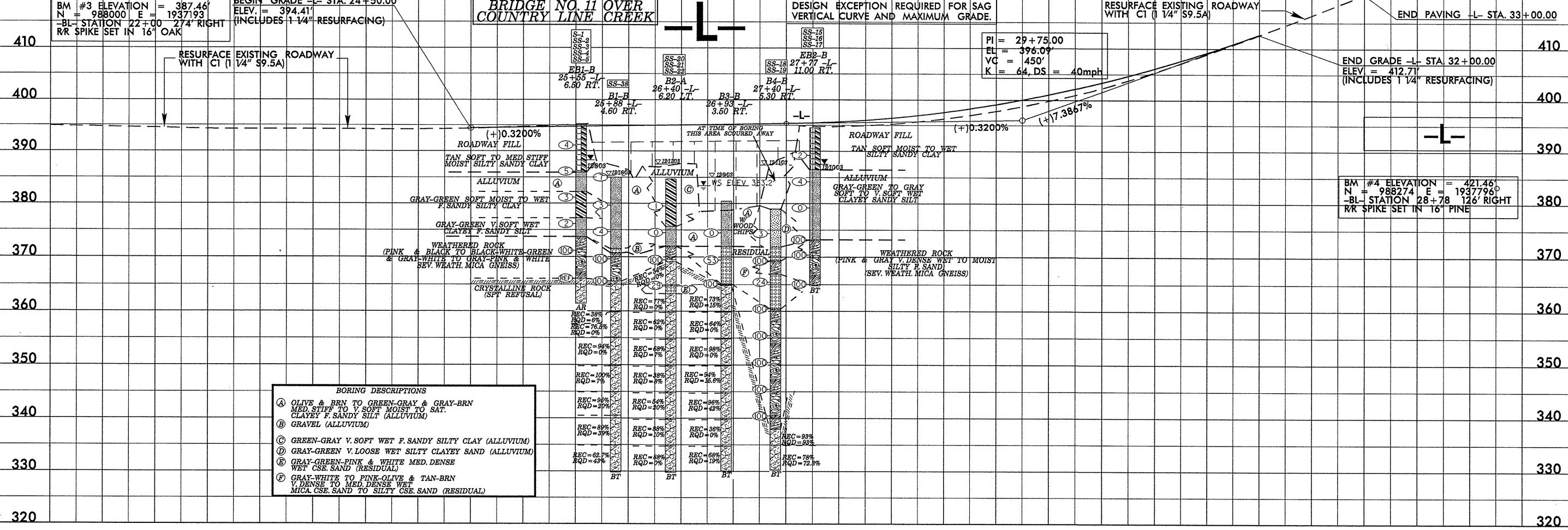

- BORING DESCRIPTIONS**
- Ⓐ OLIVE & BRN TO GREEN-GRAY & GRAY-BRN MED. STIFF TO V. SOFT MOIST TO SAT. CLAYEY F. SANDY SILT (ALLUVIUM)
  - Ⓑ GRAVEL (ALLUVIUM)
  - Ⓒ GREEN-GRAY V. SOFT WET F. SANDY SILTY CLAY (ALLUVIUM)
  - Ⓓ GRAY-GREEN V. LOOSE WET SILTY CLAYEY SAND (ALLUVIUM)
  - Ⓔ GRAY-GREEN-PINK & WHITE MED. DENSE WET CSE. SAND (RESIDUAL)
  - Ⓕ GRAY-WHITE TO PINK-OLIVE & TAN-BRN V. DENSE TO MED. DENSE WET MICA. CSE. SAND TO SILTY CSE. SAND (RESIDUAL)

|                        |                        |                          |                          |
|------------------------|------------------------|--------------------------|--------------------------|
| REC = 38%<br>RQD = 0%  | REC = 62%<br>RQD = 0%  | REC = 77%<br>RQD = 0%    | REC = 93%<br>RQD = 88%   |
| REC = 76%<br>RQD = 0%  | REC = 62%<br>RQD = 0%  | REC = 64%<br>RQD = 0%    | REC = 78%<br>RQD = 72.5% |
| REC = 94%<br>RQD = 0%  | REC = 65%<br>RQD = 0%  | REC = 88%<br>RQD = 0%    |                          |
| REC = 100%<br>RQD = 7% | REC = 38%<br>RQD = 6%  | REC = 94%<br>RQD = 15.8% |                          |
| REC = 96%<br>RQD = 20% | REC = 64%<br>RQD = 10% | REC = 96%<br>RQD = 42%   |                          |
| REC = 88%<br>RQD = 39% | REC = 88%<br>RQD = 10% | REC = 36%<br>RQD = 0%    |                          |
| REC = 62%<br>RQD = 43% | REC = 88%<br>RQD = 0%  | REC = 68%<br>RQD = 19%   |                          |