

5/28/99

ENGLISH	PROJECT REFERENCE NO.	SHEET NO.
	B-4010	6
CONST. REV.	ROADWAY DESIGN ENGINEER	HYDRAULICS ENGINEER
R/W REV.	SEAL 21122	SEAL 18181
	MICHAEL J. MERRITT	JOHN H. SWILEY
	May 3, 2004	5/2/04

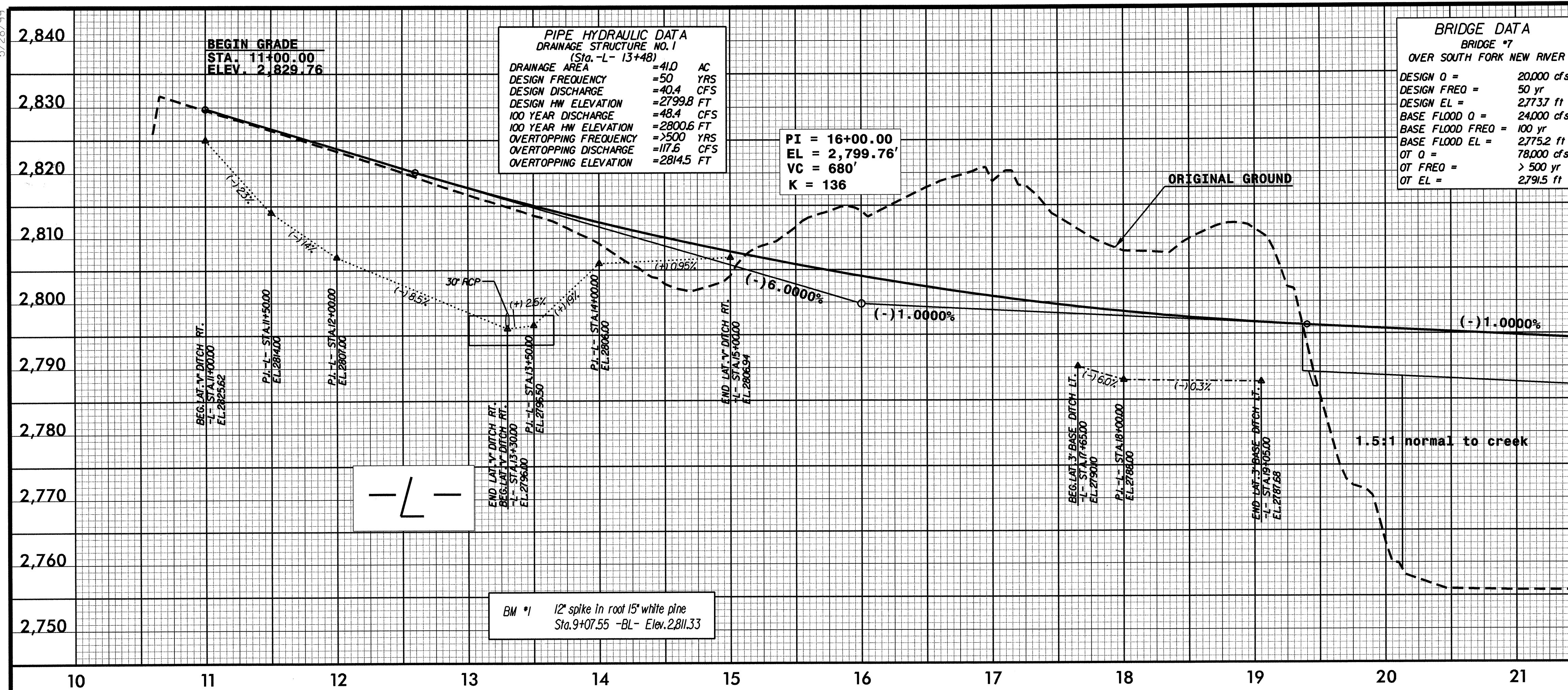

PIPE HYDRAULIC DATA
 DRAINAGE STRUCTURE NO. 1
 (Sta. -L- 13+48)

DRAINAGE AREA	=41.0	AC
DESIGN FREQUENCY	=50	YRS
DESIGN DISCHARGE	=40.4	CFS
DESIGN HW ELEVATION	=2799.8	FT
100 YEAR DISCHARGE	=48.4	CFS
100 YEAR HW ELEVATION	=2800.6	FT
OVERTOPPING FREQUENCY	=>500	YRS
OVERTOPPING DISCHARGE	=117.6	CFS
OVERTOPPING ELEVATION	=2814.5	FT

BRIDGE DATA
 BRIDGE #7
 OVER SOUTH FORK NEW RIVER

DESIGN Q =	20,000	cf/s
DESIGN FREQ =	50	yr
DESIGN EL =	2,773.7	ft
BASE FLOOD Q =	24,000	cf/s
BASE FLOOD FREQ =	100	yr
BASE FLOOD EL =	2,775.2	ft
OT Q =	78,000	cf/s
OT FREQ =	> 500	yr
OT EL =	2,791.5	ft

PI = 16+00.00
 EL = 2,799.76'
 VC = 680'
 K = 136

BM #1 12" spike in root 15' white pine
 Sta. 9+07.55 -BL- Elev. 2,811.33

BM #2 Spike nail in rock
 Sta. 16+29.47 -BL- Elev. 2,770.15

04/29/2004
 F:\Roadway\Proj\B4010_L_rdy-pl1.dgn

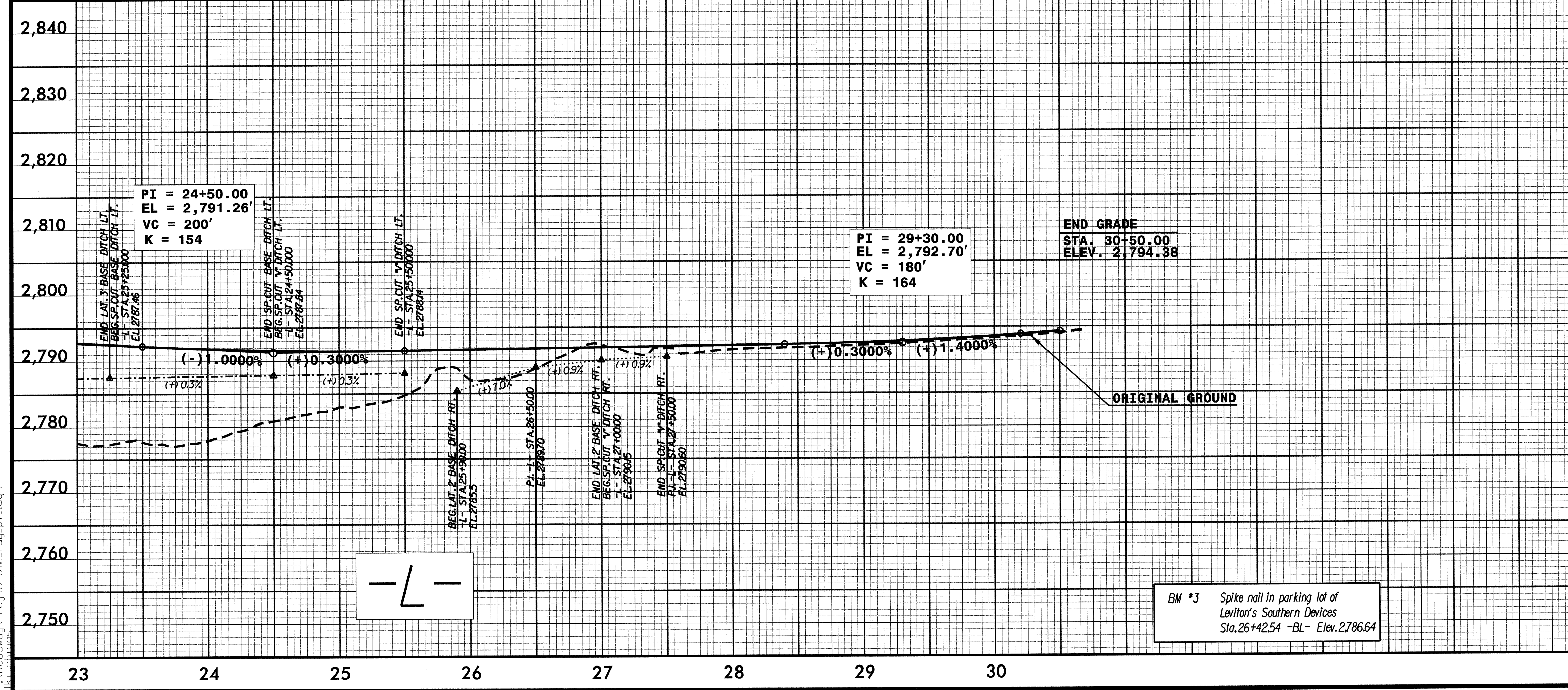

PI = 24+50.00
 EL = 2,791.26'
 VC = 200'
 K = 154

END GRADE
 STA. 30+50.00
 ELEV. 2,794.38

PI = 29+30.00
 EL = 2,792.70'
 VC = 180'
 K = 164

BM #3 Spike nail in parking lot of
 Leviton's Southern Devices
 Sta. 26+42.54 -BL- Elev. 2,786.64