

Note:
**DESIGN EXCEPTION REQUIRED
 FOR MAXIMUM GRADE,
 SAG VERTICAL CURVE AND
 VERTICAL SSD**

PROJECT REFERENCE NO. B-3901	SHEET NO. 4
RW SHEET NO.	
B.S. Moore 7/14/04	R.C. Hinegar 7-15-04

-L-			
PI Sta 19+02.65	PI Sta 21+79.81	PI Sta 29+20.21	PI Sta 31+25.89
$\Delta = 1' 29' 00.8''$ (LT)	$\Delta = 5' 59' 05.6''$ (LT)	$\Delta = 7' 00' 00.0''$ (LT)	$\Delta = 17' 19' 30.0''$ (LT)
D = 1' 30' 00.0"	D = 3' 10' 59.2"	D = 3' 30' 00.0"	D = 8' 15' 00.0"
L = 98.90'	L = 188.02'	L = 200.00'	L = 210.00'
T = 49.45'	T = 94.10'	T = 100.12'	T = 105.81'
R = 3,819.72'	R = 1,800.00'	R = 1,637.02'	R = 694.49'
SE = SEE PLANS			

STA. 20+35.00 BEGIN TIP PROJECT B-3901

STA. 28+00.00 END TIP PROJECT B-3901

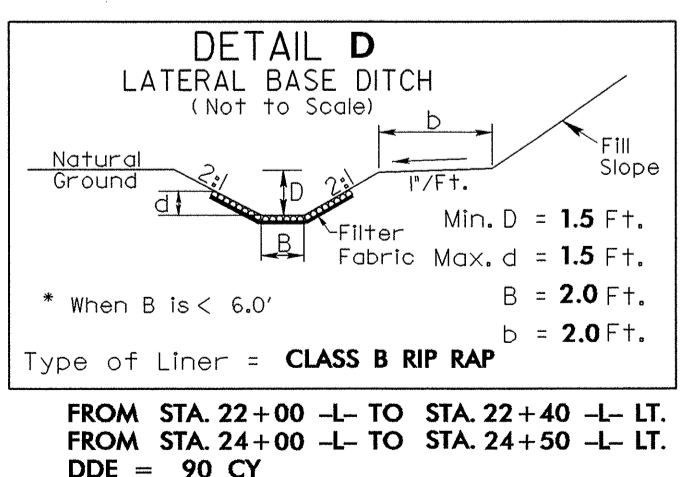
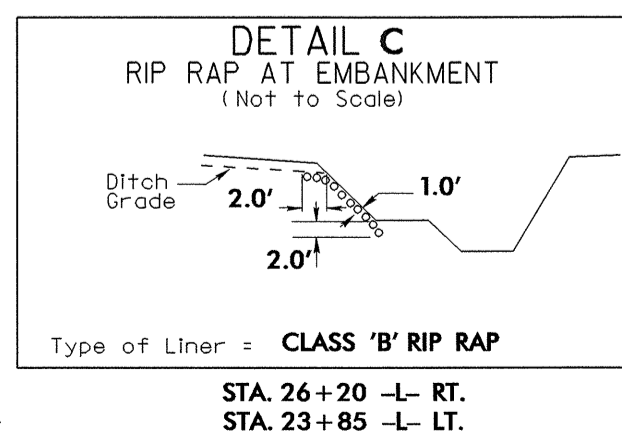
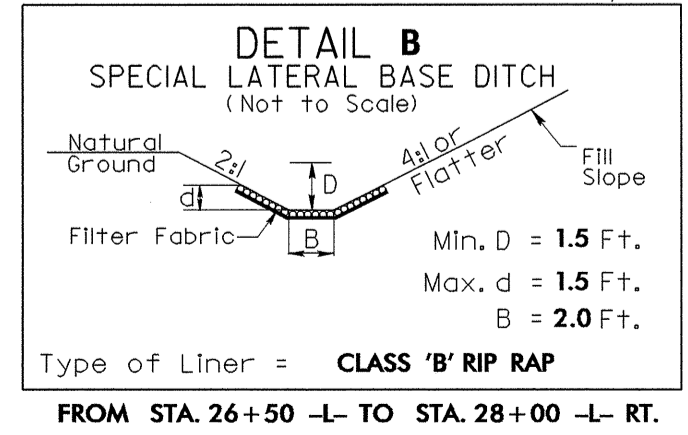
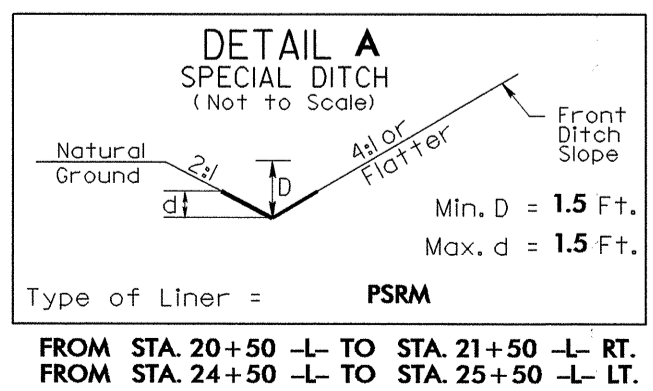
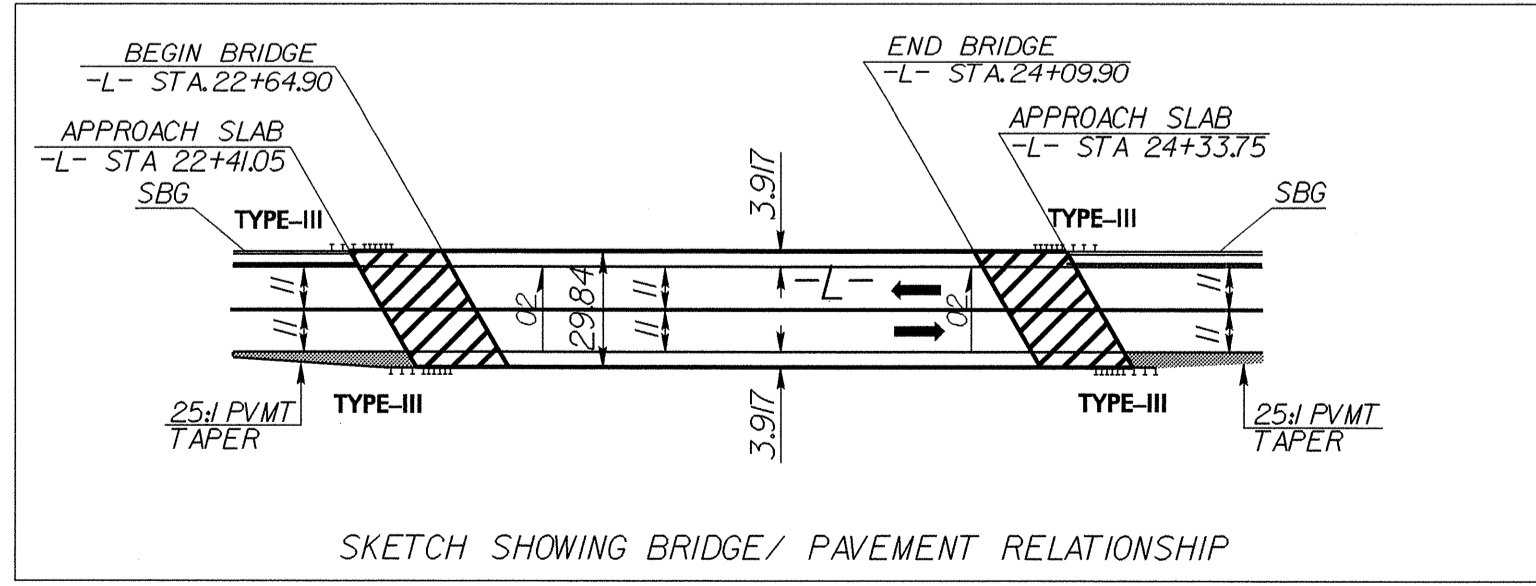
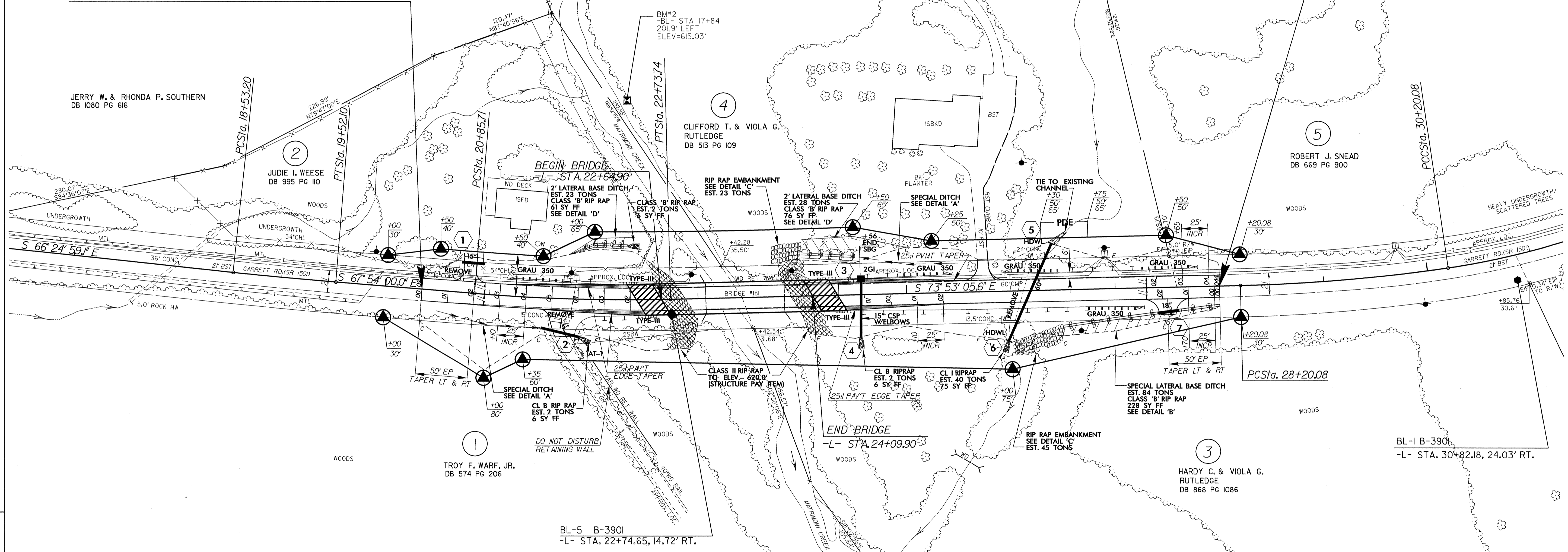

PAVED SHOULDER
 BRIDGE APPROACH SLAB

FOR -L- PROFILE SEE SHEET 5
 SEE SHEET S-1 THRU S-22
 FOR STRUCTURE PLANS

8/17/99
 REVISIONS
 15-JUL-2004 10:40
 R:\P\3901\3901_rdy_s4psh.dgn
 white rd-02oce34