

METRIC

CONST. REV. _____
R/W REV. _____

PROJECT REFERENCE NO. U-2734	SHEET NO. 8
R/W SHEET NO.	
ROADWAY DESIGN ENGINEER	HYDRAULICS ENGINEER
INCOMPLETE PLANS DO NOT USE FOR R/W ACQUISITION PRELIMINARY PLANS DO NOT USE FOR CONSTRUCTION	

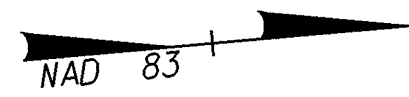

-L-
 PI Sta 20+59.186
 $\Delta = 1^{\circ}56'02.5''$ (LT)
 L = 117.974
 T = 58.992
 R = 3,495.000
 SE = NC

LEGEND

- PAVEMENT REMOVAL
- PROPOSED BIKE PATH
- PROPOSED 125mm CONCRETE MONOLITHIC ISLAND (SURFACE MOUNTED)

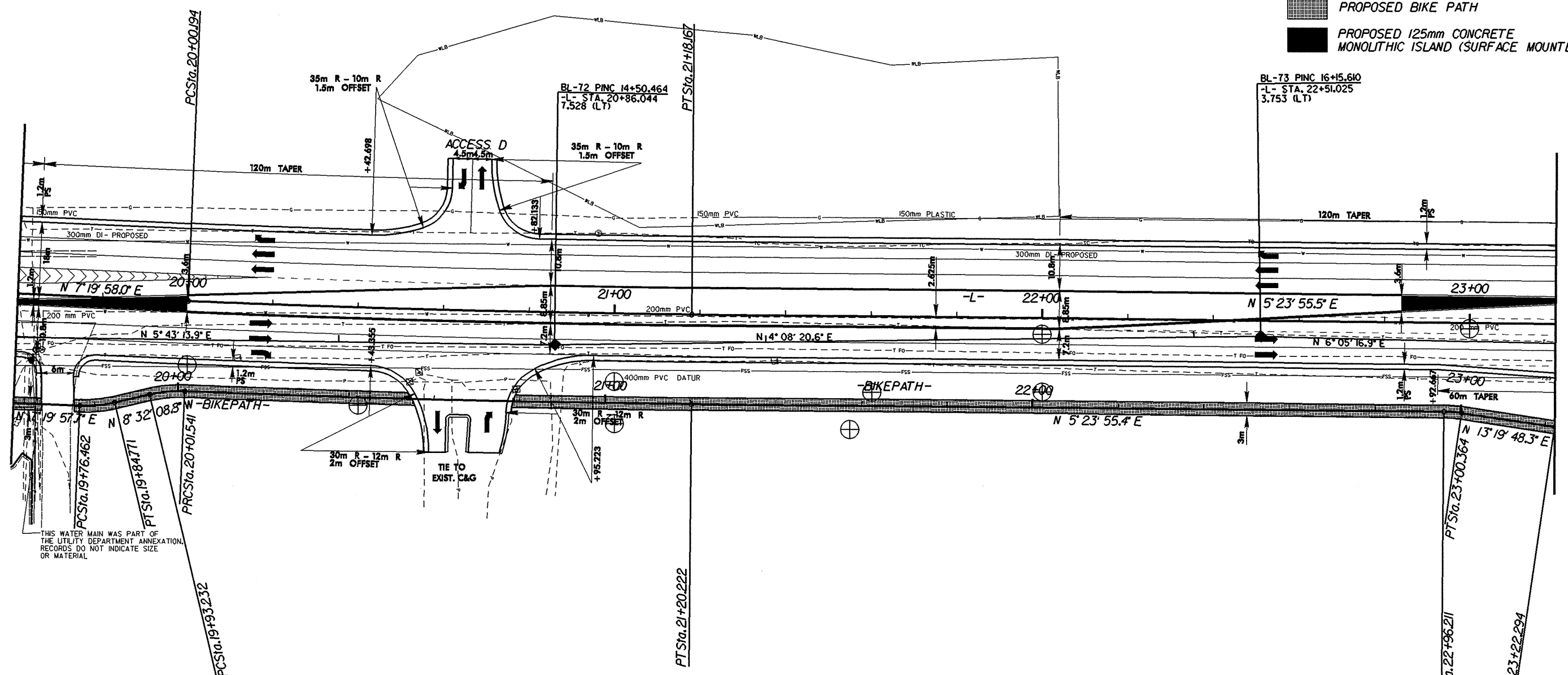

THIS WATER MAIN WAS PART OF THE UTILITY DEPARTMENT ANNEXATION. RECORDS DO NOT INDICATE SIZE OR MATERIAL

-BIKEPATH-

PI Sta 19+80.643	PI Sta 19+97.413	PI Sta 20+60.887	PI Sta 22+98.291
$\Delta = 15^{\circ}52'06.6''$ (LT)	$\Delta = 15^{\circ}52'06.6''$ (RT)	$\Delta = 1^{\circ}56'02.4''$ (LT)	$\Delta = 7^{\circ}55'52.9''$ (RT)
L = 8,309	L = 8,309	L = 118.681	L = 4,153
T = 4,181	T = 4,181	T = 59,346	T = 2,080
R = 30,000	R = 30,000	R = 3,516,000	R = 30,000

*****SYTIME*****