

NOTE:  
PLACE TEMPORARY ROCK SEDIMENT DAMS TYPE-B  
AND TEMPORARY ROCK SILT CHECKS TYPE-A AT  
DRAINAGE OUTLETS.

CLEARING AND GRUBBING  
EROSION CONTROL FOR  
CONSTRUCTION SHEET 6

 ENVIRONMENTALLY SENSITIVE AREA  
SEE PROJECT SPECIAL PROVISIONS

-2734 2-GG  
-2734 2-HH  
-2734  
-2734  
-2734  
MAYFAIRE I, LLC  
DB 3780KK PG 514

-L-  
PI Sta 20+59.186  
 $\Delta = 1^{\circ}56'02.5"$  (LT)  
L = 117.974  
T = 58.992  
R = 3,495.000  
SE = NC

NOTE:  
REMOVE EXISTING PAVEMENT UNDER  
PROPOSED GRASS ISLANDS THRU-OUT PROJECT

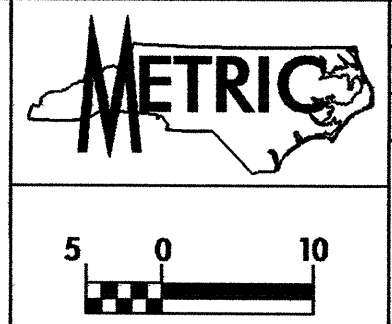

PROJECT REFERENCE NO. U-2734	SHEET NO. EC-5/CONST.6
R/W SHEET NO. 6	
ROADWAY DESIGN ENGINEER	HYDRAULICS ENGINEER
CONST. REV.	
R/W REV.	

NOTE: SEE SHEETS NO.17 & 18 FOR -L- PROFILE  
SEE SHEET NO.22 FOR -BIKE- PROFILE  
SEE SHEET NO.2-H FOR NATURAL STREAM  
DESIGN DETAILS & PROFILE  
SEE DETAIL SHEET NO.2-J FOR -BIKEPATH-  
ALIGNMENT

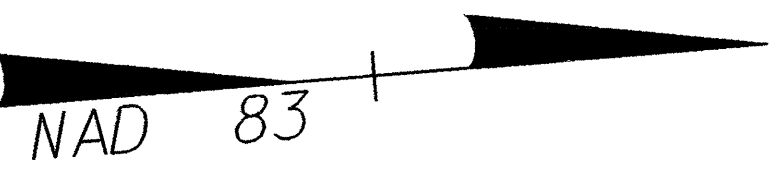

TH-

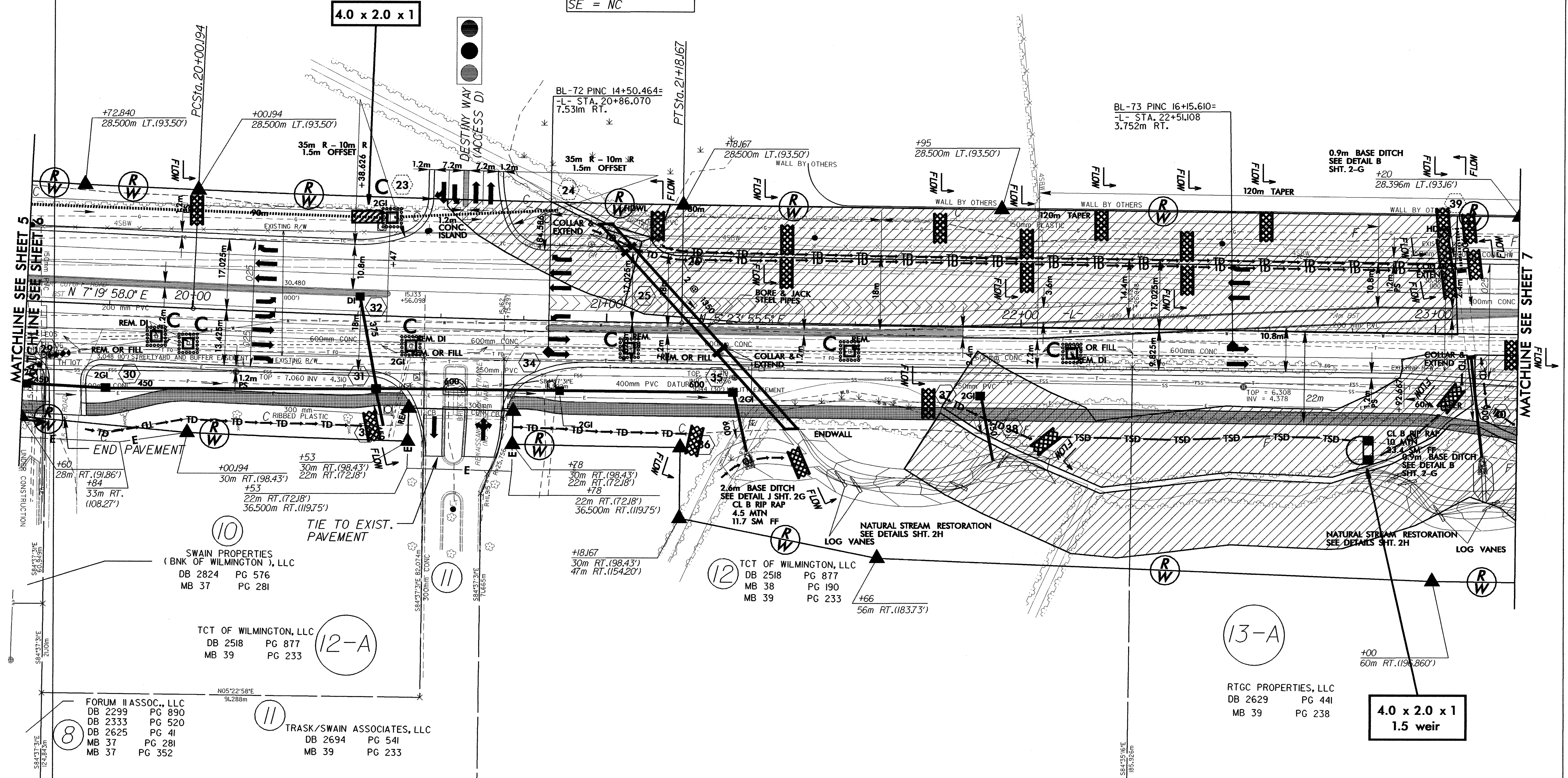

8 FORUM II ASSOC., LLC  
DB 2299 PG 890  
DB 2333 PG 520  
DB 2625 PG 41  
MB 37 PG 281  
MB 37 PG 352

11 TRASK/SWAIN ASSOCIATES, LLC  
DB 2694 PG 541  
MB 39 PG 233

10 SWAIN PROPERTIES  
(BNK OF WILMINGTON), LLC  
DB 2824 PG 576  
MB 37 PG 281

TCT OF WILMINGTON, LLC  
DB 2518 PG 877  
MB 39 PG 233

12 TCT OF WILMINGTON, LLC  
DB 2518 PG 877  
MB 38 PG 190  
MB 39 PG 233

13-A  
RTGC PROPERTIES, LLC  
DB 2629 PG 441  
MB 39 PG 238

4.0 x 2.0 x 1  
1.5 weir