

6/10/93

METRIC ENGINEER NORTH CAROLINA PROFESSIONAL SEAL 25873 GARY R. LOVERING	PROJECT REFERENCE NO. U-2734	SHEET NO. 4a
	R/W SHEET NO. 4a	
CONST. REV. R/W REV. 12/22/03	ROADWAY DESIGN ENGINEER	HYDRAULICS ENGINEER
	SEAL 20754 3-18-06 T. STEPHENS, JR.	SEAL 20754 3-18-06 T. STEPHENS, JR.
	TGS ENGINEERS 975 Walnut Street, Suite 141 Cary, NC 27511	

NOTE: SEE SHEET NO. 17 FOR -L- PROFILE

-L- STA. 13+10.00 BEGIN TIP PROJECT U-2734

1
RICHARD WETHERILL, JR. ET AL
DB 1457 PG 778
DB 1537 PG 5
DB 1637 PG 1056
MB 29 PG 104
MB 31 PG 298

2
EASTPORT HOMEOWNERS ASSOCIATION, INC.
DB 2288 PG 544
MB 32 PG 295

4A
MAYFAIRE I, LLC
DB 3968 PG 972

BL-70 PINC 9+34.894=
-L- STA. 15+70.352
11.421m RT.

MATCHLINE SEE SHEET 4 -L- STA 12 + 12.85

MATCHLINE SEE SHEET 5 -L- STA 16 + 00.00

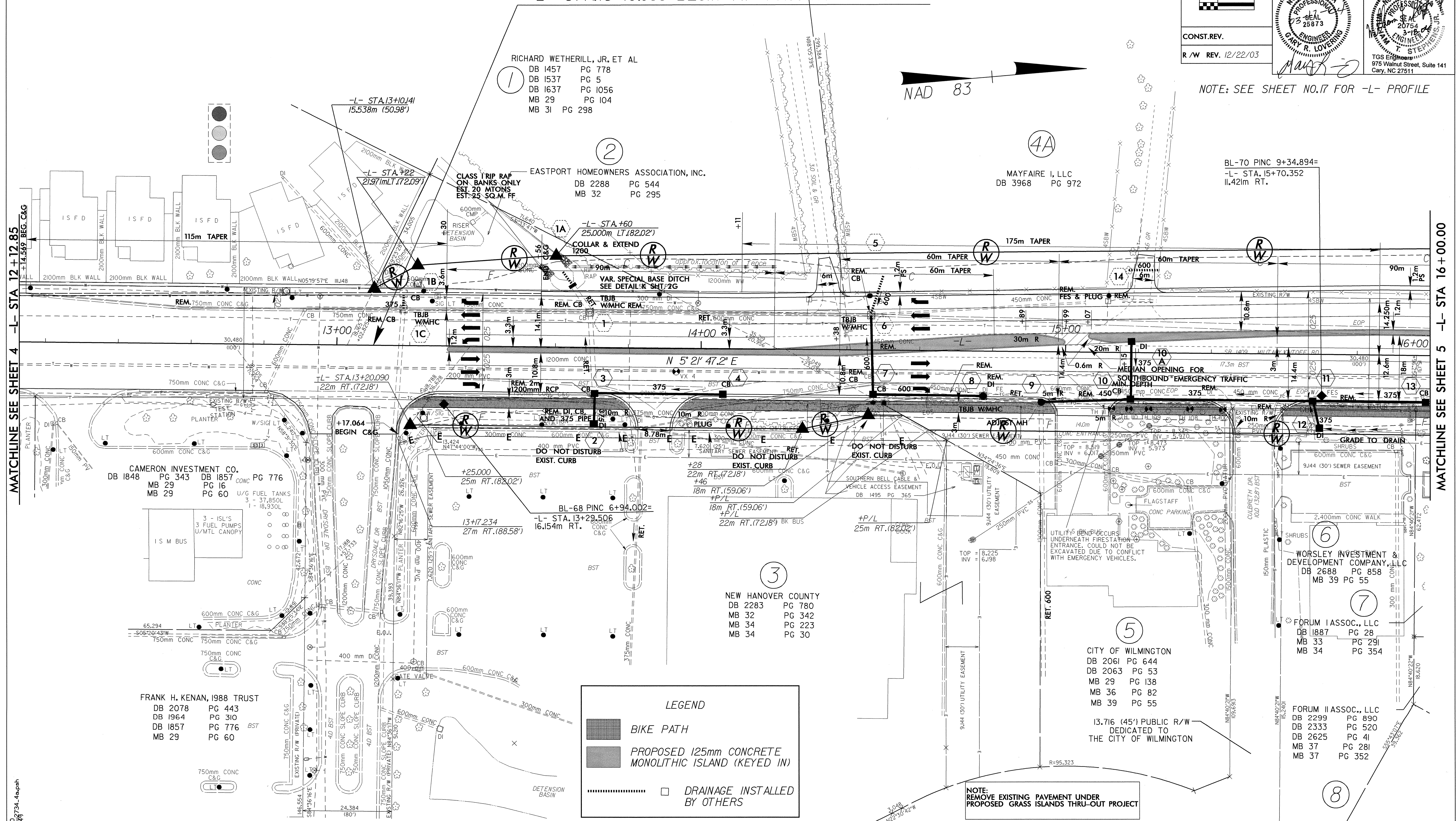

LEGEND

- BIKE PATH
- PROPOSED 125mm CONCRETE MONOLITHIC ISLAND (KEYED IN)
- DRAINAGE INSTALLED BY OTHERS

NOTE: REMOVE EXISTING PAVEMENT UNDER PROPOSED GRASS ISLANDS THRU-OUT PROJECT

17-MAR-2004 08:00
dwg AT R:\088849