

	PROJECT REFERENCE NO.	SHEET NO.
	U-2734	6
	R/W SHEET NO.	6
	ROADWAY DESIGN ENGINEER	HYDRAULICS ENGINEER
CONST. REV.		
R/W REV. 12/22/03		

TGS Engineers
975 Walnut Street, Suite 141
Cary, NC 27511

NOTE: REMOVE EXISTING PAVEMENT UNDER PROPOSED GRASS ISLANDS THRU-OUT PROJECT

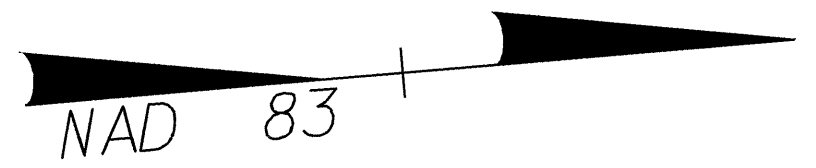

4A
MAYFAIRE I, LLC
DB 3780 PG 514

-L-
PI Sta 20+59.186
 $\Delta = 1^{\circ}56'02.5''$ (LT)
L = 117.974
T = 58.992
R = 3,495.000
SE = NC

NOTE: SEE SHEETS NO.17 & 18 FOR -L- PROFILE
SEE SHEET NO.22 FOR -BIKE- PROFILE
SEE SHEET NO.2-H FOR NATURAL STREAM DESIGN DETAILS & PROFILE
SEE DETAIL SHEET NO.2-J FOR -BIKEPATH- ALIGNMENT

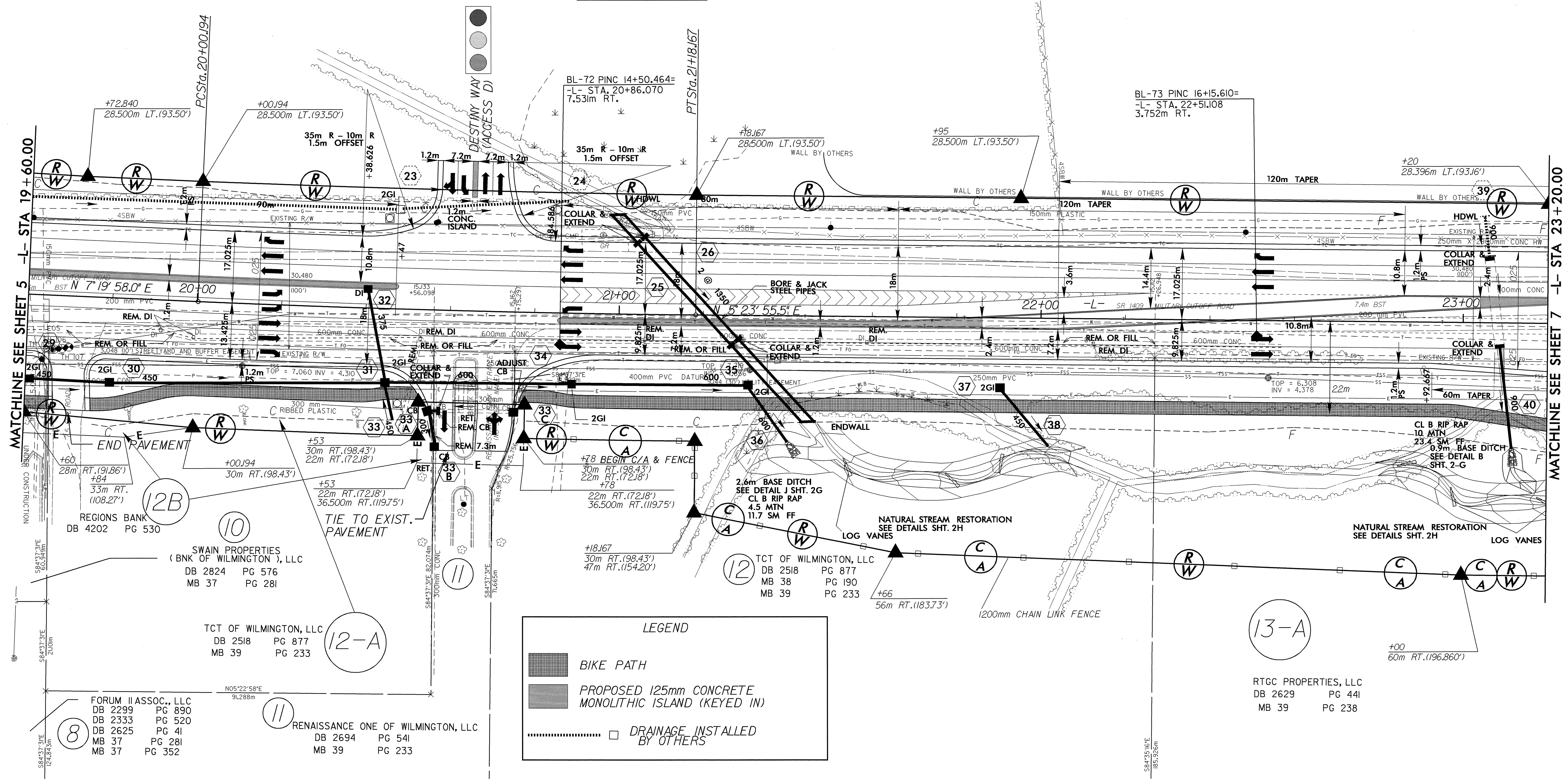

LEGEND

- BIKE PATH
- PROPOSED 125mm CONCRETE MONOLITHIC ISLAND (KEYED IN)
- DRAINAGE INSTALLED BY OTHERS

04-MAY-2004 11:31
S:\sh1\proj\12734_6.pat

13-A
RTGC PROPERTIES, LLC
DB 2629 PG 441
MB 39 PG 238

FORUM II ASSOC., LLC
DB 2299 PG 890
DB 2333 PG 520
DB 2625 PG 41
MB 37 PG 281
MB 37 PG 352

RENAISSANCE ONE OF WILMINGTON, LLC
DB 2694 PG 541
MB 39 PG 233

REGIONS BANK
DB 4202 PG 530

SWAIN PROPERTIES
(BNK OF WILMINGTON), LLC
DB 2824 PG 576
MB 37 PG 281

TCT OF WILMINGTON, LLC
DB 2518 PG 877
MB 39 PG 233

TCT OF WILMINGTON, LLC
DB 2518 PG 877
MB 38 PG 190
MB 39 PG 233

NATURAL STREAM RESTORATION
SEE DETAILS SHT. 2H

NATURAL STREAM RESTORATION
SEE DETAILS SHT. 2H

MATCHLINE SEE SHEET 5 -L- STA 19+60.00

MATCHLINE SEE SHEET 7 -L- STA 23+20.00