

6/09/08



PROJECT REFERENCE NO. U-2734 SHEET NO. 27

ROADWAY DESIGN ENGINEER

HYDRAULICS ENGINEER

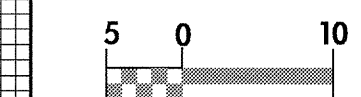

CONST. REV.

R / W REV.

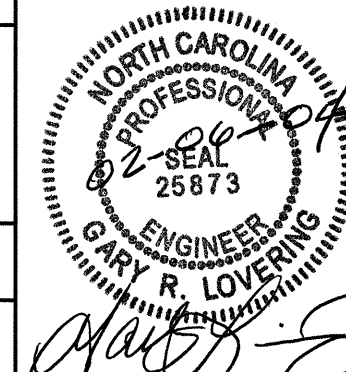

-YI-

BEGIN GRADE
-YI- STA. 10+48.000
EL = 14.544

PI = 10+52.000
EL = 14.535 m
VC = 12 m
K = 28

PI = 11+52.000
EL = 14.810 m
VC = 130 m
K = 248

PI = 12+60.000
EL = 14.540 m
VC = 80 m
K = 157

PI = 13+40.000
EL = 14.749 m
VC = 80 m
K = 157

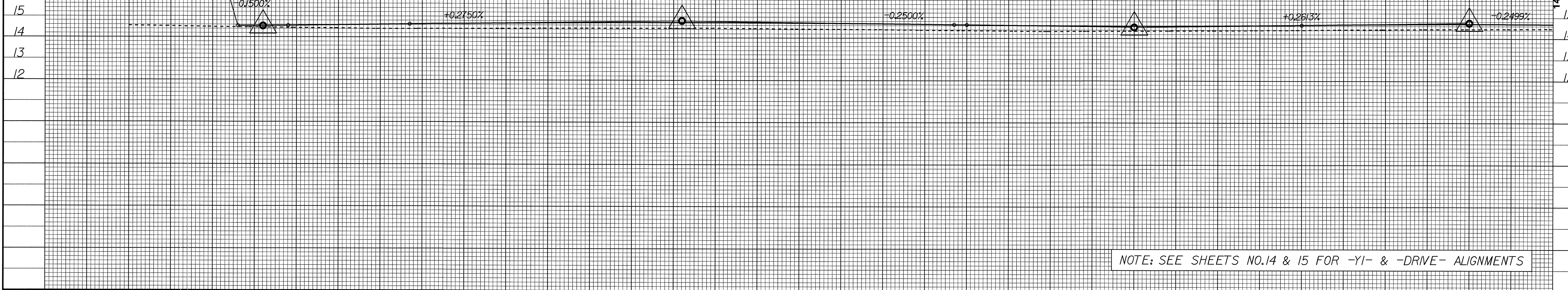

+20 +40 +60 +80 11 +20 +40 +60 +80 12 +20 +40 +60 +80 13 +20 +40 +60

-YI-

-DRIVE-

PI = 14+61.260
EL = 14.446 m
VC = 12 m
K = 30

END GRADE
-YI- STA. 14+67.260
EL = 14.455

PI = 10+30.000
EL = 14.645 m
VC = 35 m
K = 42

PI = 10+80.000
EL = 14.495 m
VC = 20 m
K = 12

PI = 11+00.000
EL = 14.088 m
VC = 20 m
K = 14

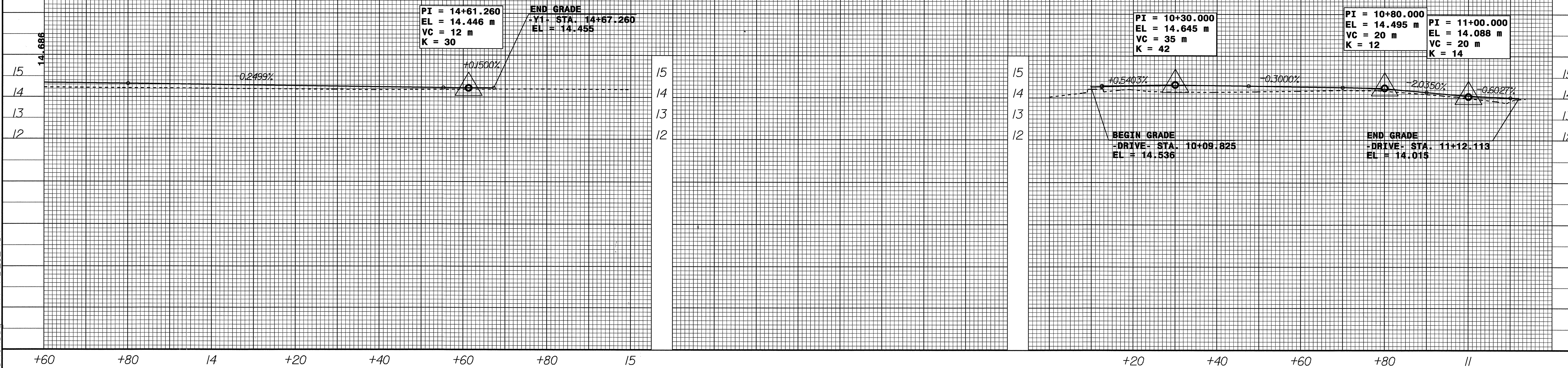

+60 +80 14 +20 +40 +60 +80 15 +20 +40 +60 +80 11

09-JAN-2004 10:11
R:\proj\02734\ref1
SAshteu AT RD212454