

TIP: R-2911A

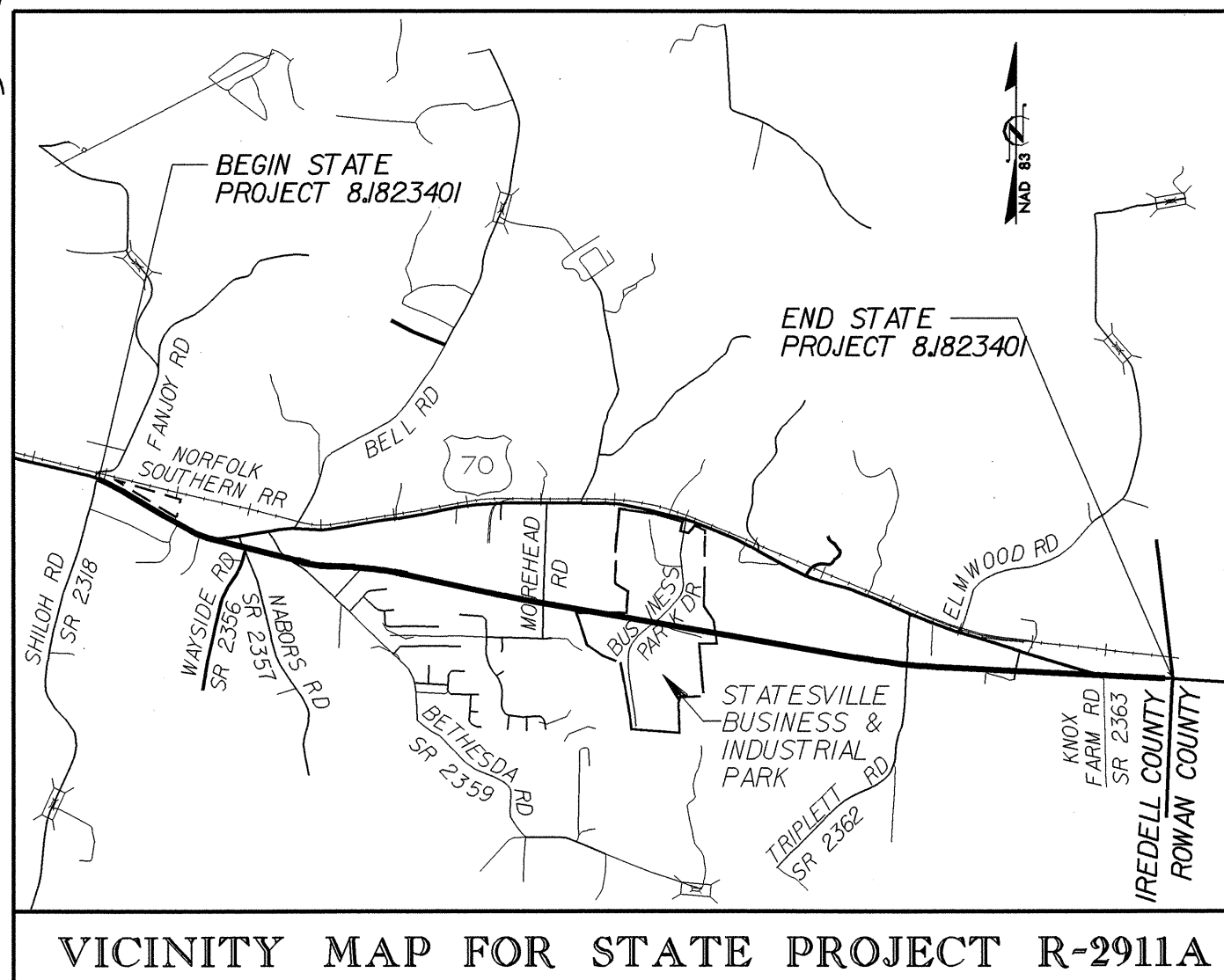

STATE OF NORTH CAROLINA
DIVISION OF HIGHWAYS

METRIC
ALL DIMENSIONS IN THESE PLANS ARE IN METERS AND/OR MILLIMETERS UNLESS OTHERWISE SHOWN

T.I.P. NO.	SHEET NO.
R-2911A	UO-1

UTILITY BY OTHERS PLANS
IREDELL COUNTY

LOCATION: U.S. 70 FROM SR 2318 NEAR STATESVILLE TO THE ROWAN COUNTY LINE

TYPE OF WORK: GRADING, DRAINAGE, PAVING, CULVERTS, STRUCTURES, SIGNING, AND SIGNALS

COORDINATE EQUALITY:
STATE PROJECT U-2421
PC STA.39+82.288 LB.=
N 224,475,2854 E 444,392,5929
STATE PROJECT R-2911A
PC STA.8+70.244 LA.
N 224,475,7874 E 444,390,5365

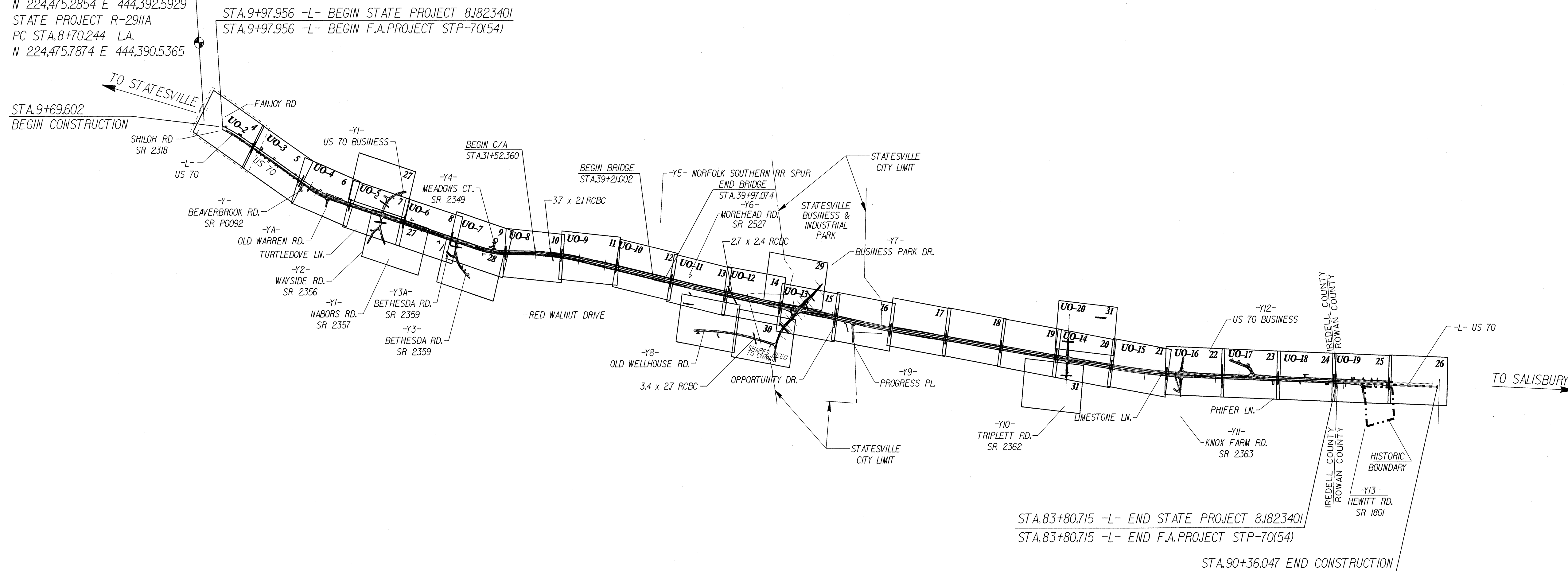

INDEX OF SHEETS

SHEET NO.	DESCRIPTION
UC-1	TITLE SHEET
UO-2 THRU UO-20	UTILITY BY OTHERS PLAN SHEETS

POWER, TELEPHONE, GAS AND TV CABLE OWNERS ON PROJECT

- (1) CITY OF STATESVILLE AND DUKE CO.(POWER LINES)
- (2) BELLSOUTH (TELEPHONE)
- (3) PUBLIC SERVICE OF N.C.(GAS LINE)
- (4) TIME WARNER CABLEVISION (TV CABLE)

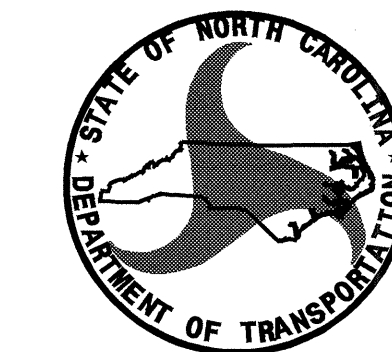

PREPARED IN THE OFFICE OF:
**DIVISION OF HIGHWAYS
DESIGN SERVICES
UTILITY SECTION**
1591 MAIL SERVICES CENTER
RALEIGH NC 27699-1591
PHONE (919) 250-4128
FAX (919) 250-4119

Roger Worthington, P.E. UTILITIES SECTION ENGINEER
Corey Bousquet, P.E. UTILITIES SQUAD LEADER PROJECT ENGINEER
Jamshid Hafshejani UTILITIES PROJECT DESIGNER