

PROJECT REFERENCE NO. R-2911A		SHEET NO. EC-18/CONST.17	
R/W SHEET NO.			
ROADWAY DESIGN ENGINEER		HYDRAULICS ENGINEER	
CONST. REV.		R/W REV.	

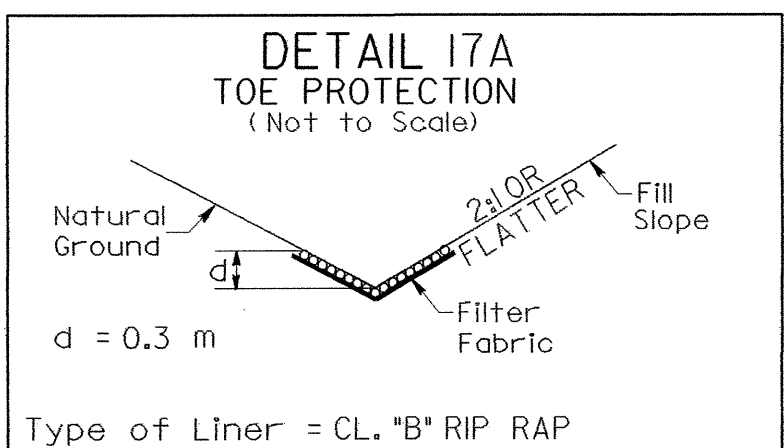

Type of Liner = CL. "B" RIP RAP  
 STA. 54+80 -L- TO STA. 56+20 -L- LT  
 STA. 54+80 -L- TO STA. 55+96 -L- RT

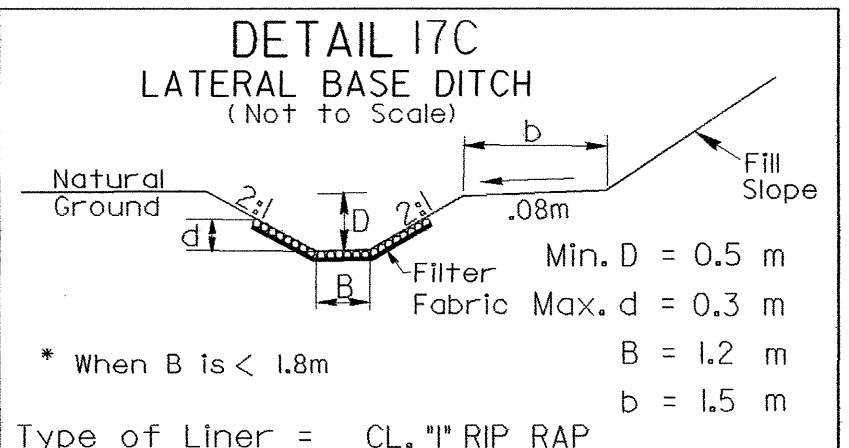

Type of Liner = CL. "I" RIP RAP  
 STA. 55+89 -L- TO STA. 57+60 -L- RT

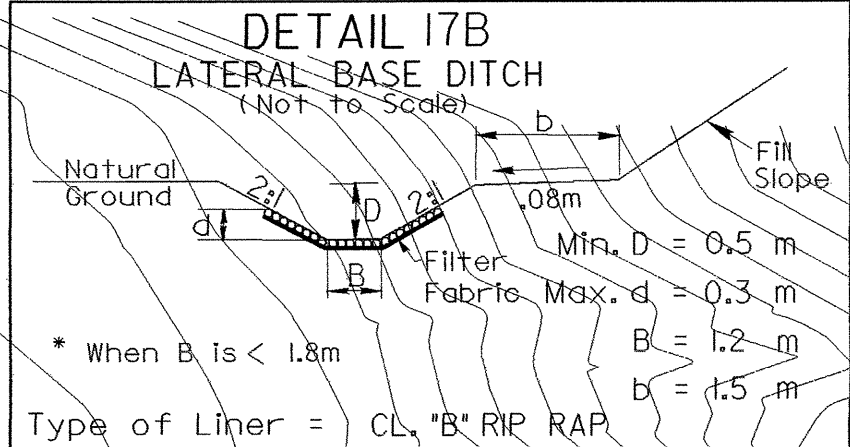

Type of Liner = CL. "B" RIP RAP  
 STA. 57+28 -L- TO STA. 58+00 -L- LT

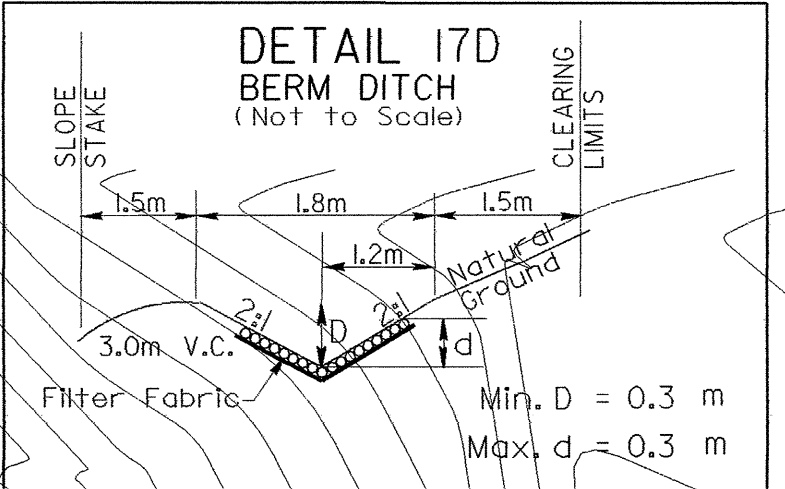

Type of Liner = CL. "B" RIP RAP  
 STA. 58+00 -L- TO STA. 58+40 -L- LT

$P.I. = 54+02.109$   
 $\Delta = 2'14''00.3'' LT$   
 $T = 97.463 M$   
 $L = 194.901 M$   
 $R = 5000.000 M$   
 $SUPER = NC$

NOTE:  
 PLACE TEMPORARY ROCK SEDIMENT DAMS TYPE-B AND TEMPORARY ROCK SILT CHECKS TYPE-A AT DRAINAGE OUTLETS.

CLEARING AND GRUBBING EROSION CONTROL FOR CONSTRUCTION SHEET 17

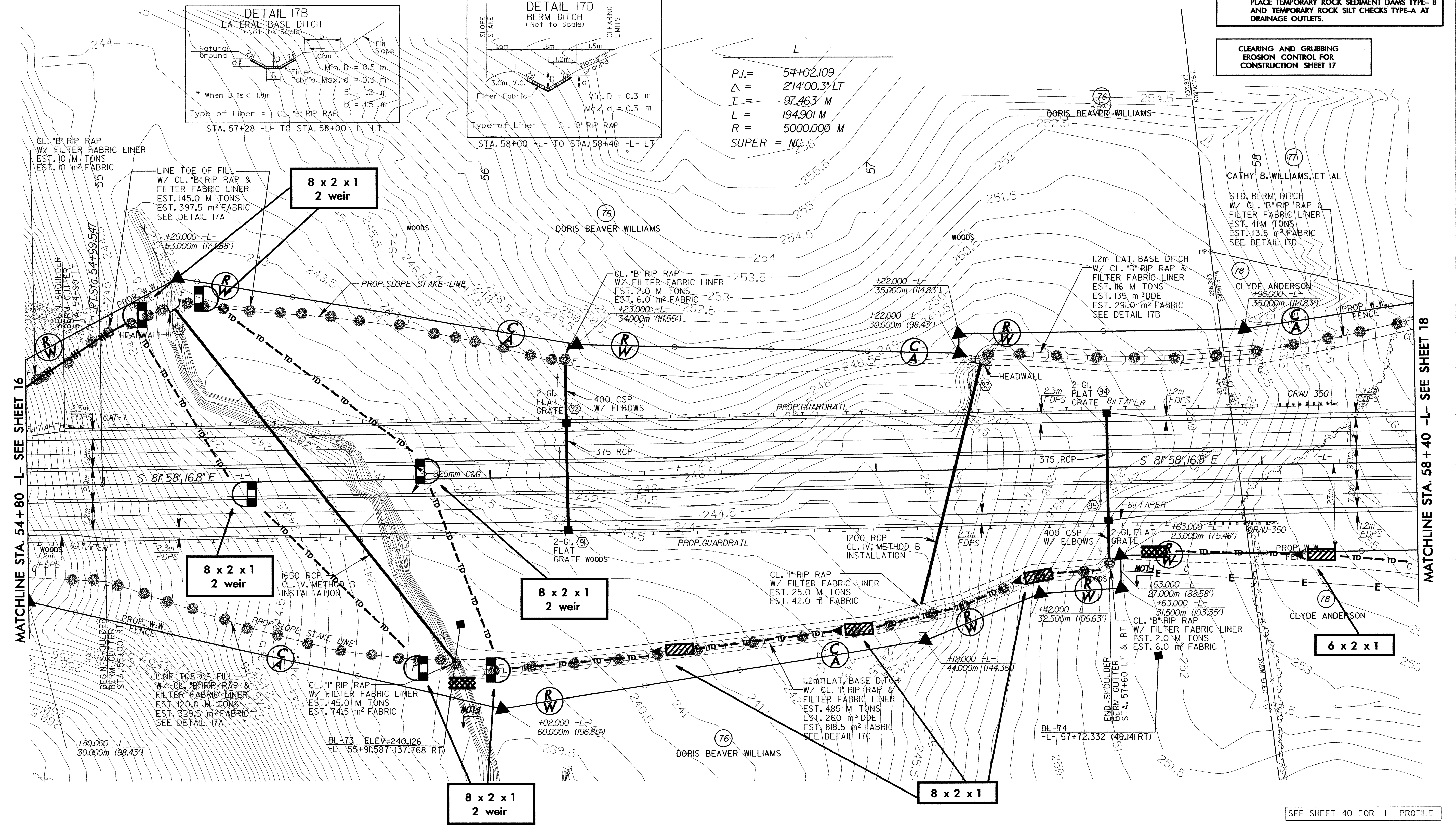

SEE SHEET 40 FOR -L- PROFILE