

PROJECT REFERENCE NO. R-2911A	SHEET NO. EC-39/CONST. II
R/W SHEET NO.	
ROADWAY DESIGN ENGINEER	HYDRAULICS ENGINEER
CONST. REV.	
R/W REV.	

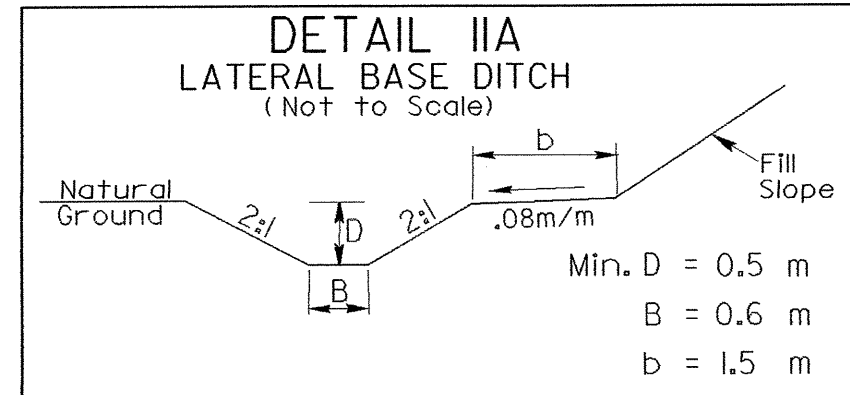

STA. 33+60 -L- TO STA. 33+99 -L- RT

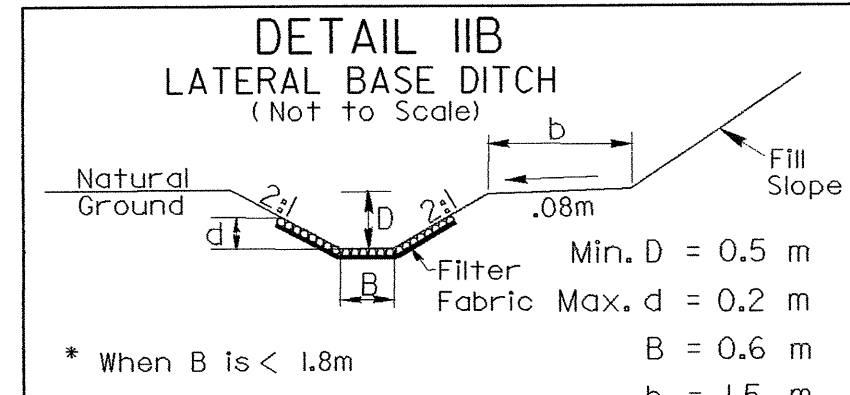

STA. 33+99 -L- TO STA. 34+34 -L- RT

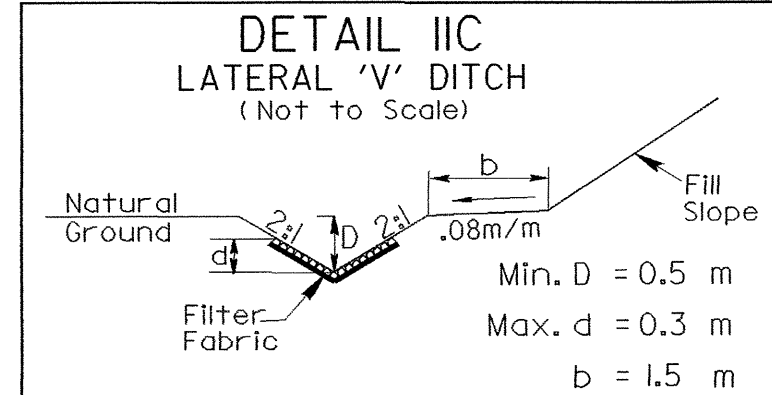

STA. 35+84 -L- TO STA. 36+33 -L- LT

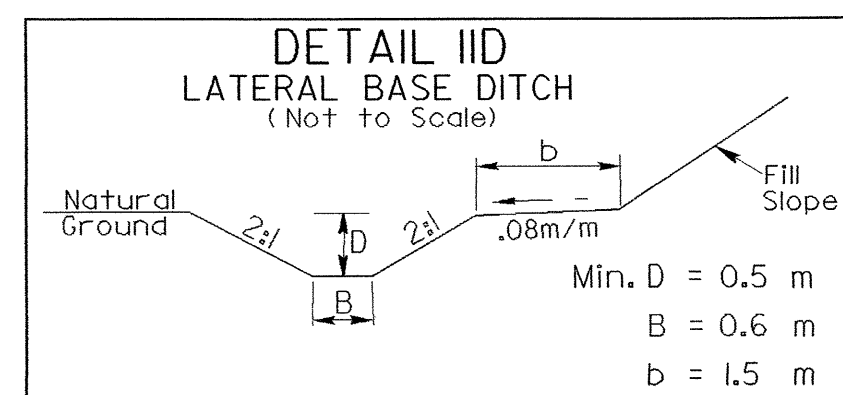

STA. 36+33 -L- TO STA. 37+32 -L- LT

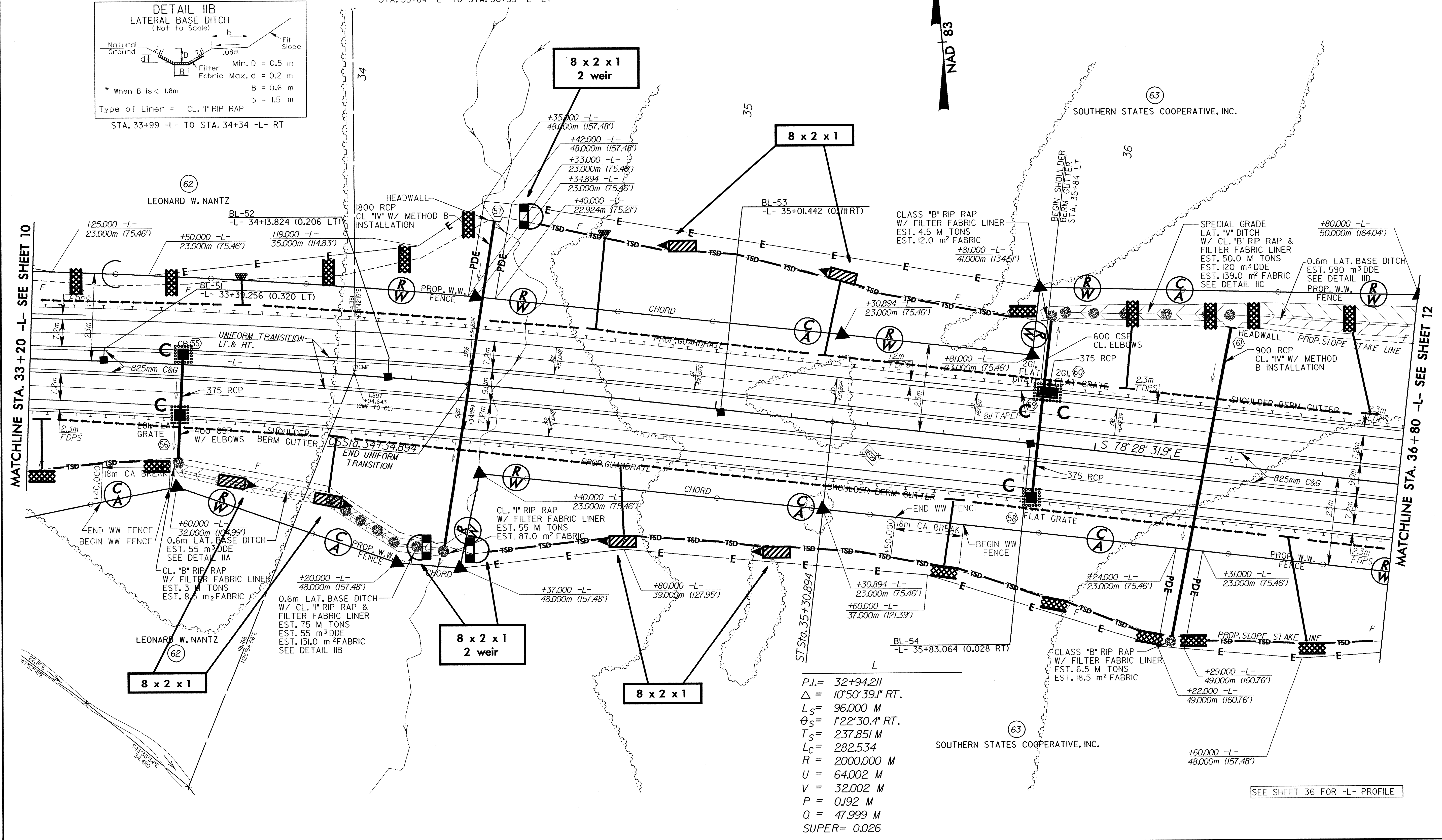

$PJ = 32+94.211$   
 $\Delta = 10^{\circ}50'39.1''$  RT.  
 $L_s = 96.000$  M  
 $\theta_s = 122^{\circ}30.4'$  RT.  
 $T_s = 237.851$  M  
 $L_c = 282.534$   
 $R = 2000.000$  M  
 $U = 64.002$  M  
 $V = 32.002$  M  
 $P = 0.192$  M  
 $Q = 47.999$  M  
 $SUPER = 0.026$

SEE SHEET 36 FOR -L- PROFILE