

TIP PROJECT: B-3616

STATE OF NORTH CAROLINA
 DIVISION OF HIGHWAYS
 PLAN FOR PROPOSED
 HIGHWAY EROSION CONTROL
BUNCOMBE COUNTY

**LOCATION: REPLACEMENT OF BRIDGE NO. 740 AND
 APPROACHES ON SR 1319 (JOHNSTON BLVD.)
 TYPE OF WORK: GRADING, PAVING, DRAINAGE, GUARDRAIL
 & CULVERT**

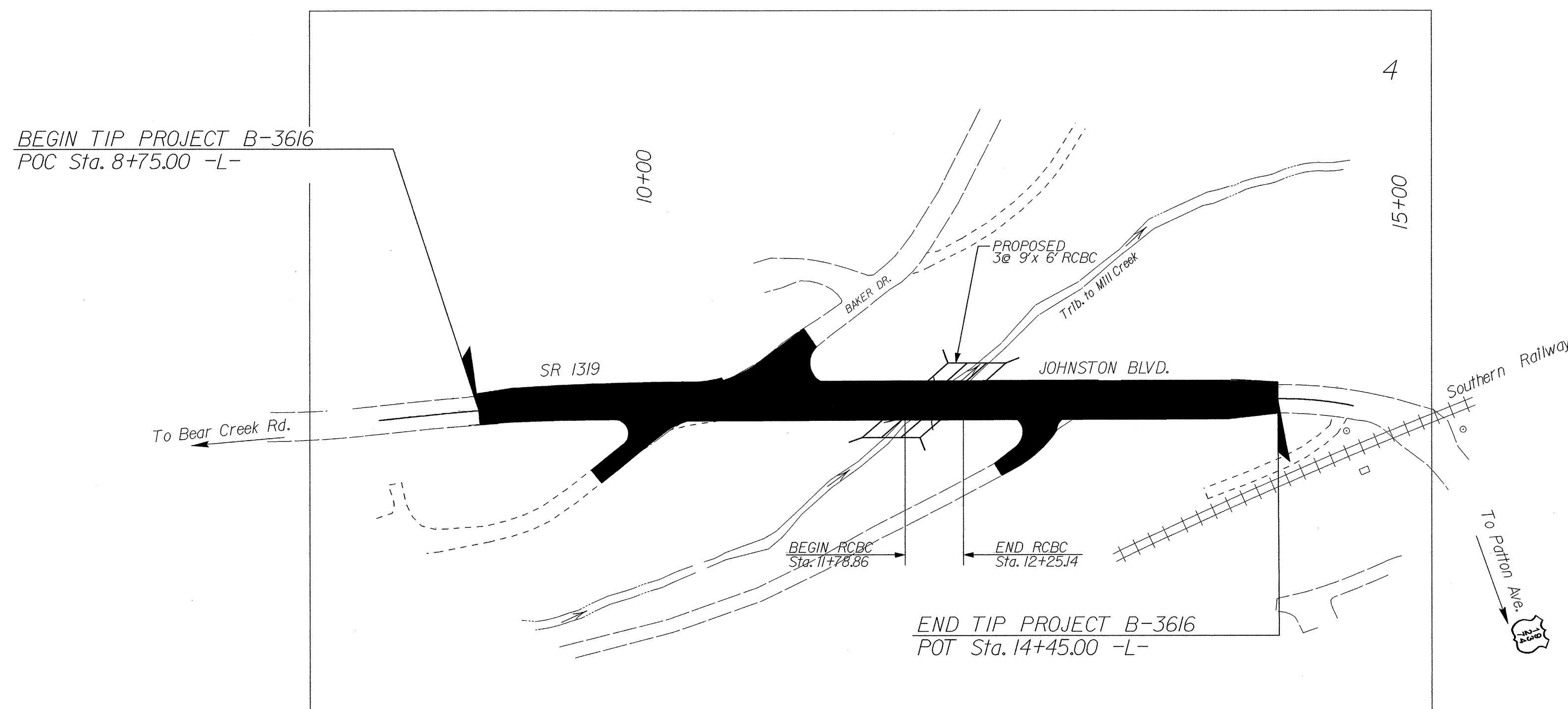
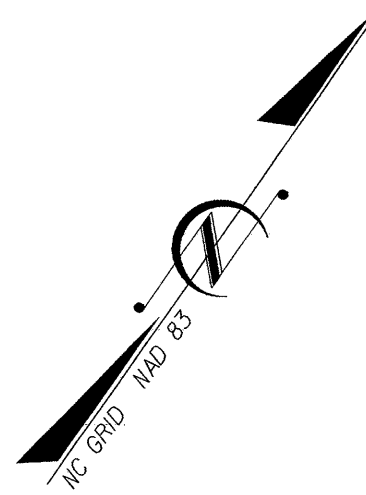

| STATE | STATE PROJECT REFERENCE NO. | SHEET NO. | TOTAL SHEETS |
|-----------------|-----------------------------|-------------|--------------|
| N.C. | B-3616 | EC-1 | |
| STATE PROJ. NO. | F.A. PROJ. NO. | DESCRIPTION | |
| | | | |
| | | | |
| | | | |
| | | | |
| | | | |
| | | | |

EROSION AND SEDIMENT CONTROL MEASURES

| Std. # | Description | Symbol |
|---------------------------|--------------------------------------|--------|
| | Reforestation | |
| 1630.03 | Temporary Silt Ditch | |
| 1630.05 | Temporary Diversion | |
| 1605.01 | Temporary Silt Fence | |
| 1606.01 | Special Sediment Control Fence | |
| 1622.01 | Temporary Berms and Slope Drains | |
| 1630.01 | Riser Basin | |
| 1630.02 | Silt Basin Type B | |
| 1633.01 | Temporary Rock Silt Check Type-A | |
| 1633.02 | Temporary Rock Silt Check Type-B | |
| 1634.01 | Temporary Rock Sediment Dam Type-A | |
| 1634.02 | Temporary Rock Sediment Dam Type-B | |
| 1635.01 | Rock Pipe Inlet Sediment Trap Type-A | |
| 1635.02 | Rock Pipe Inlet Sediment Trap Type-B | |
| 1636.01 | Rock Silt Screen | |
| 1630.04 | Stilling Basin | |
| Rock Inlet Sediment Trap: | | |
| 1632.01 | Type A | |
| 1632.02 | Type B | |
| 1632.03 | Type C | |

**THIS PROJECT CONTAINS
 EROSION CONTROL PLANS
 FOR CLEARING AND
 GRUBBING PHASE OF
 CONSTRUCTION.**

| | | | | | | | | | |
|--|--|---|---|------------------------------|---|------------------------------|--|------------------------|--|
| <p>GRAPHIC SCALE</p> <p>0 PLANS</p> <p>0 PROFILE (HORIZONTAL)</p> <p>0 PROFILE (VERTICAL)</p> | <p>ROADSIDE ENVIRONMENTAL UNIT DIVISION OF HIGHWAYS STATE OF NORTH CAROLINA</p> | <p style="text-align: center;">Prepared in the Office of: ROADSIDE ENVIRONMENTAL UNIT 1 South Wilmington St. Raleigh, NC 27611 2002 STANDARD SPECIFICATIONS</p> | <p>Roadway Standard Drawings</p> <p>The following roadway english standards as appear in "Roadway Standard Drawings"- Roadway Design Unit - N. C. Department of Transportation - Raleigh, N. C., dated January 20, 2002 and the latest revision thereto are applicable to this project and by reference hereby are considered a part of these plans.</p> <table style="width: 100%;"> <tr> <td>1605.01 Temporary Silt Fence</td> <td>1632.03 Rock Inlet Sediment Trap Type C</td> </tr> <tr> <td>1630.03 Temporary Silt Ditch</td> <td>1633.01 Temporary Rock Silt Check Type A</td> </tr> <tr> <td>1630.04 Stilling Basin</td> <td>1634.02 Temporary Rock Sediment Dam Type B</td> </tr> </table> | 1605.01 Temporary Silt Fence | 1632.03 Rock Inlet Sediment Trap Type C | 1630.03 Temporary Silt Ditch | 1633.01 Temporary Rock Silt Check Type A | 1630.04 Stilling Basin | 1634.02 Temporary Rock Sediment Dam Type B |
| 1605.01 Temporary Silt Fence | 1632.03 Rock Inlet Sediment Trap Type C | | | | | | | | |
| 1630.03 Temporary Silt Ditch | 1633.01 Temporary Rock Silt Check Type A | | | | | | | | |
| 1630.04 Stilling Basin | 1634.02 Temporary Rock Sediment Dam Type B | | | | | | | | |