

LAYOUT FOR COMPUTING AREA
OF REINFORCED CONCRETE DECK SLAB
(SQ. FT. = 5,251)

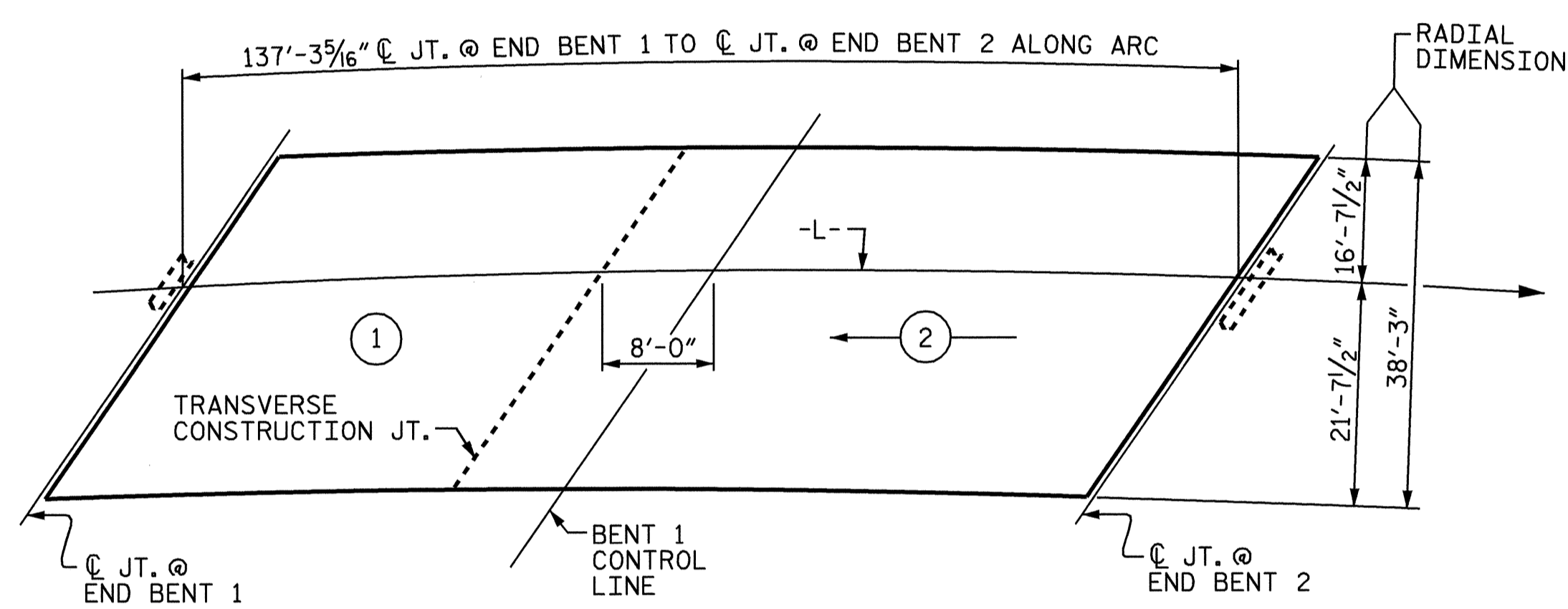

POUR SEQUENCE
← POUR DIRECTION
○ POUR NUMBER

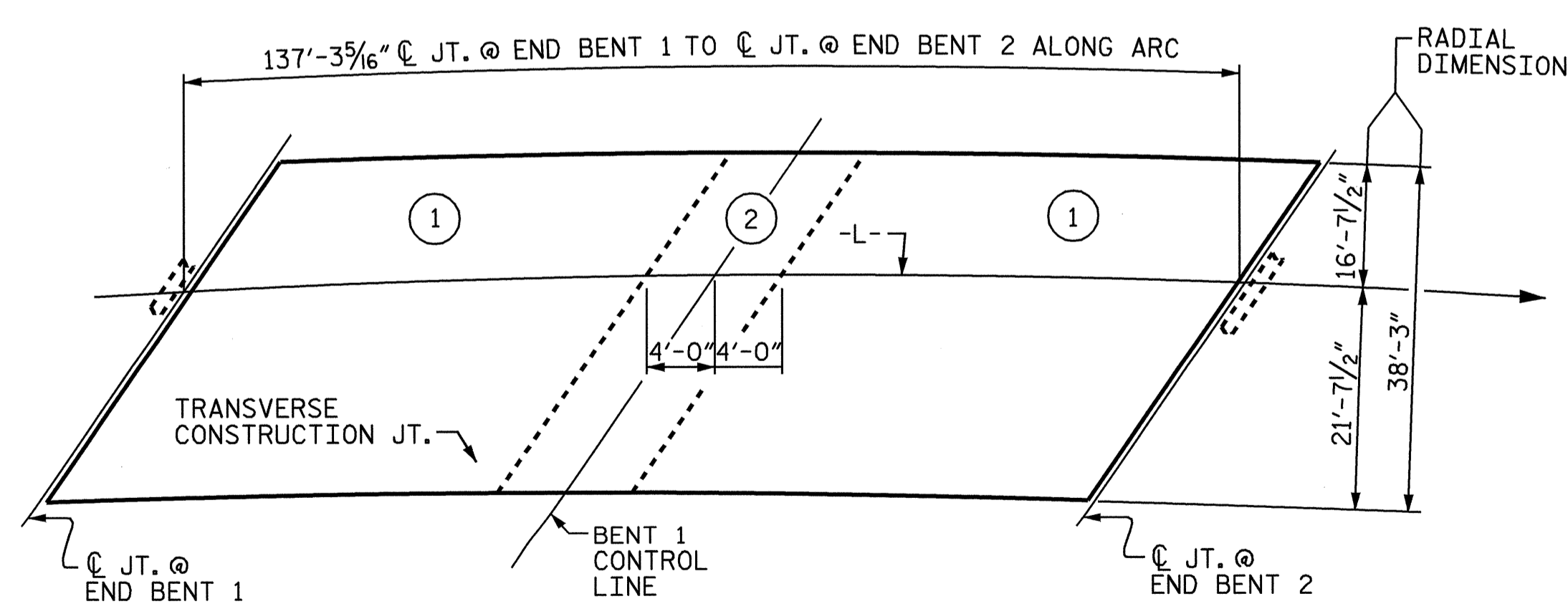

OPTIONAL POUR SEQUENCE
○ POUR NUMBER
POUR ② CAN NOT BE STARTED UNTIL BOTH ADJACENT ① POURS REACH A MINIMUM OF 3000 PSI.

BILL OF MATERIAL

SPANS A & B

BAR	NO.	SIZE	TYPE	LENGTH	WEIGHT	BAR	NO.	SIZE	TYPE	LENGTH	WEIGHT
*A1	181	#5	STR	37'-9"	7127	A214	3	#5	STR	9'-7"	30
A2	181	#5	STR	37'-9"	7127	A215	3	#5	STR	7'-7"	24
*A101	3	#5	STR	35'-9"	112	A216	3	#5	STR	5'-7"	17
*A102	3	#5	STR	33'-9"	106	A217	3	#5	STR	3'-7"	11
*A103	3	#5	STR	31'-9"	99	A218	3	#5	STR	35'-8"	112
*A104	3	#5	STR	29'-8"	93	A219	3	#5	STR	33'-6"	105
*A105	3	#5	STR	27'-8"	87	A220	3	#5	STR	31'-4"	98
*A106	3	#5	STR	25'-8"	80	A221	3	#5	STR	29'-2"	91
*A107	3	#5	STR	23'-8"	74	A222	3	#5	STR	24'-11"	78
*A108	3	#5	STR	21'-8"	68	A223	3	#5	STR	22'-9"	71
*A109	3	#5	STR	19'-8"	62	A224	3	#5	STR	20'-7"	64
*A110	3	#5	STR	17'-7"	55	A225	3	#5	STR	18'-5"	58
*A111	3	#5	STR	15'-7"	49	A226	3	#5	STR	16'-4"	51
*A112	3	#5	STR	13'-7"	43	A227	3	#5	STR	14'-2"	44
*A113	3	#5	STR	11'-7"	36	A228	3	#5	STR	12'-0"	38
*A114	3	#5	STR	9'-7"	30	A229	3	#5	STR	9'-10"	31
*A115	3	#5	STR	7'-7"	24	A230	3	#5	STR	7'-8"	24
*A116	3	#5	STR	5'-7"	17	A231	3	#5	STR	5'-6"	17
*A117	3	#5	STR	3'-7"	11	A232	3	#5	STR	3'-4"	10
*A118	3	#5	STR	35'-8"	112	A233	3	#5	STR	3'-4"	10
*A119	3	#5	STR	33'-6"	105	B1	114	#5	STR	47'-7"	5658
*A120	3	#5	STR	31'-4"	98	*B2	104	#4	STR	23'-7"	1638
*A121	3	#5	STR	29'-2"	91	*B3	26	#7	STR	52'-0"	2763
*A122	3	#5	STR	27'-1"	85	*B4	25	#7	STR	21'-0"	1073
*A123	3	#5	STR	24'-11"	78	*G1	4	#5	STR	26'-5"	110
*A124	3	#5	STR	22'-9"	71	*K1	12	#8	2	20'-7"	659
*A125	3	#5	STR	20'-7"	64	*K2	8	#8	1	14'-4"	306
*A126	3	#5	STR	18'-5"	58	*K3	24	#6	STR	8'-0"	288
*A127	3	#5	STR	16'-4"	51	K4	12	#4	10	13'-0"	104
*A128	3	#5	STR	14'-2"	44	K5	8	#4	9	7'-3"	39
*A129	3	#5	STR	12'-0"	38	K6	16	#4	STR	9'-3"	99
*A130	3	#5	STR	9'-10"	31	K7	8	#4	STR	6'-1"	33
*A131	3	#5	STR	7'-8"	24	K8	8	#4	STR	8'-3"	44
*A132	3	#5	STR	5'-6"	17	K9	16	#5	5	6'-9"	113
*A133	3	#5	STR	3'-4"	10	K10	16	#5	STR	6'-3"	104
A201	3	#5	STR	35'-9"	112						
A202	3	#5	STR	33'-9"	106						
A203	3	#5	STR	31'-9"	99	*S1	64	#4	6	4'-3"	182
A204	3	#5	STR	29'-8"	93	*S2	64	#5	3	4'-11"	328
A205	3	#5	STR	27'-8"	87	S3	48	#4	4	6'-1"	195
A206	3	#5	STR	25'-8"	80	S4	84	#4	8	2'-9"	154
A207	3	#5	STR	23'-8"	74						
A208	3	#5	STR	21'-8"	68	U1	20	#4	7	12'-8"	169
A209	3	#5	STR	19'-8"	62	U2	8	#4	7	11'-6"	61
A210	3	#5	STR	17'-7"	55						
A211	3	#5	STR	15'-7"	49						
A212	3	#5	STR	13'-7"	43						
A213	3	#5	STR	11'-7"	36						
REINFORCING STEEL = 15923 LBS											
*EPOXY COATED REINFORCING STEEL = 16497 LBS											

BAR TYPES

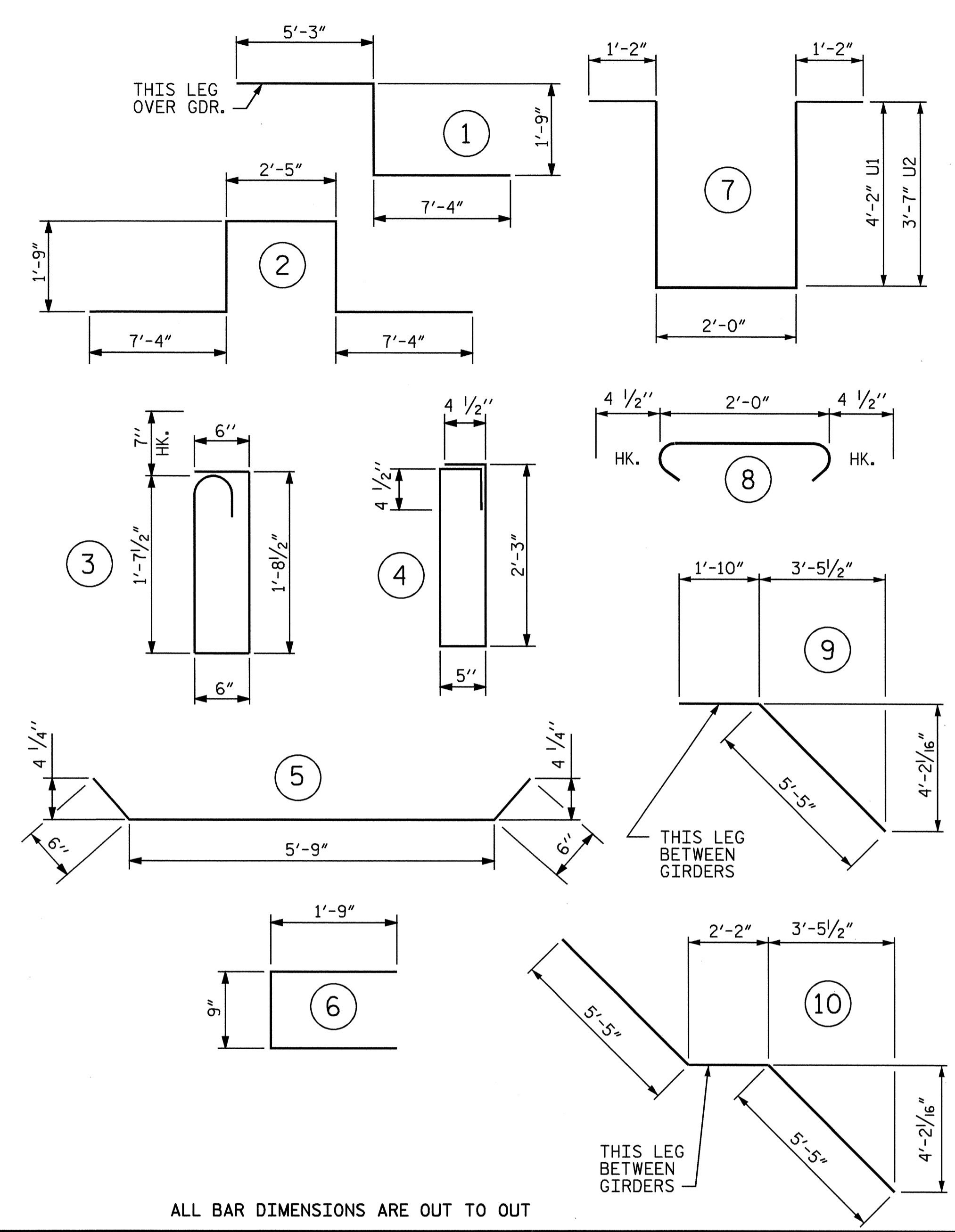

ALL BAR DIMENSIONS ARE OUT TO OUT

SUPERSTRUCTURE BILL OF MATERIAL

	CLASS AA CONCRETE (CU. YDS.)	REINFORCING STEEL (LBS.)	EPOXY COATED REINFORCING STEEL (LBS.)
SPANS A & B (POUR 1)	75.0		
SPANS A & B (POUR 2)	104.0		
SPANS A & B TOTALS **	179.0	15,923	16,497

** QUANTITIES FOR BARRIER RAIL ARE NOT INCLUDED

GROOVING BRIDGE FLOORS

BRIDGE DECK	4,396 SQ.FT.
APPROACH SLAB	1,863 SQ.FT.
TOTAL	6,259 SQ.FT.

SUPERSTRUCTURE REINFORCING STEEL LENGTHS ARE BASED ON THE FOLLOWING MINIMUM SPLICE LENGTHS

BAR SIZE	SUPERSTRUCTURE EXCEPT APPROACH SLABS, PARAPET, AND BARRIER RAIL		APPROACH SLABS		PARAPET AND BARRIER RAIL
	EPOXY COATED	UNCOATED	EPOXY COATED	UNCOATED	
#4	2'-0"	1'-9"	2'-0"	1'-9"	2'-9"
#5	2'-6"	2'-2"	2'-6"	2'-2"	3'-5"
#6	3'-0"	2'-7"	3'-10"	2'-7"	4'-4"
#7	5'-3"	3'-6"	—	—	—
#8	6'-10"	4'-7"	—	—	—

PROJECT NO. B-3310
BUNCOMBE COUNTY
STATION: 19+80.00 -L-

STATE OF NORTH CAROLINA
DEPARTMENT OF TRANSPORTATION
RALEIGH
STANDARD
SUPERSTRUCTURE
BILL OF MATERIAL

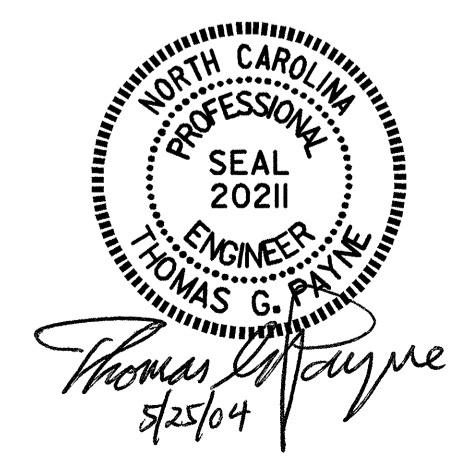

REVISIONS						SHEET NO.
NO.	BY:	DATE:	NO.	BY:	DATE:	S-15
1			3			TOTAL SHEETS 32
2			4			

ASSEMBLED BY : A.R.CHESSON DATE: 7-03
CHECKED BY : S.H.SOCKWELL DATE: 11-03
DRAWN BY : JMB 5/87 REV. 6/1/94 EEM/GRP
CHECKED BY : SJD 9/87