

\*PLACE THE RR X-ING PAVEMENT MARKING IN ACCORDANCE WITH ROADWAY STANDARD DRAWING, 1205.11, SHEET 1 OF 4, AFTER THE RAILROAD HAS PLACED THE SIGNALS AND GATES IN THEIR FINAL LOCATION.

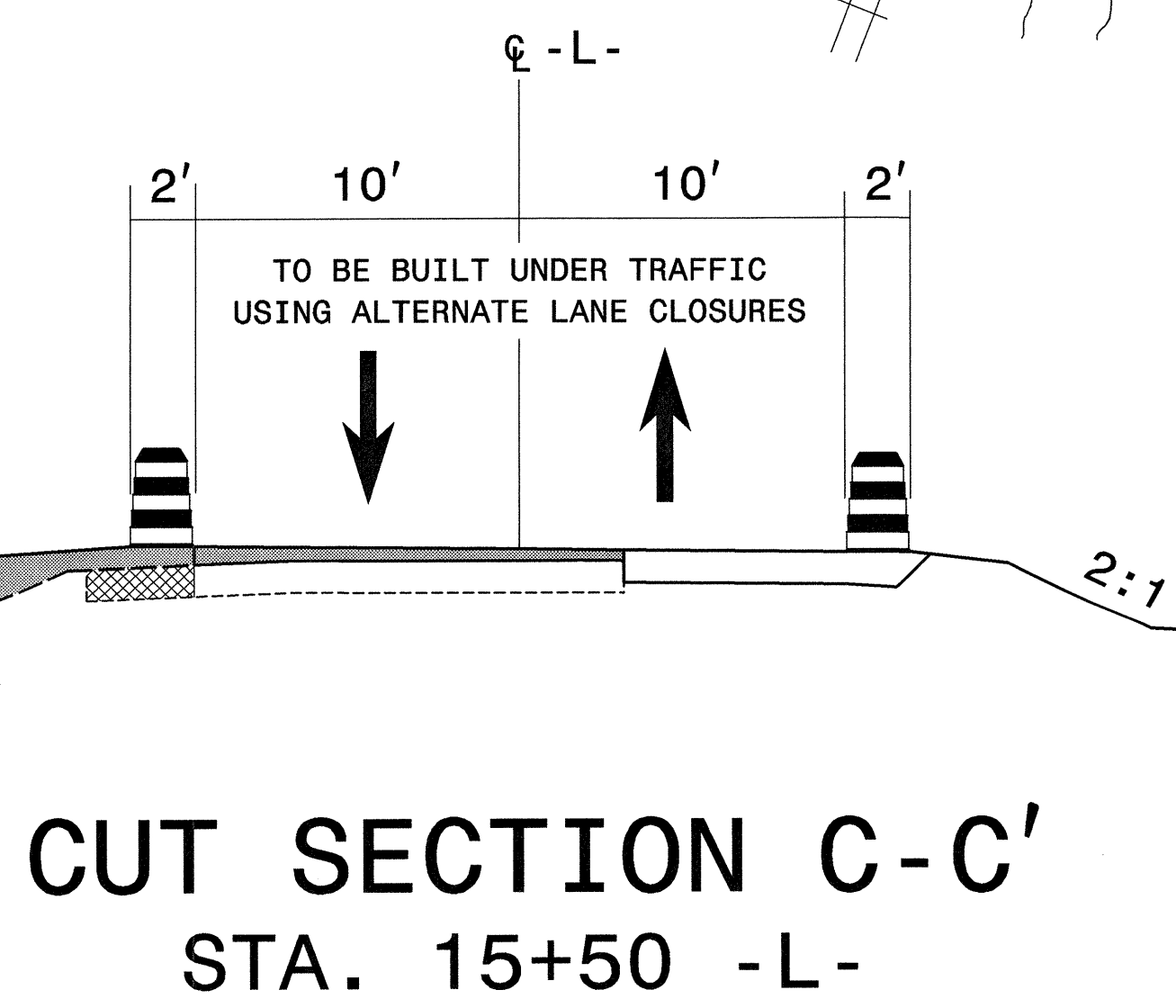

SEE SHEET TCP-1 FOR TEMPORARY PAVEMENT MARKING SCHEDULE

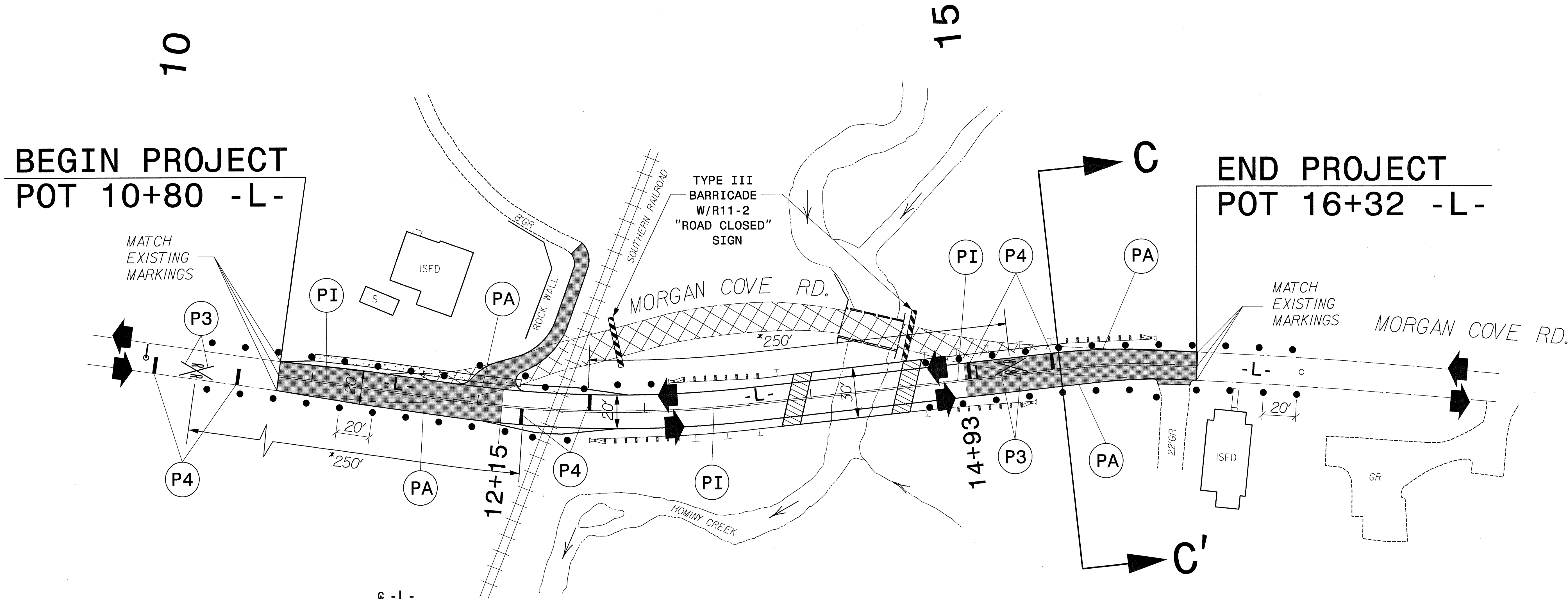
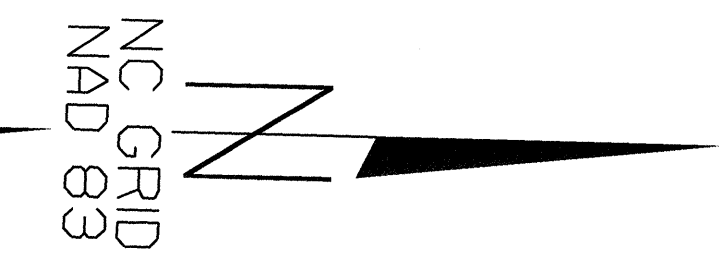

Stantec Consulting Inc.  
Suite 300, 801 Jones Franklin Road  
Raleigh NC U.S.A.  
27606  
Tel. 919.851.6866  
Fax. 919.851.7024  
www.stantec.com

APPROVED: *[Signature]* DATE: 3/11/04

SEAL

SCALE: NONE			REVISIONS	
DATE:	DEC. '03			
DWG. BY:	KJV			
DESIGN BY:	KJV			
REVIEWED BY:	KFH			
CADD FILE:				

SHEET OF

**PHASE II DETAIL**

03/10/2004 05:03:40 PM u:\Traffic Control\3614 TCP details.dgn