

9/09/99

See Sheet 1-A For Index of Sheets

STATE OF NORTH CAROLINA  
DIVISION OF HIGHWAYS

**BUNCOMBE COUNTY**

**LOCATION: REPLACEMENT OF BRIDGE NO. 300 AND APPROACHES ON SR 1141 (MORGAN COVE ROAD) OVER HOMINY CREEK**  
**TYPE OF WORK: GRADING, PAVING, DRAINAGE, GUARDRAIL AND STRUCTURE.**

STATE	STATE PROJECT REFERENCE NO.	SHEET NO.	TOTAL SHEETS
N.C.	B-3614	1	
STATE PROJ. NO.	F.A. PROJ. NO.	DESCRIPTION	
33165.1.1	BRZ-1141(9)	PE	
33165.2.1	BRZ-1141(9)	RW & UTIL.	
33165.3.2	BRZ-1141(13)	CONST.	

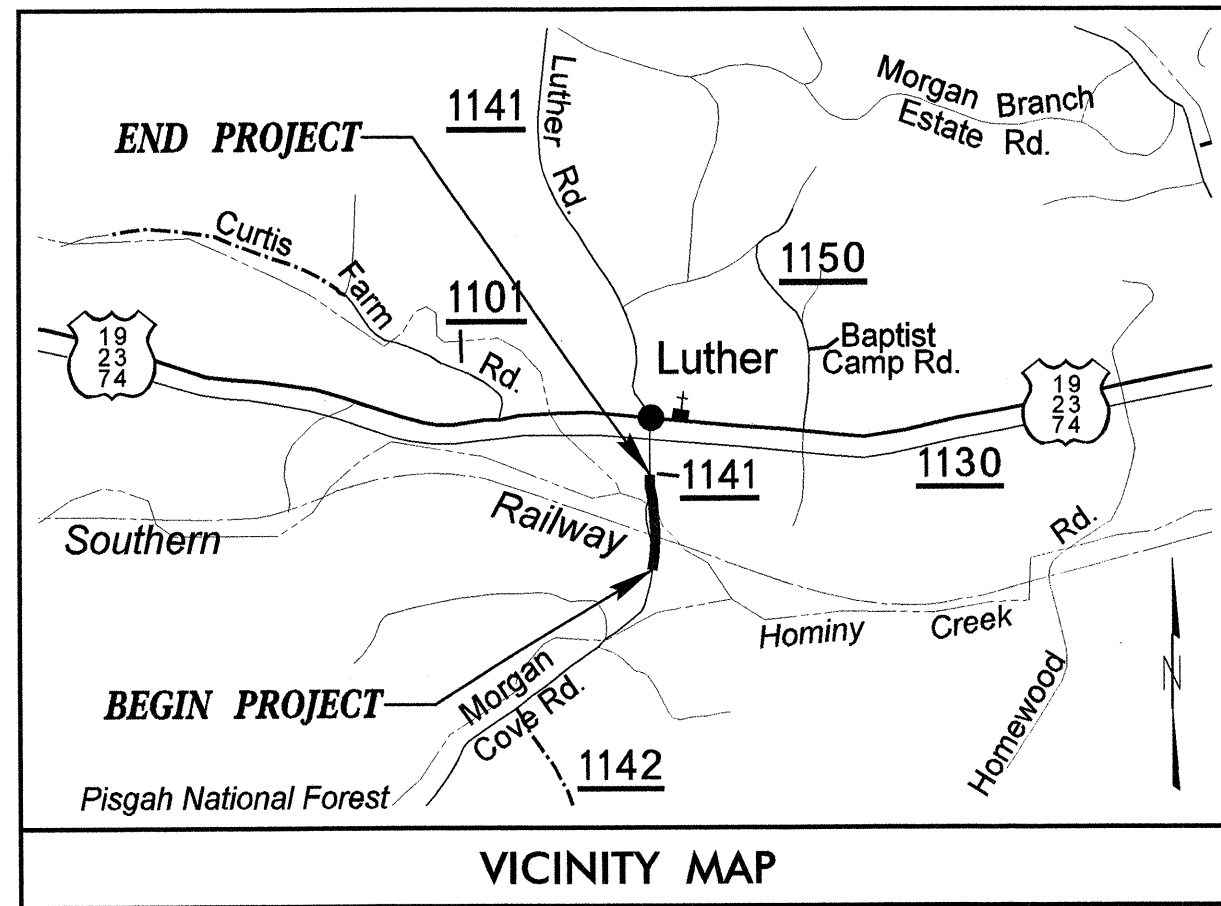

**TIP PROJECT: B-3614**

**CONTRACT: C 200844**

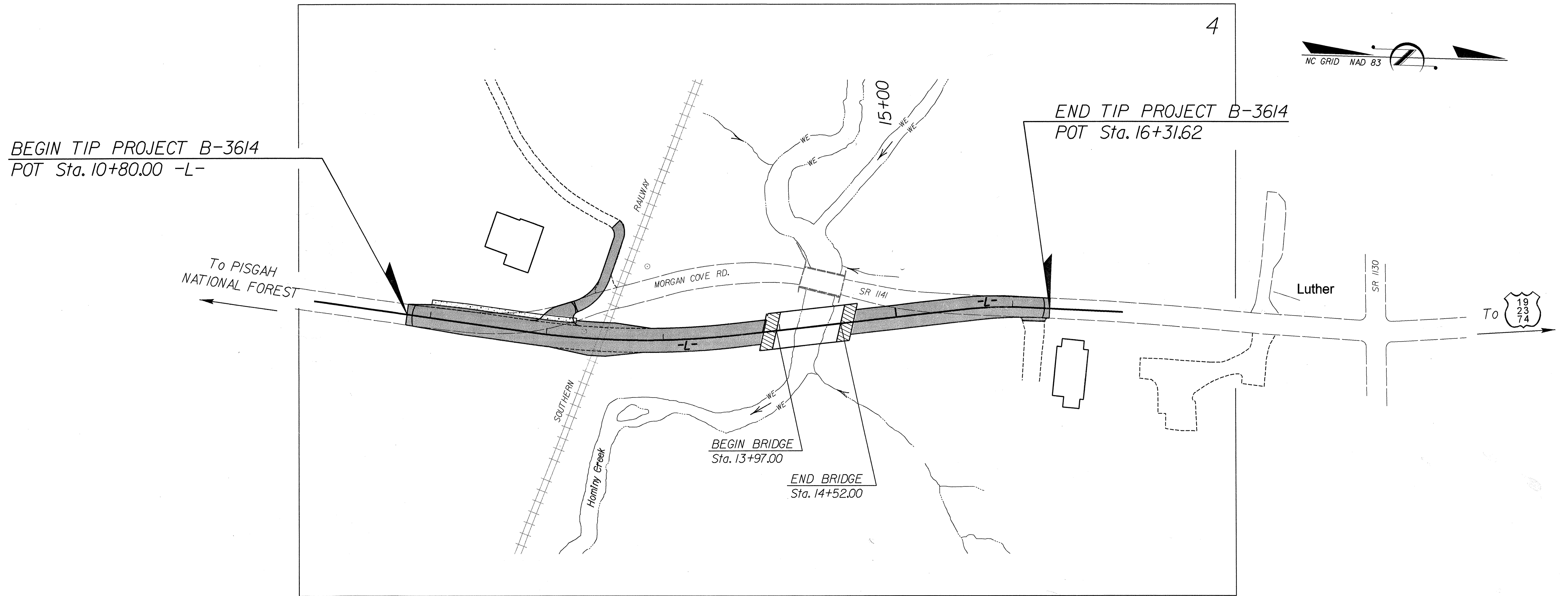

\*\* DESIGN EXCEPTION FOR DESIGN SPEED REQUIRED

<p><b>GRAPHIC SCALES</b></p> <p>50 25 0 50 100 PLANS</p> <p>50 25 0 50 100 PROFILE (HORIZONTAL)</p> <p>10 5 0 10 20 PROFILE (VERTICAL)</p>	<p><b>DESIGN DATA</b></p> <p>ADT 2003 = 575 ADT 2025 = 800</p> <p>DHV = 12 % D = 60 % T = 4 % * V = 60 MPH**</p> <p>* TTST 1 % DUAL 3 %</p>	<p><b>PROJECT LENGTH</b></p> <p>LENGTH OF ROADWAY T.I.P. PROJECT B-3614 = 0.094 MI. LENGTH OF STRUCTURE T.I.P. PROJECT B-3614 = 0.010 MI. TOTAL LENGTH OF T.I.P. PROJECT B-3614 = 0.104 MI.</p>	<p>Prepared in the Office of: Stantec Consulting Inc. Suite 300, 801 Jones Franklin Road Raleigh, NC U.S.A. 27606 Tel. 919.851.6866 Fax. 919.851.7024 www.stantec.com</p> <p><b>Stantec</b></p> <p>2002 STANDARD SPECIFICATIONS RIGHT OF WAY DATE: May 20, 2003 LETTING DATE: AUGUST 17, 2004 NCDOT CONTACT: CATHY S. HOUSER, PE PROJECT ENGINEER - DESIGN SERVICES</p> <p>KEVIN J. VAN METRE, PE PROJECT ENGINEER</p> <p>KEITH F. HUDSON PROJECT DESIGN ENGINEER</p>	<p><b>HYDRAULICS ENGINEER</b></p> <p>SEAL 20283 2-13-04 P.E.</p> <p><b>ROADWAY DESIGN</b></p> <p>SEAL 18187 2-13-04 P.E.</p>	<p><b>DIVISION OF HIGHWAYS STATE OF NORTH CAROLINA</b></p> <p><i>cut millan</i> P.E. STATE DESIGN ENGINEER</p> <p>DEPARTMENT OF TRANSPORTATION FEDERAL HIGHWAY ADMINISTRATION</p> <p>APPROVED DIVISION ADMINISTRATOR</p> <p>DATE</p>
--	---	---	---	--	--

02/13/2004 02:47:48:013 Design\B3614\_RDY.tsh.DGN