

# SURVEY CONTROL SHEET B-3614

STATE PROJECT REFERENCE NO. <b>B-3614</b>	SHEET NO. <b>1-C</b>
LOCATION AND SURVEYS	

## NOTES

I. THE CONTROL DATA FOR THIS PROJECT CAN BE FOUND ELECTRONICALLY BY SELECTING PROJECT CONTROL DATA AT:  
 HTTP://WWW.DOH.DOT.STATE.NC.US/PRECONSTRUCT/HIGHWAY/LOCATION/PROJECT/  
 FILE: B3614\_LS\_CONTROL\_030528.TXT

SITE CALIBRATION INFORMATION HAS NOT BEEN PROVIDED FOR THIS PROJECT.  
 IF FURTHER INFORMATION IS NEEDED, PLEASE CONTACT THE LOCATION AND SURVEYS UNIT.

BL POINT	DESC.	NORTH	EAST	ELEVATION	L STATION	OFFSET
1	BL-1	670020.9270	888574.5050	2183.31	10+60.69	12.45 RT
11	GPS B3614-1	670325.9790	888532.7770	2175.18	13+71.17	40.29 LT
2	BL-2	670737.7320	888540.1190	2177.88	OUTSIDE PROJECT LIMITS	

.....  
 11 ELEVATION = 2175.18  
 N 670326 E 888533  
 EL STATION 13+71.40 LEFT  
 GPS B3614-1  
 .....

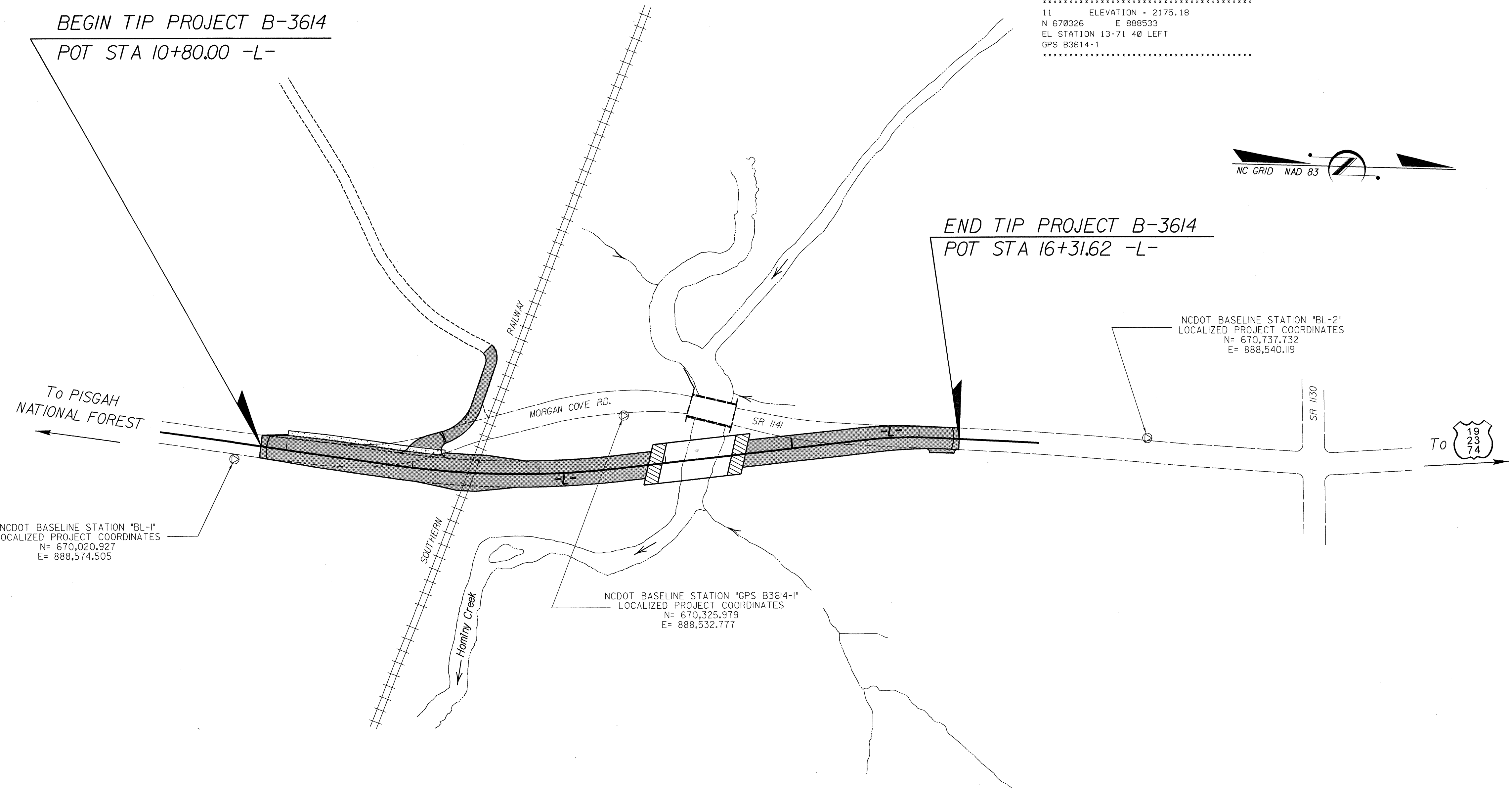

- ⊙ INDICATES GEODETIC CONTROL MONUMENTS USED OR SET FOR HORIZONTAL PROJECT CONTROL BY THE NCDOT LOCATION AND SURVEYS UNIT.
- PROJECT CONTROL ESTABLISHED USING GLOBAL POSITIONING SYSTEM.
- NETWORK ESTABLISHED FROM NGS ONLINE POSITIONING USER SERVICE (OPUS)
- SEE GPS CALIBRATION SHEET FOR HORIZONTAL AND VERTICAL COORDINATE VALUES.

NOTE: DRAWING NOT TO SCALE

**DATUM DESCRIPTION**

THE LOCALIZED COORDINATE SYSTEM DEVELOPED FOR THIS PROJECT IS BASED ON THE STATE PLANE COORDINATES ESTABLISHED BY NCDOT FOR MONUMENT "B3614" WITH NAD 83 STATE PLANE GRID COORDINATES OF NORTHING: 670325.979(E) EASTING: 888532.777(E) THE AVERAGE COMBINED GRID FACTOR USED ON THIS PROJECT (GROUND TO GRID) IS: 0.99978449 THE N.C. LAMBERT GRID BEARING AND LOCALIZED HORIZONTAL GROUND DISTANCE FROM "B3614" TO -L- STATION 10+80.00 IS S 06 19' 20.70" 286.21' ALL LINEAR DIMENSIONS ARE LOCALIZED HORIZONTAL DISTANCES VERTICAL DATUM USED IS NGVD 29