

SECTION A-A

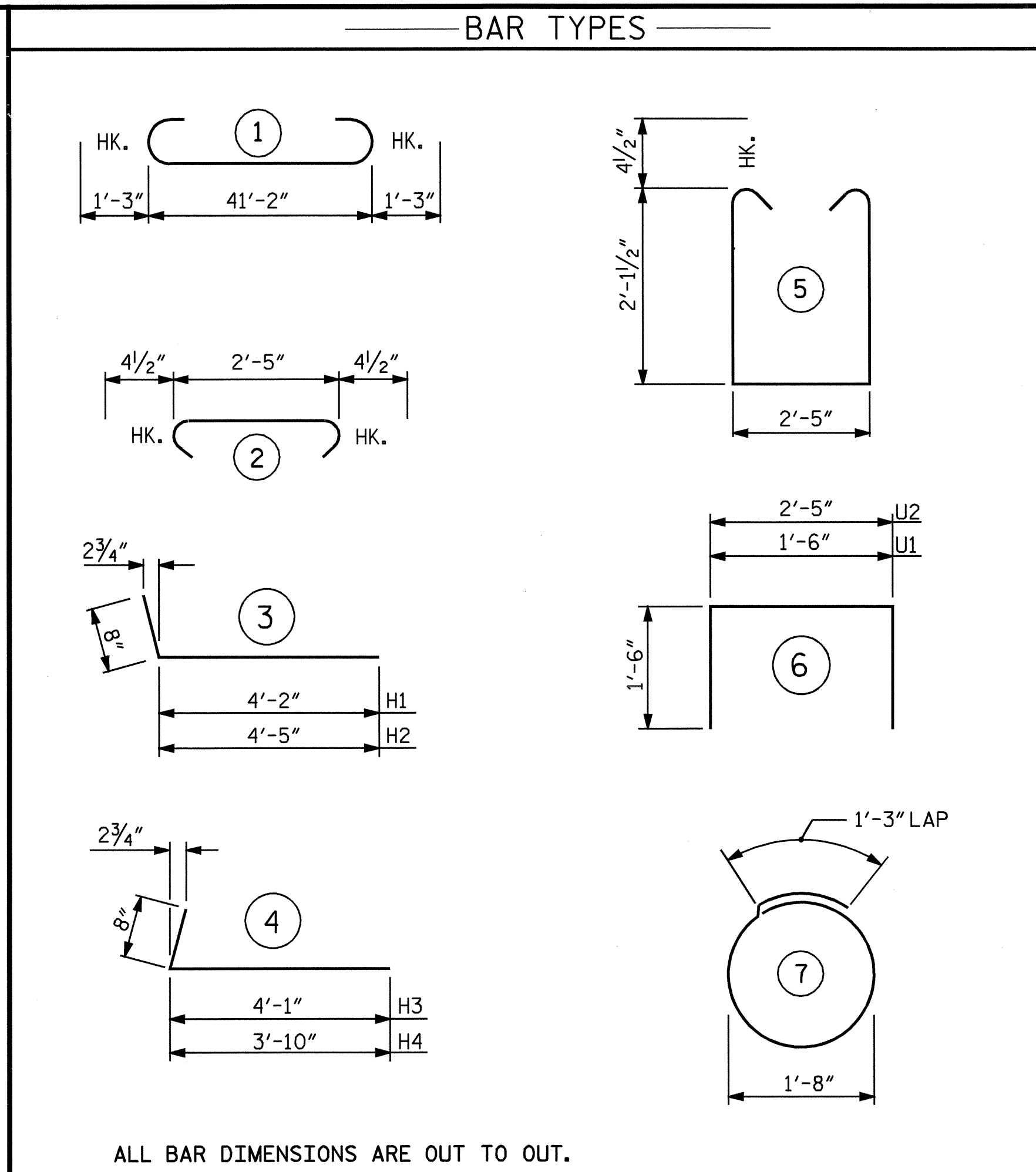

ALL BAR DIMENSIONS ARE OUT TO OUT.

| BILL OF MATERIAL | | | | | |
|------------------------------|---------------------------|------|------|---------|--------------------|
| END BENT 2 | | | | | |
| BAR | NO. | SIZE | TYPE | LENGTH | WEIGHT |
| B1 | 8 | #9 | 1 | 43'-8" | 1188 |
| B2 | 16 | #4 | STR | 21'-11" | 234 |
| B3 | 10 | #4 | STR | 2'-5" | 16 |
| B4 | 4 | #4 | STR | 26'-6" | 71 |
| | | | | | |
| D1 | 22 | #6 | STR | 1'-6" | 50 |
| | | | | | |
| H1 | 6 | #4 | 3 | 4'-10" | 19 |
| H2 | 6 | #4 | 3 | 5'-1" | 20 |
| H3 | 7 | #4 | 4 | 4'-9" | 22 |
| H4 | 7 | #4 | 4 | 4'-6" | 21 |
| | | | | | |
| K1 | 12 | #4 | STR | 2'-10" | 23 |
| | | | | | |
| S1 | 38 | #4 | 5 | 7'-5" | 188 |
| S2 | 38 | #4 | 2 | 3'-2" | 80 |
| S3 | 14 | #4 | 7 | 6'-6" | 61 |
| | | | | | |
| U1 | 4 | #4 | 6 | 4'-6" | 12 |
| U2 | 18 | #4 | 6 | 5'-5" | 65 |
| | | | | | |
| V1 | 18 | #4 | STR | 4'-4" | 52 |
| V2 | 18 | #4 | STR | 4'-11" | 59 |
| TOTAL REINFORCING STEEL LBS. | | | | | 2181 |
| CLASS A CONCRETE (CU. YDS.) | | | | | |
| POUR 1 | CAP & LOWER PART OF WINGS | | | | 12.8 |
| POUR 2 | UPPER PART OF WINGS | | | | 1.0 |
| POUR 3 | LATERAL GUIDES | | | | 0.1 |
| TOTAL (CU. YDS.) | | | | | 13.9 |
| HP 12 x 53 STEEL PILES | | | | | No. 7 LIN. FT. 175 |

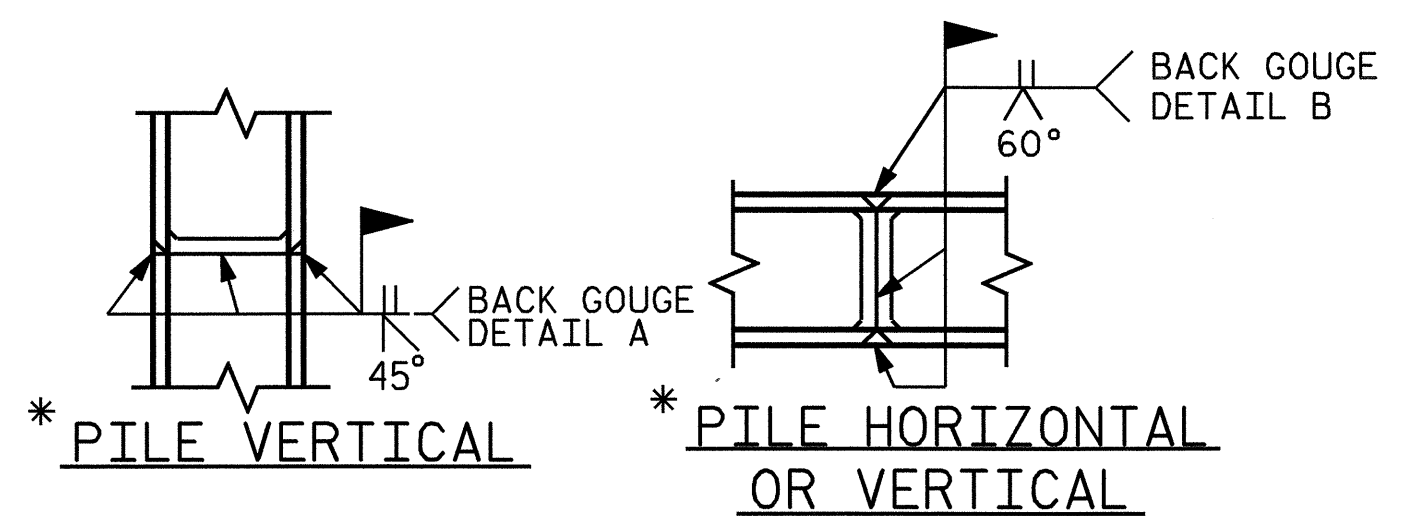

PILE SPLICING DETAILS

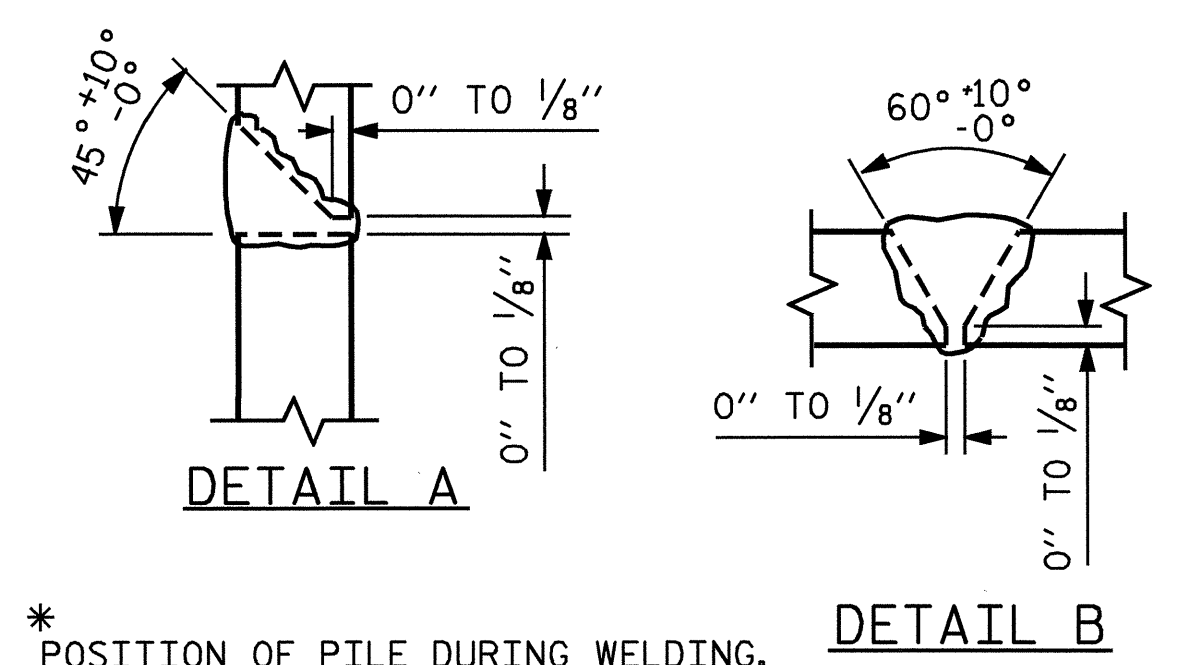

PILE SPLICING DETAILS

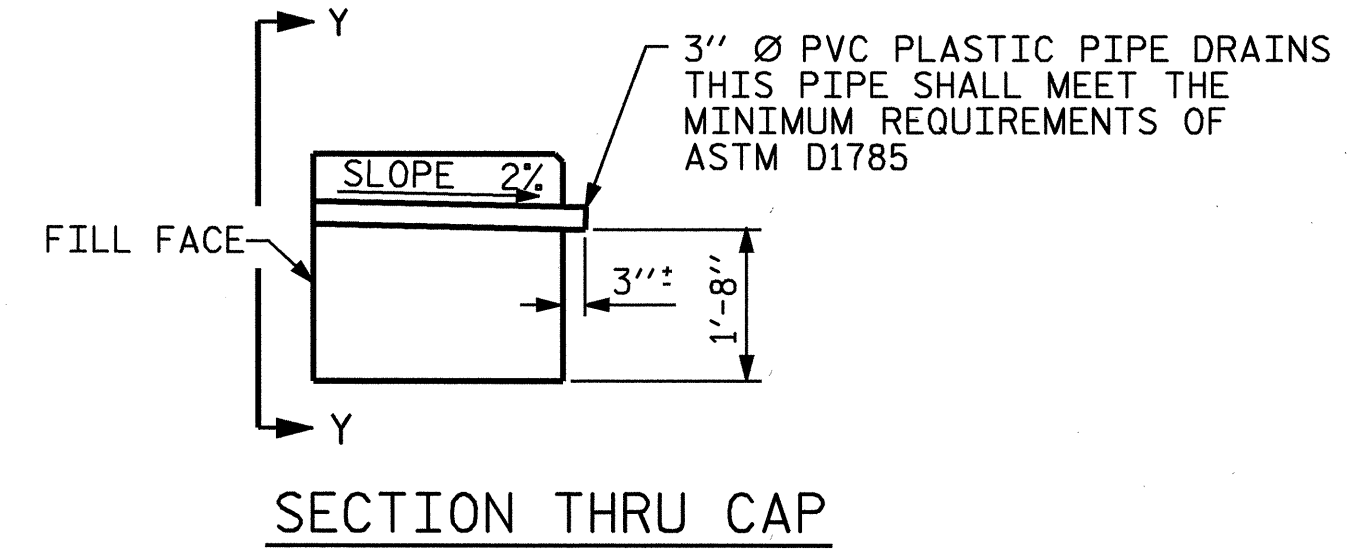

SECTION THRU CAP

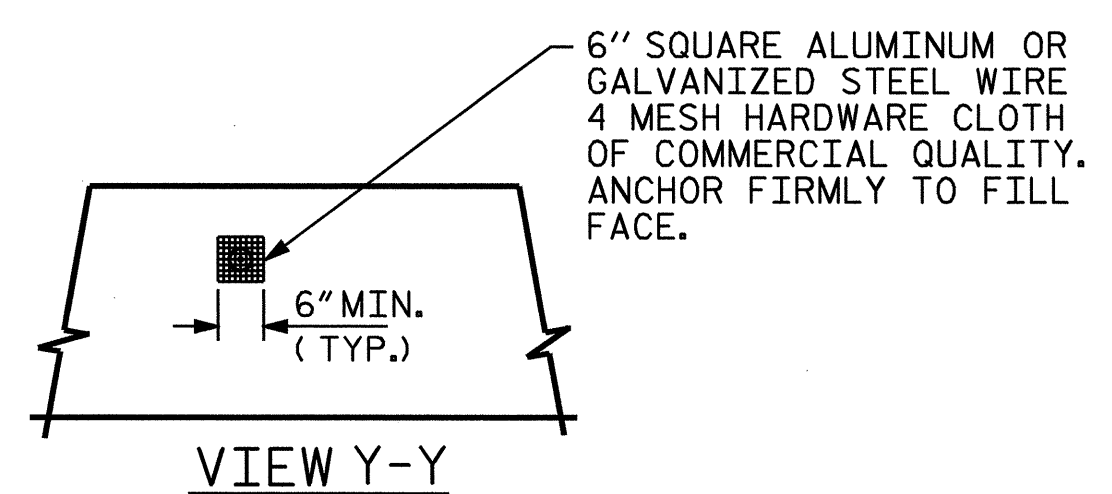

PIPE DRAIN DETAILS

NOTE: NO SEPARATE PAYMENT WILL BE MADE FOR FURNISHING AND INSTALLING THE PVC PLASTIC PIPE DRAINS, HARDWARE CLOTH AND FASTENERS. THE ENTIRE COST OF THIS WORK SHALL BE INCLUDED IN THE UNIT CONTRACT PRICE BID FOR THE SEVERAL PAY ITEMS.

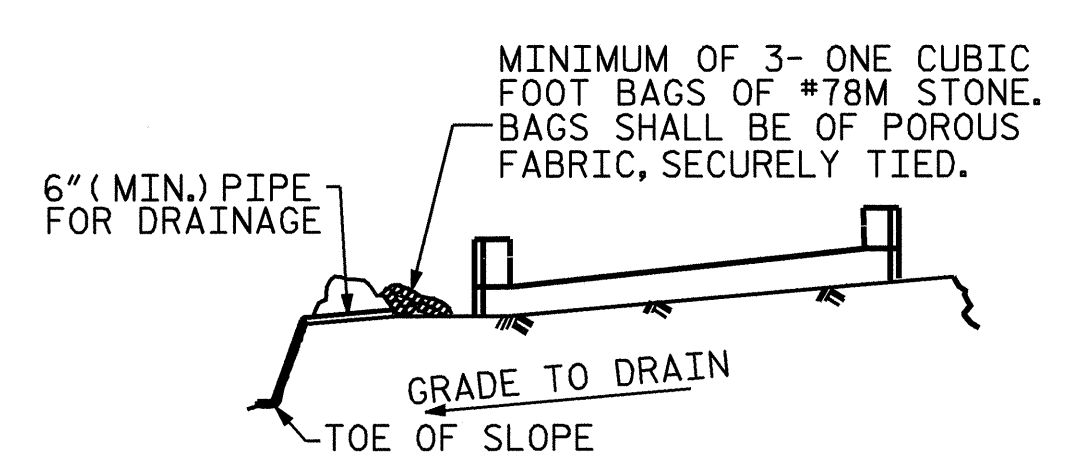

BAGGED STONE AND PIPE SHALL BE PLACED IMMEDIATELY AFTER COMPLETION OF END BENT EXCAVATION. PIPE MAY BE EITHER CONCRETE, CORRUGATED STEEL, CORRUGATED ALUMINUM ALLOY, OR CORRUGATED PLASTIC. PERFORATED PIPE WILL NOT BE ALLOWED. BAGGED STONE SHALL REMAIN IN PLACE UNTIL THE ENGINEER DIRECTS THAT IT BE REMOVED. THE CONTRACTOR SHALL REMOVE AND DISPOSE OF SILT ACCUMULATIONS AT BAGGED STONE WHEN SO DIRECTED BY THE ENGINEER. BAGS SHALL BE REMOVED AND REPLACED WHENEVER THE ENGINEER DETERMINES THAT THEY HAVE DETERIORATED AND LOST THEIR EFFECTIVENESS. NO SEPARATE PAYMENT WILL BE MADE FOR THIS WORK AND THE ENTIRE COST OF THIS WORK SHALL BE INCLUDED IN THE UNIT CONTRACT PRICE BID FOR THE SEVERAL PAY ITEMS.

TEMPORARY DRAINAGE AT END BENT



PROJECT NO. B-3614
BUNCOMBE COUNTY
 STATION: 14+24.50 -L-

SHEET 3 OF 3

| STATE OF NORTH CAROLINA DEPARTMENT OF TRANSPORTATION RALEIGH | | | | | |
|--|-----|-------|-----|-----|-----------|
| SUBSTRUCTURE END BENT 2 | | | | | |
| REVISIONS | | | | | SHEET NO. |
| NO. | BY: | DATE: | NO. | BY: | DATE: |
| 1 | | | 3 | | |
| 2 | | | 4 | | |
| TOTAL SHEETS | | | | | 17 |

DRAWN BY: A. K. PATEL DATE: 7/15/03
 CHECKED BY: T. A. HARRIS DATE: 7/24/03