

UTILITIES BY OTHERS

NOTE:  
ALL PROPOSED UTILITY WORK  
SHOWN ON THIS SHEET WILL  
BE DONE BY OTHERS

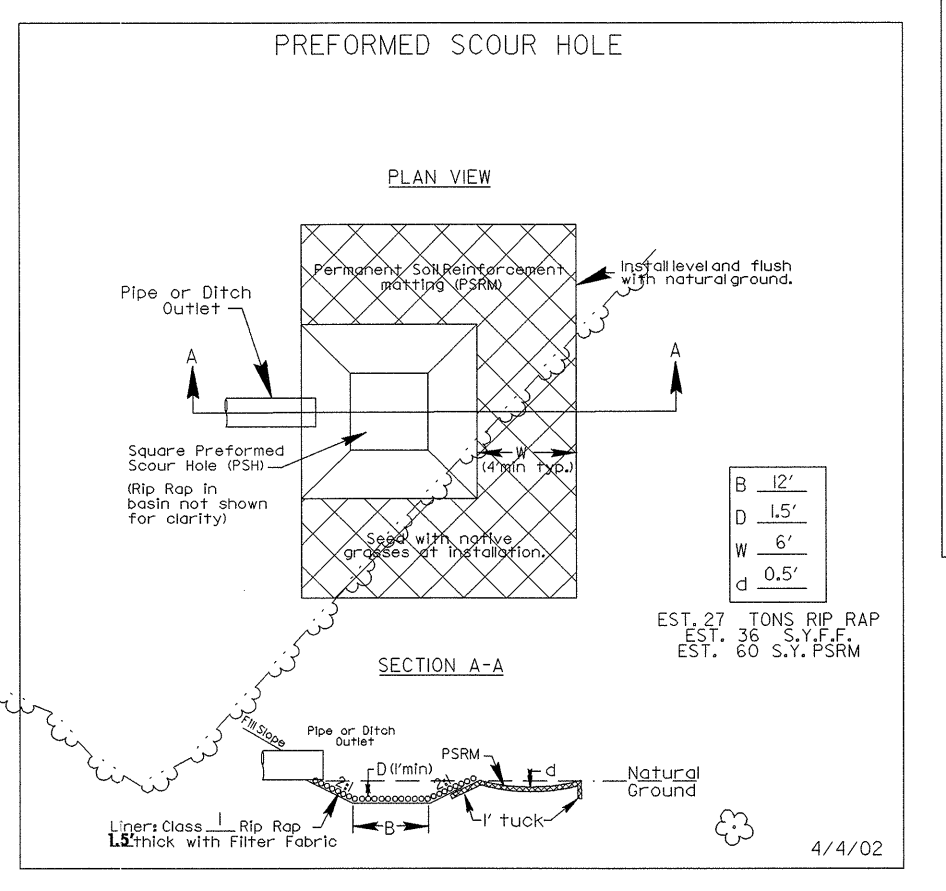
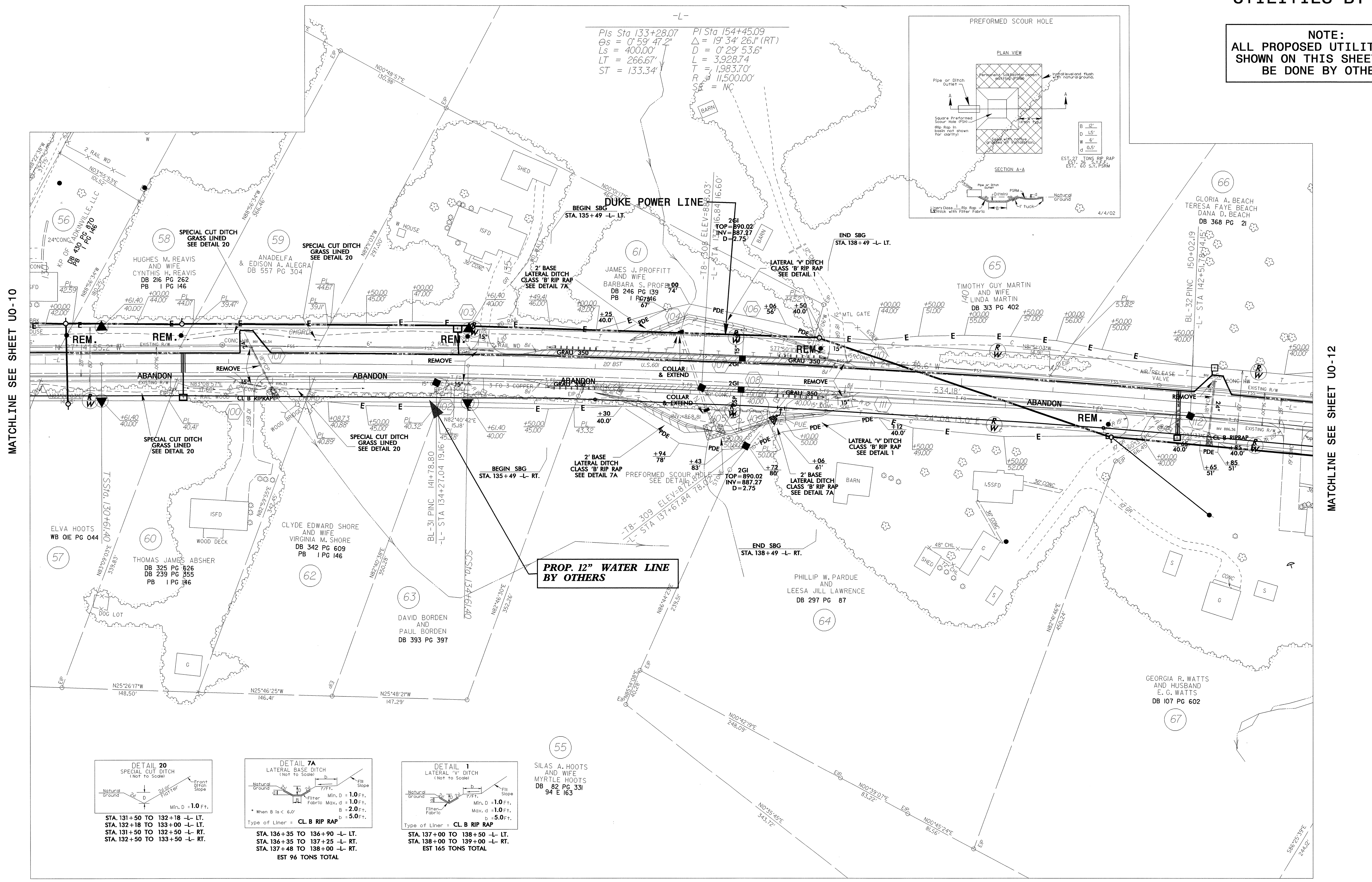

$Pis Sta 133+28.07$   
 $\Theta s = 0^{\circ} 59' 47.2''$   
 $Ls = 400.00'$   
 $LT = 266.67'$   
 $ST = 133.34'$

$PI Sta 154+45.09$   
 $\Delta = 19^{\circ} 34' 26.1'' (RT)$   
 $D = 0^{\circ} 29' 53.6''$   
 $L = 3,928.74'$   
 $T = 1,983.70'$   
 $R = 11,500.00'$   
 $S.E. = NC$

**PROP. 12" WATER LINE BY OTHERS**

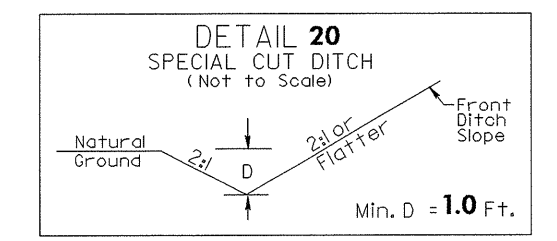

STA. 131+50 TO 132+18 -L- LT.  
 STA. 132+18 TO 133+00 -L- LT.  
 STA. 131+50 TO 132+50 -L- RT.  
 STA. 132+50 TO 133+50 -L- RT.

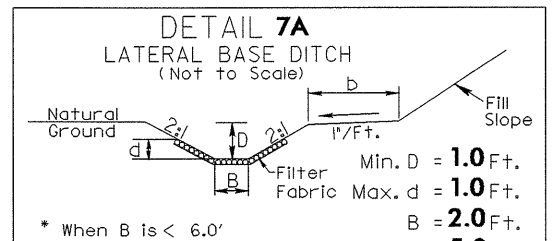

STA. 136+35 TO 136+90 -L- LT.  
 STA. 136+35 TO 137+25 -L- RT.  
 STA. 137+48 TO 138+00 -L- RT.  
 EST 96 TONS TOTAL

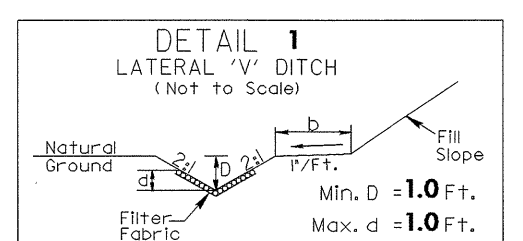

STA. 137+00 TO 138+50 -L- LT.  
 STA. 138+00 TO 139+00 -L- RT.  
 EST 165 TONS TOTAL

MATCHLINE SEE SHEET UO-10

MATCHLINE SEE SHEET UO-12

8/17/99  
30-AUG-2004 10:55  
F:\Utilities\Projects\3427\UO\_11\psh.dgn  
asunder\_01\_DS214771