

## DETOUR MAP FOR LONE HICKORY ROAD

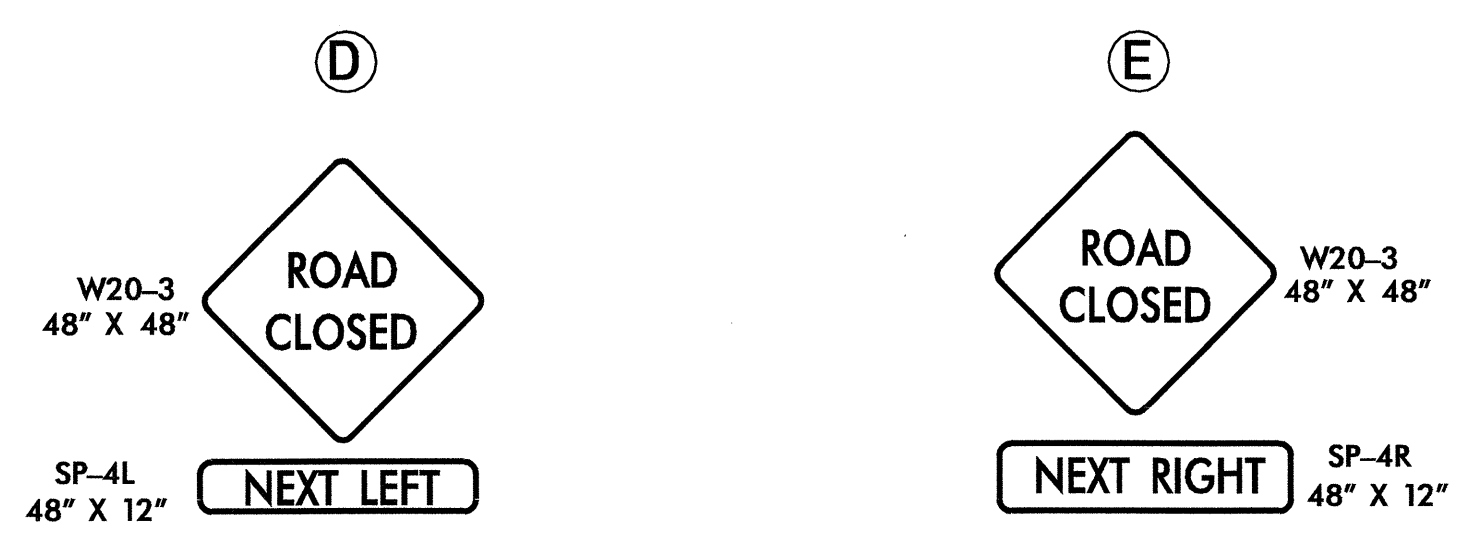
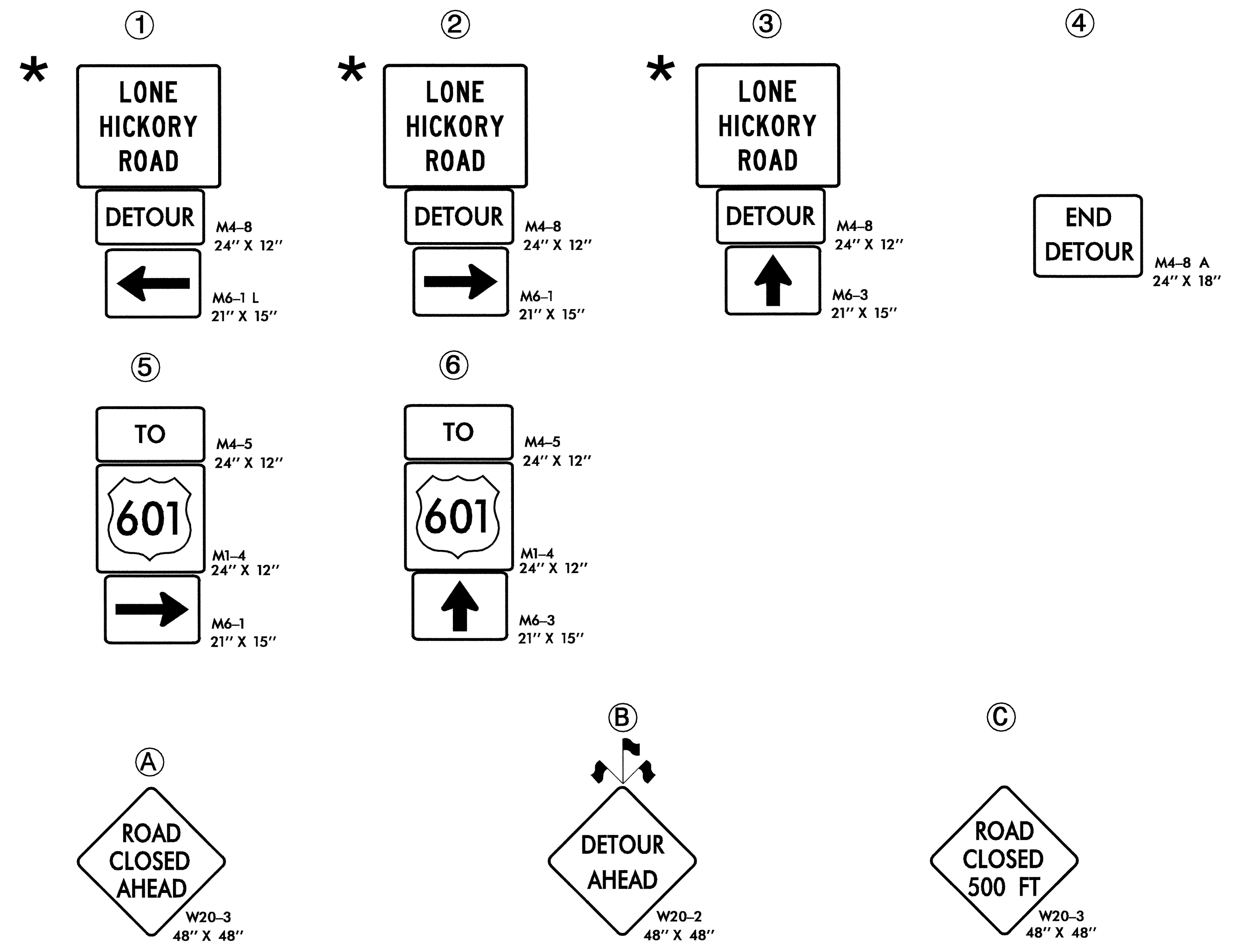
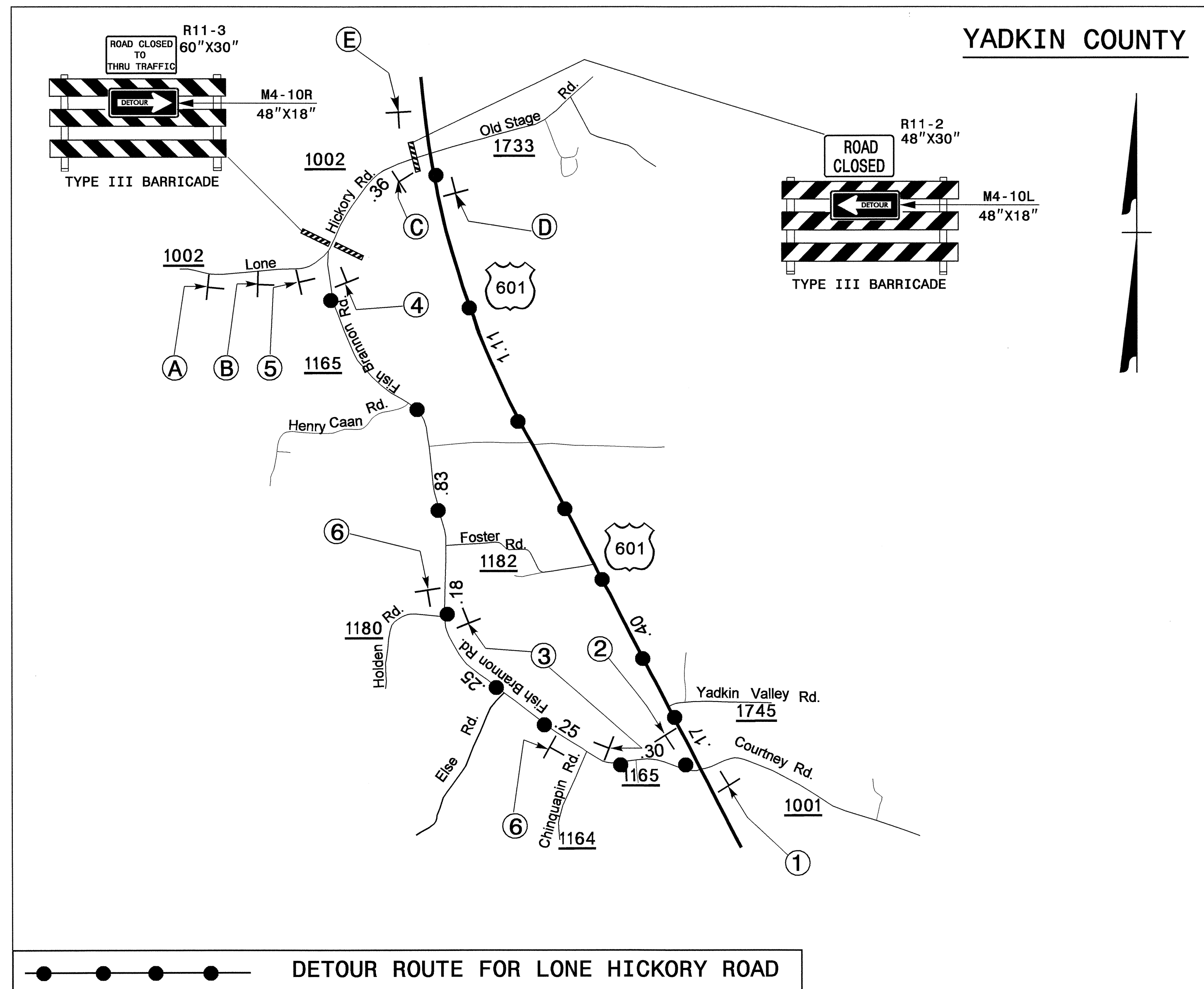

- USE THIS SHEET IN CONJUNCTION WITH RSD 1101.03 SHEETS 1 OF 9 & 2 OF 9  
 - \* SEE SHEET TCP-19A FOR SIGN DESIGN

APPROVED: <i>Joseph Ishak</i> DATE: 8/17/04	<b>DETOUR MAP &amp; SIGNS FOR LONE HICKORY ROAD</b>		
	SCALE: NONE		
	DATE: JULY 2004		REVISIONS
	DWG. BY: HAL		
	DESIGN BY: HAL		
REVIEWED BY: JI		CADD FILE	

11-AUG-2004 10:12 M:\TCP\updated\TCP\TCP-14A\TC-BTsp.dgn  
 halawandos AT TETC206424