

5/14/99

PROJECT REFERENCE NO. R-3427	SHEET NO. 39
ROADWAY DESIGN ENGINEER	HYDRAULICS ENGINEER

\*\* DESIGN EXCEPTION REQUIRED FOR VERTICAL CURVE

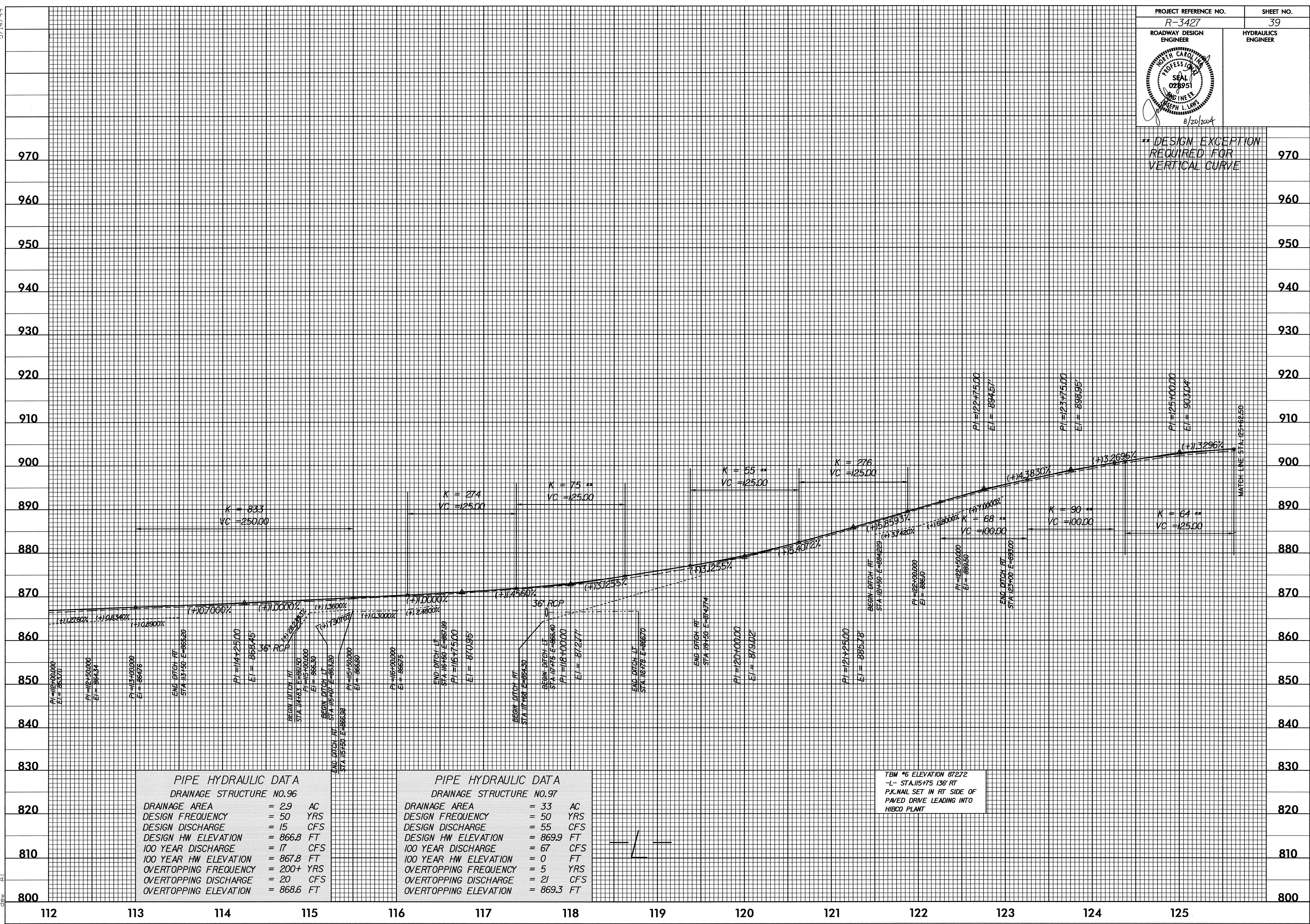

PIPE HYDRAULIC DATA	
DRAINAGE STRUCTURE NO.96	
DRAINAGE AREA	= 29 AC
DESIGN FREQUENCY	= 50 YRS
DESIGN DISCHARGE	= 15 CFS
DESIGN HW ELEVATION	= 866.8 FT
100 YEAR DISCHARGE	= 17 CFS
100 YEAR HW ELEVATION	= 867.8 FT
OVERTOPPING FREQUENCY	= 200+ YRS
OVERTOPPING DISCHARGE	= 20 CFS
OVERTOPPING ELEVATION	= 868.6 FT

PIPE HYDRAULIC DATA	
DRAINAGE STRUCTURE NO.97	
DRAINAGE AREA	= 33 AC
DESIGN FREQUENCY	= 50 YRS
DESIGN DISCHARGE	= 55 CFS
DESIGN HW ELEVATION	= 869.9 FT
100 YEAR DISCHARGE	= 67 CFS
100 YEAR HW ELEVATION	= 0 FT
OVERTOPPING FREQUENCY	= 5 YRS
OVERTOPPING DISCHARGE	= 21 CFS
OVERTOPPING ELEVATION	= 869.3 FT

TBM #6 ELEVATION 872.72  
 -L- STA.115+75 136' RT  
 P.K.NAIL SET IN RT SIDE OF  
 PAVED DRIVE LEADING INTO  
 HIBCO PLANT

20-AUG-2004 10:54 AM  
 C:\Users\jlaw\Documents\3427\p3427.psh  
 C:\Users\jlaw\Documents\3427\p3427.psh