

NOTE:  
UTILIZE TEMPORARY ROCK SEDIMENT DAM TYPE - B AS STILLING BASIN WHERE APPLICABLE.

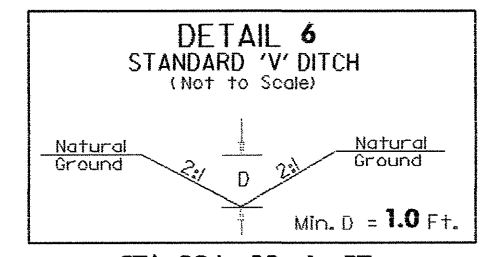

STA. 234+00 -L- RT.  
STA. 240+00 -L- RT.  
STA. 234+49 TO 234+90 -L- RT. (RETENTION BASIN OUTLET)  
STA. 236+95 TO 237+86 -L- RT. (RETENTION BASIN OUTLET)

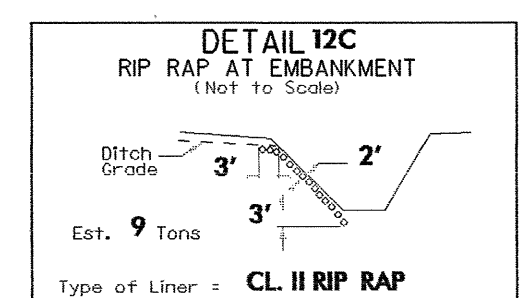

Est. 9 Tons  
Type of Liner = CL II RIP RAP  
STA. 236+92 -L- LT.  
@ PERM. LATERAL 'V' DITCH

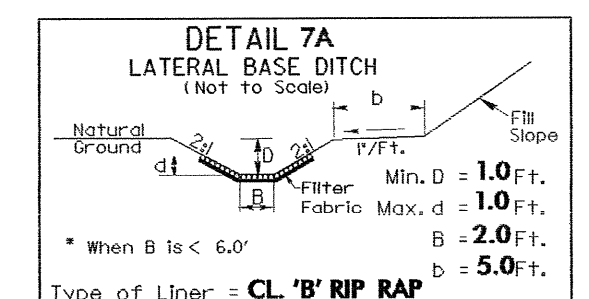

Type of Liner = CL 'B' RIP RAP  
FROM STA. 239+50 TO 240+50 -L- LT  
EST. 60 TONS  
EST. 78 S.Y.F.F.  
EST. 132 C.Y. DDE

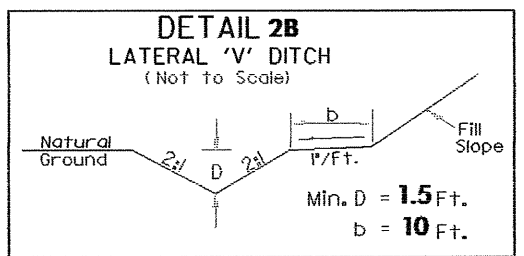

STA. 236+92 TO 238+87 -L- LT.  
STA. 18+78 TO 21+09 -DETA- LT.  
EST. 128 C.Y. DDE -L-  
EST. 107 C.Y. DDE -DETA-

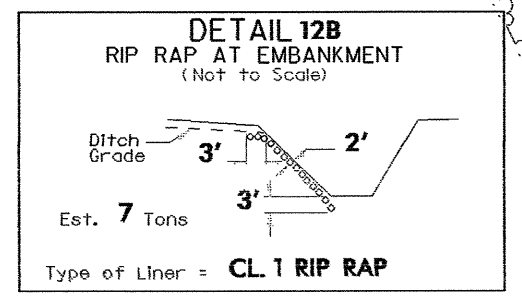

Est. 7 Tons  
Type of Liner = CL I RIP RAP  
STA. 236+62 -L- LT.  
@ TEMP. LATERAL 'V' DITCH

BARBARA H. FOX, CLARA H. MARTIN,  
CLYDE HOOTS, JR. AND NANCY H. WALLS  
DB 239 PG 430

MATCHLINE \*\* SEE SHEET 19 \*\*

MATCHLINE \*\* SEE SHEET 21 \*\*

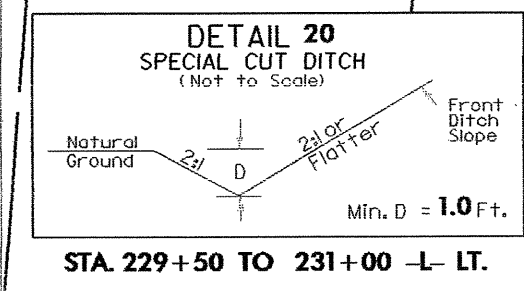
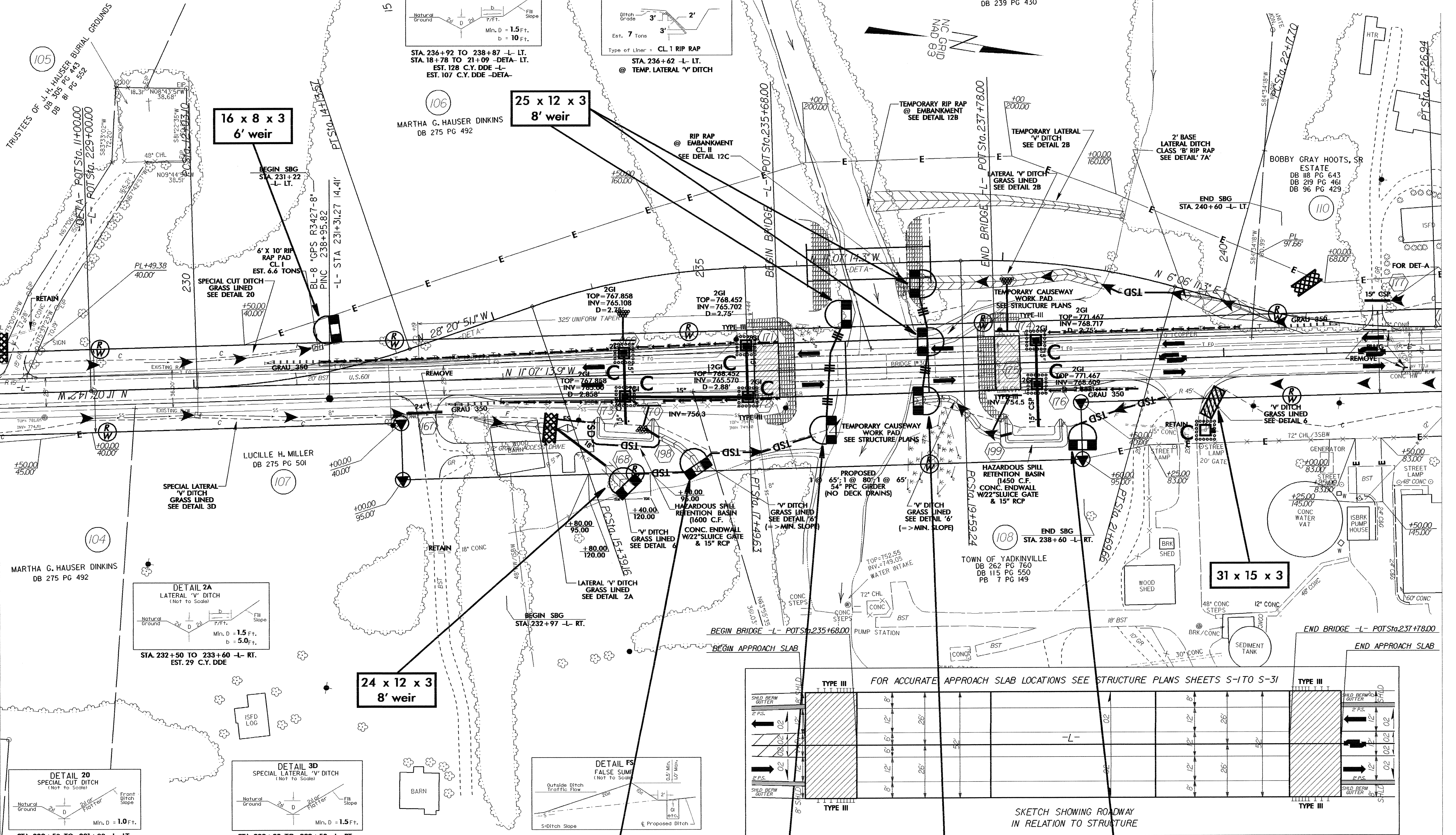

STA. 229+50 TO 231+00 -L- RT.

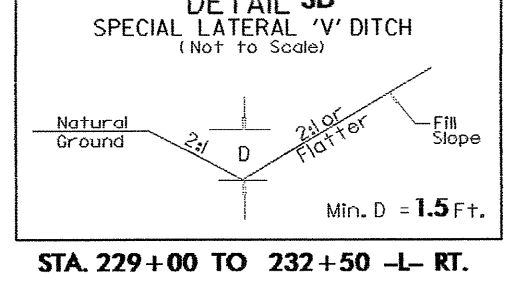

STA. 229+00 TO 232+50 -L- RT.

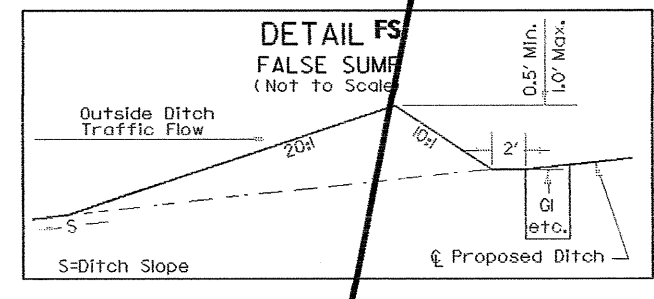

24 x 12 x 3 8' weir

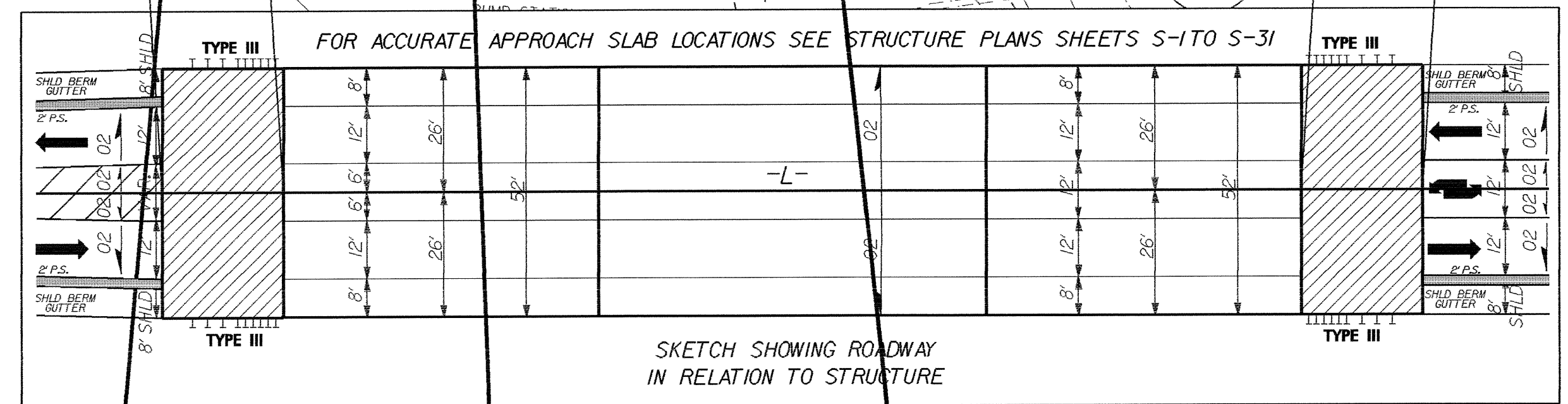

20 x 10 x 3 8' weir

17 x 8 x 3 6' weir

10 x 5 x 3 4' weir

7/2/99

28-SEP-2004 15:26  
C:\REVENUE\ROADWAY\PS20\3427.rpt  
C:\REVENUE\ROADWAY\PS20\3427.rpt