

18+00 18+50 19+00 19+50

F. A. PROJECT NO. BRSTP-111(9)

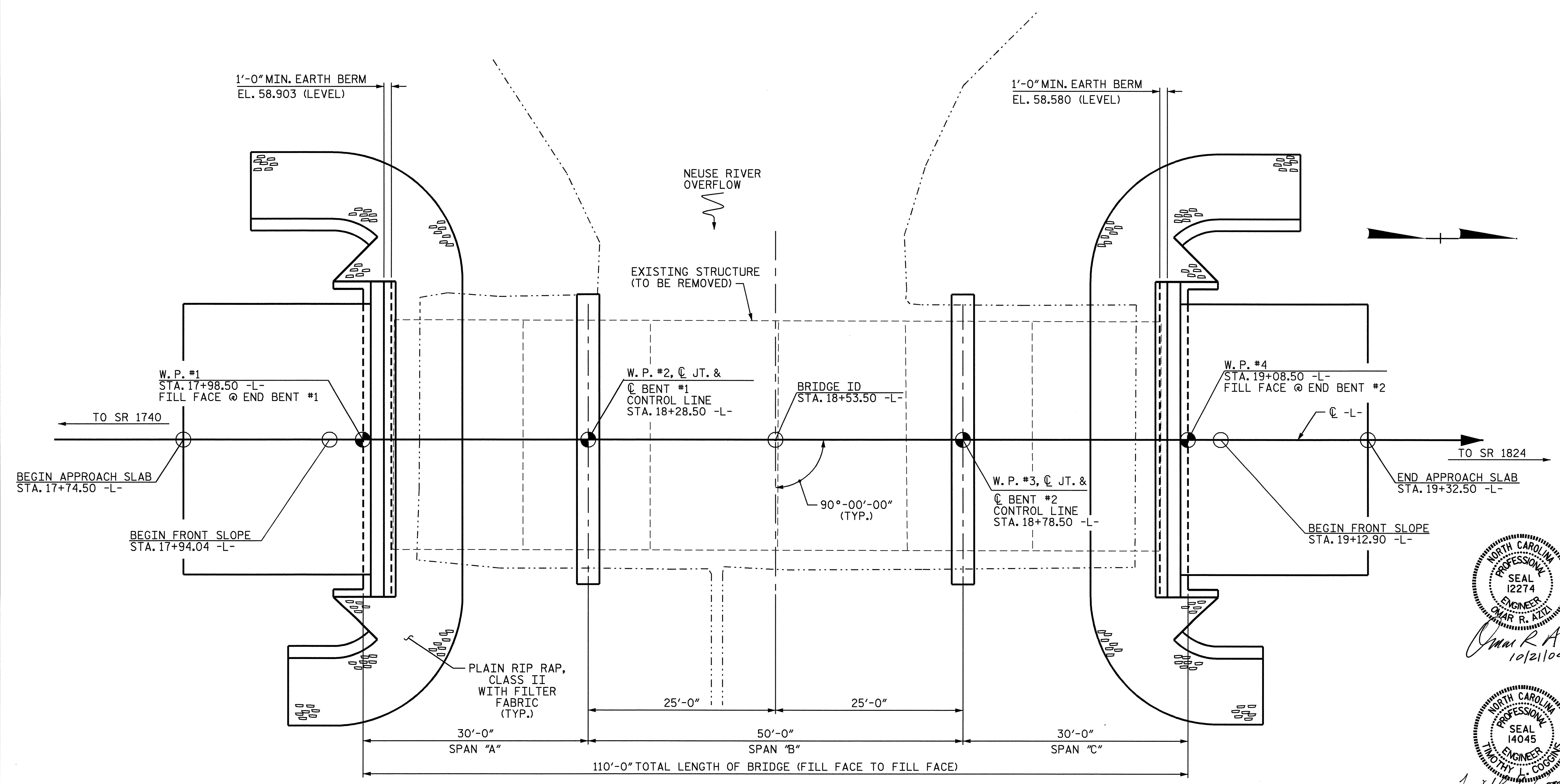
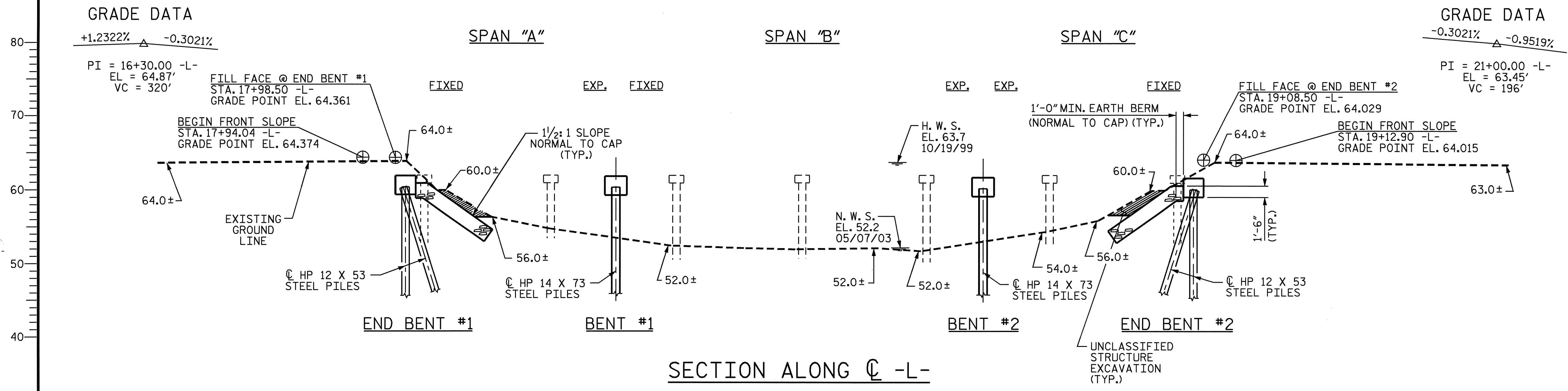

NORTH CAROLINA PROFESSIONAL SEAL 12274 ENGINEER QMAR R. AZIZI

NORTH CAROLINA PROFESSIONAL SEAL 14045 ENGINEER JIMMY A. COOPER

PROJECT NO. B-3711
 WAYNE COUNTY
 STATION: 18+53.50 -L-
 SHEET 1 OF 3 REPLACES BRIDGE NO. 42

STATE OF NORTH CAROLINA
 DEPARTMENT OF TRANSPORTATION
 RALEIGH
 GENERAL DRAWING
 FOR BRIDGE OVER NEUSE RIVER
 OVERFLOW ON NC 111 BETWEEN
 SR 1740 AND SR 1824

DRAWN BY: PEGGY ADKINS DATE: 10-03
 CHECKED BY: J. AVERETTE DATE: 6-04

21-OCT-2004 08:37
 W:\squad\B3711\pdkins\Microstation\B3711_SD_GD_01.dgn
 pdkins

REVISIONS						SHEET NO.	
NO.	BY:	DATE:	NO.	BY:	DATE:	S-1	
1			3			TOTAL SHEETS	19
2			4				

NC005