

CONTRACT: C200928 TIP: B-3704

See Sheet 1-A For Index of Sheets
See Sheet 1-B For Conventional Symbols

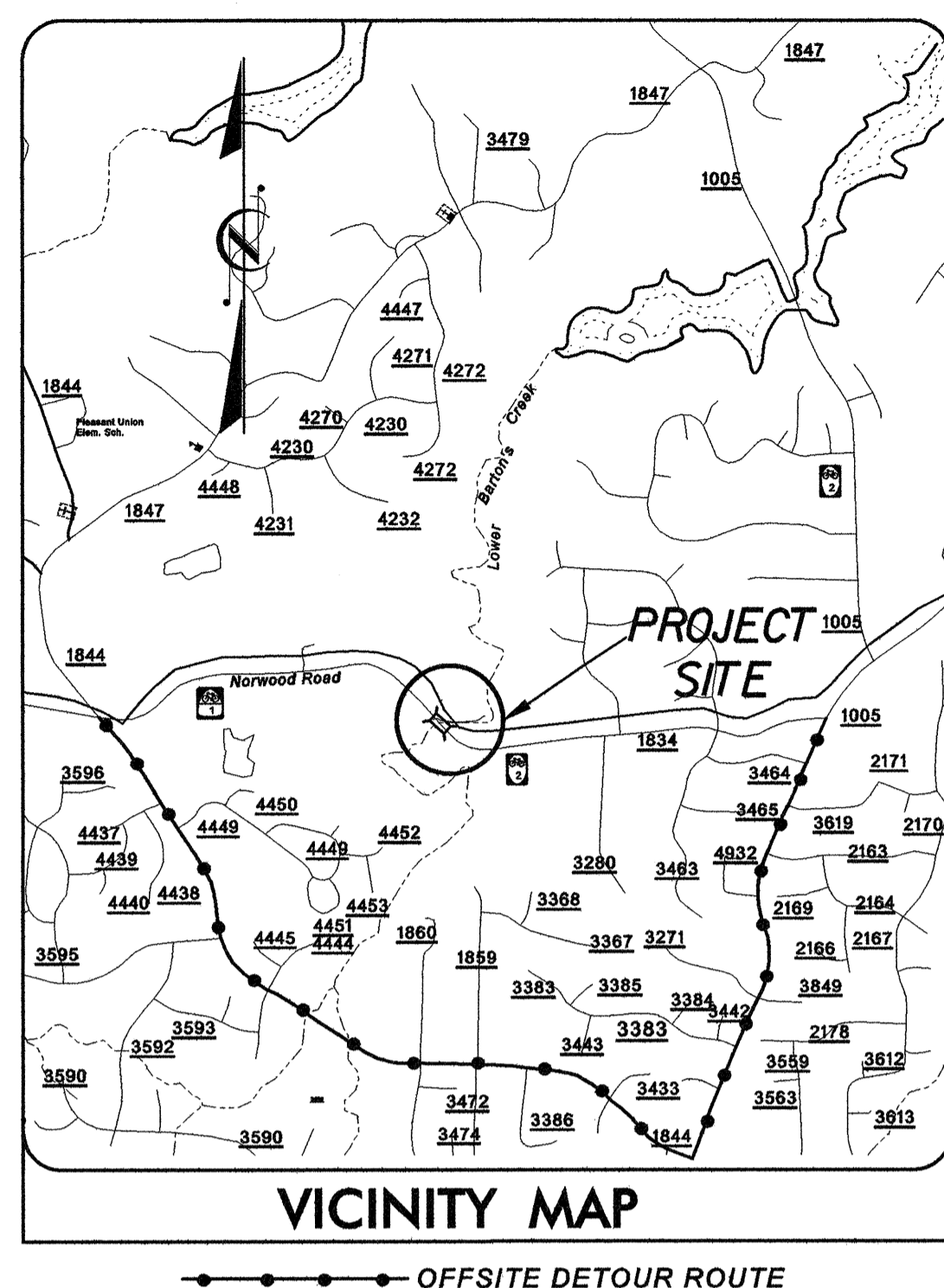

STATE OF NORTH CAROLINA
DIVISION OF HIGHWAYS
WAKE COUNTY

STATE	STATE PROJECT REFERENCE NO.	SHEET NO.	TOTAL SHEETS
N.C.	B-3704	1	
WBS NO.	F.A. PROJ. NO.	DESCRIPTION	
33244.1.1	BRZ-1834(2)	P.E.	
33244.2.2	BRZ-1834(3)	RW & UTILITIES	
33244.3.1	BRZ-1834(4)	CONST.	

LOCATION: BRIDGE NO.108 OVER LOWER BARTON'S CREEK ON SR 1834 (NORWOOD ROAD)

TYPE OF WORK: GRADING, DRAINAGE, STRUCTURE, AND PAVING

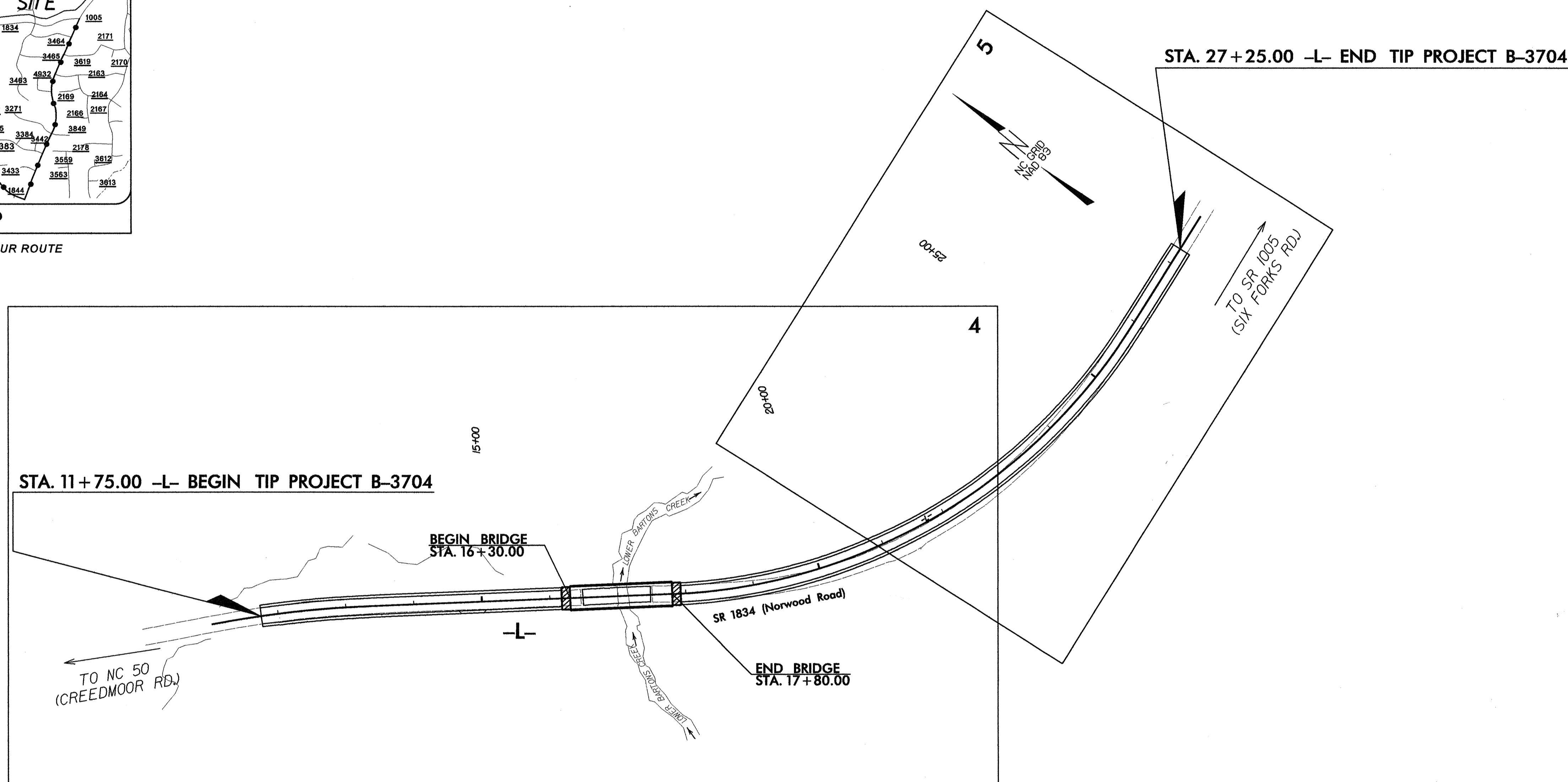

NCDOT CONTACT: TERESA BRUTON, P.E.
PROJECT ENGINEER - ROADWAY DESIGN UNIT

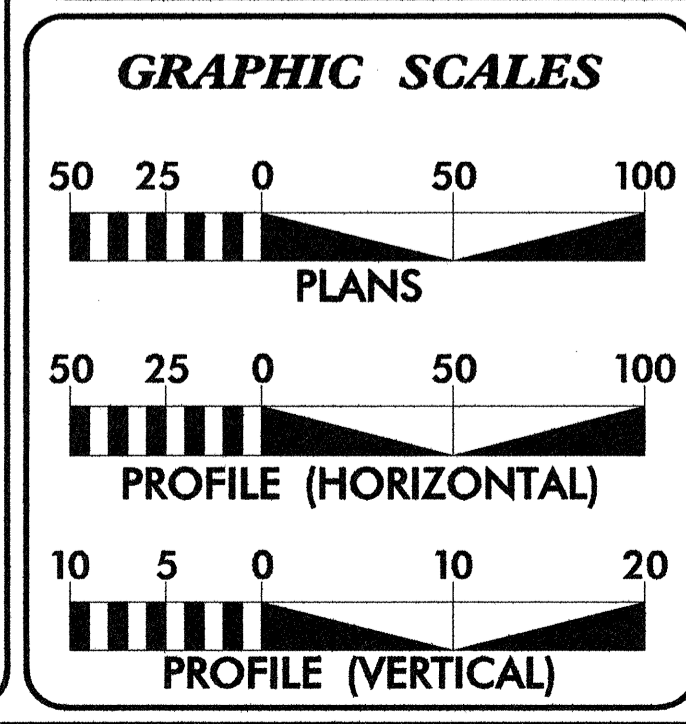

DESIGN DATA

ADT 2004 =	1700
ADT 2024 =	5320
DHV =	10 %
D =	60 %
T =	3 % *
V =	50 MPH

* (TTST 1% + DUAL 2%)

PROJECT LENGTH

LENGTH ROADWAY TIP PROJECT B-3704 =	0.266 mi.
LENGTH STRUCTURE TIP PROJECT B-3704 =	0.028 mi.
TOTAL LENGTH TIP PROJECT B-3704 =	0.294 mi.

Prepared in the Office of:
WANG ENGINEERING COMPANY, INC.
CARY, N.C.
FOR NORTH CAROLINA DEPARTMENT OF TRANSPORTATION

2002 STANDARD SPECIFICATIONS

RIGHT OF WAY DATE:
SEPTEMBER 19, 2003

LETTING DATE:
DECEMBER 21, 2004

GREG S. PURVIS, P. E.
PROJECT ENGINEER

SCOTT L. KENNEDY
PROJECT DESIGN ENGINEER

HYDRAULICS ENGINEER

ROADWAY DESIGN ENGINEER

9-30-04

SIGNATURE: _____ P.E.

DIVISION OF HIGHWAYS
STATE OF NORTH CAROLINA

STATE DESIGN ENGINEER

DEPARTMENT OF TRANSPORTATION
FEDERAL HIGHWAY ADMINISTRATION

APPROVED _____ DATE _____
DIVISION ADMINISTRATOR

\\nas001\p101\33704_1\fig_1.dgn 09/28/2004 03:55:02 PM