

SURVEY CONTROL SHEET

WBS 33244.1.1

LOCATION: BRIDGE NO. 108 OVER LOWER BARTON'S CREEK ON SR 1834 (NORWOOD ROAD)

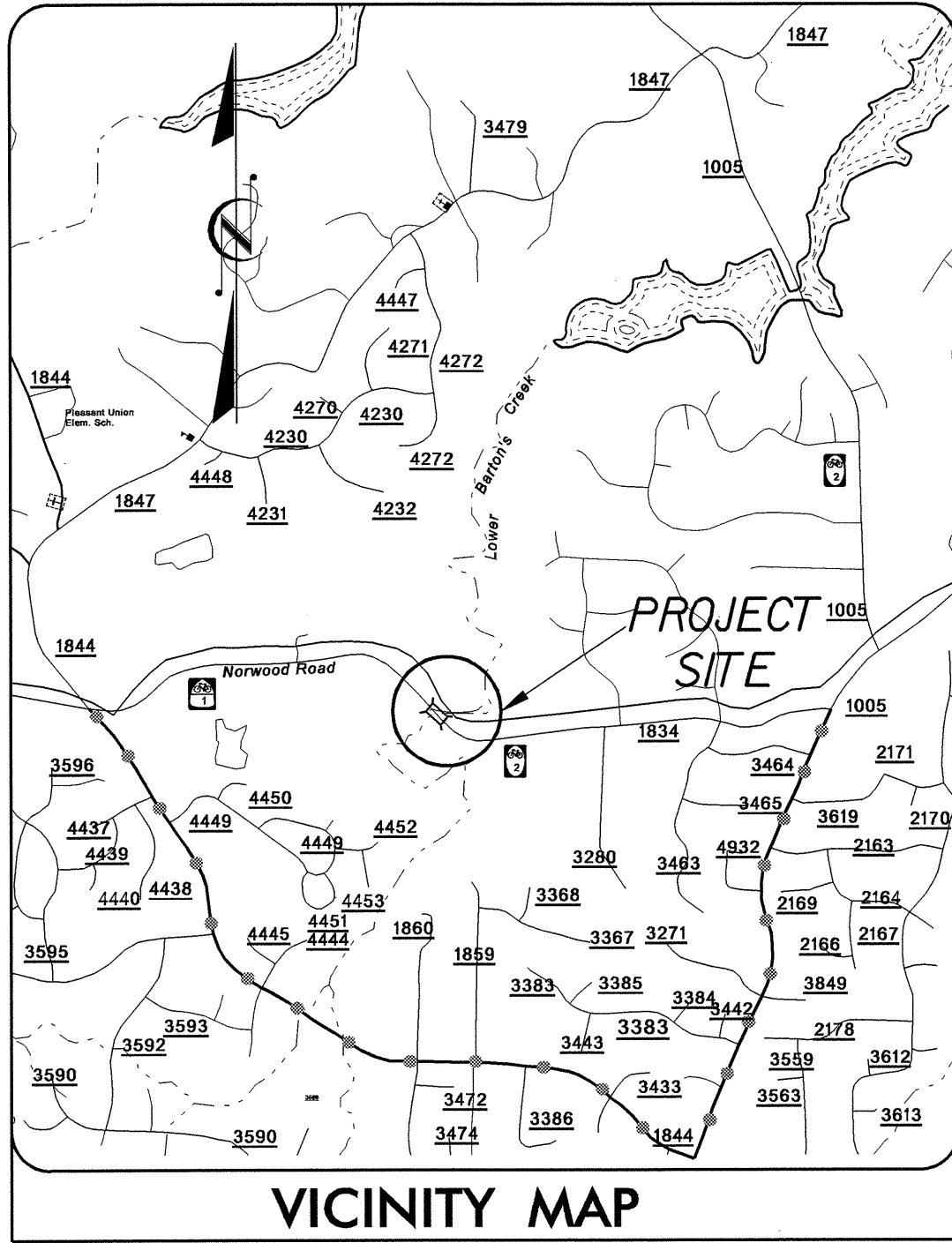

VICINITY MAP

OFFSITE DETOUR ROUTE

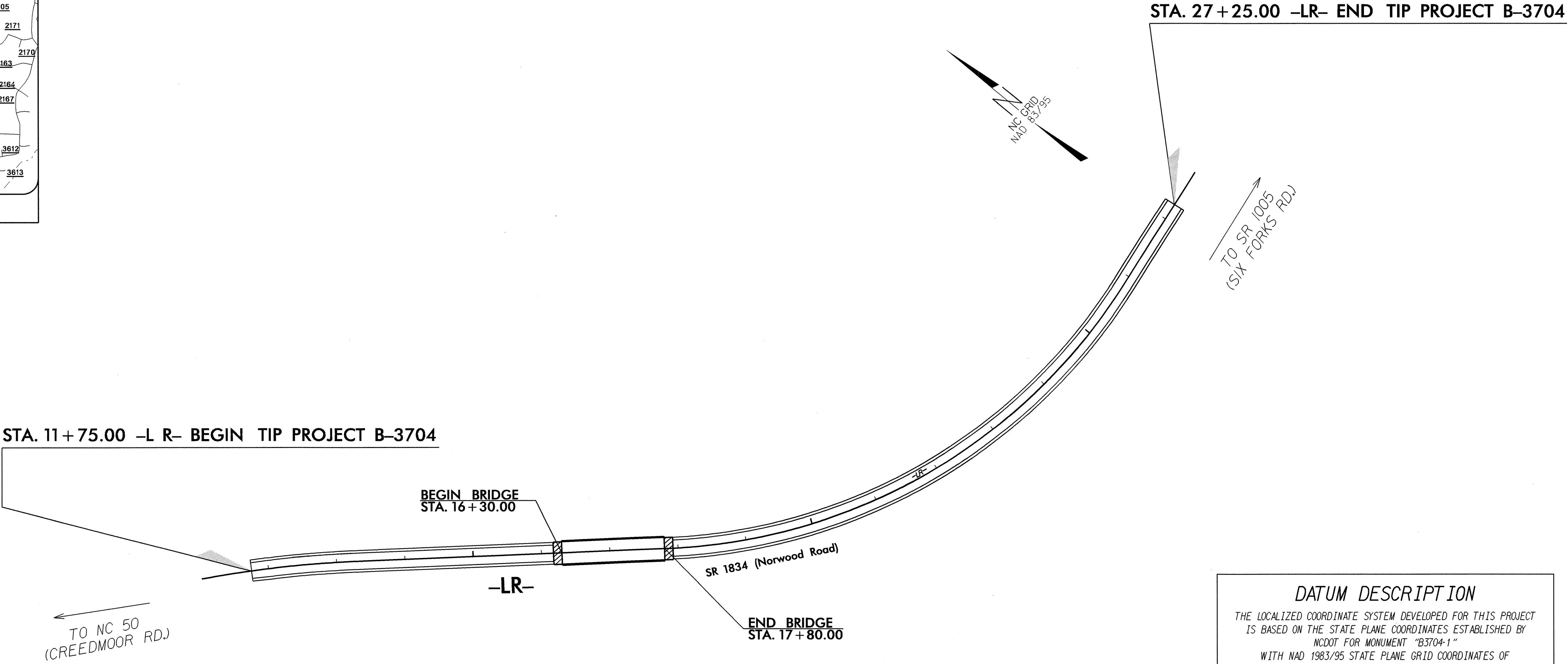

DATUM DESCRIPTION
 THE LOCALIZED COORDINATE SYSTEM DEVELOPED FOR THIS PROJECT IS BASED ON THE STATE PLANE COORDINATES ESTABLISHED BY NCDOT FOR MONUMENT "B3704-1" WITH NAD 1983/95 STATE PLANE GRID COORDINATES OF NORTHING: 799308.2602ft) EASTING: 209989.16990ft) THE AVERAGE COMBINED GRID FACTOR USED ON THIS PROJECT (GROUND TO GRID) IS: 99993426 THE N.C. LAMBERT GRID BEARING AND LOCALIZED HORIZONTAL GROUND DISTANCE FROM "B3704-1" TO -L-R STATION 10+00.00 IS S 54°59'33.9" E 410.59 ALL LINEAR DIMENSIONS ARE LOCALIZED HORIZONTAL DISTANCES VERTICAL DATUM USED IS NAVD 88

BL	POINT	DESC.	NORTH	EAST	ELEVATION	LR STATION	OFFSET
	101	BL-101	799066.5170	2100209.7590	304.08	OUTSIDE PROJECT LIMITS	
	102	BL-102	798868.9820	2100433.7930	293.97	12+90.60	14.28 RT
	103	BL-103	798606.3800	2100668.9140	280.53	16+43.47	15.53 RT
	104	BL-104	798284.7630	2101006.1900	293.61	20+99.94	42.55 RT
	105	BL-105	798228.3890	2101544.4120	325.46	26+30.58	20.77 RT

.....
 203 ELEVATION - 271.68
 N 798537 E 2100629
 LR STATION 11+71.78 RIGHT
 BM*1 RRS 16" POPLAR

 204 ELEVATION - 318.48
 N 798315 E 2101497
 LR STATION 21+03.81 LEFT
 BM*2 RRS 20" HICKORY

NOTES:
 THE CONTROL DATA FOR THIS PROJECT CAN BE FOUND ELECTRONICALLY BY SELECTING [HTTP://WWW.DOH.DOT.STATE.NC.US/PRECONSTRUCT/HIGHWAY/LOCATION/PROJECT](http://www.doh.dot.state.nc.us/preconstruct/highway/location/project) THE FILES TO BE FOUND ARE AS FOLLOWS
 B3704 LS CONTROL_030612.TXT
 SITE CALIBRATION INFORMATION HAS NOT BEEN PROVIDED FOR THIS PROJECT.
 IF FURTHER INFORMATION IS NEEDED, PLEASE CONTACT THE LOCATION AND SURVEYS UNIT.
 INDICATES GEODETIC CONTROL MONUMENTS USED OR SET FOR HORIZONTAL PROJECT CONTROL BY THE NCDOT LOCATION AND SURVEYS UNIT.
 PROJECT CONTROL ESTABLISHED USING GLOBAL POSITIONING SYSTEM.

05/09/04