

09/08/99

STATE OF NORTH CAROLINA
DIVISION OF HIGHWAYS

WAKE COUNTY

LOCATION: BRIDGE NO. 108 OVER LOWER BARTON'S CREEK ON SR 1834 (NORWOOD ROAD)

TYPE OF WORK: GRADING, DRAINAGE, STRUCTURE, AND PAVING

STATE	STATE PROJECT REFERENCE NO.	SHEET NO.	TOTAL SHEETS
N.C.	B-3704		
WBS NO.	F.A. PROJ. NO.	DESCRIPTION	
33244.1.1	BRZ-1834(2)	P.E.	
33244.2.1	BRZ-1834(2)	RW & UTILITIES	
33244.3.1		CONST.	

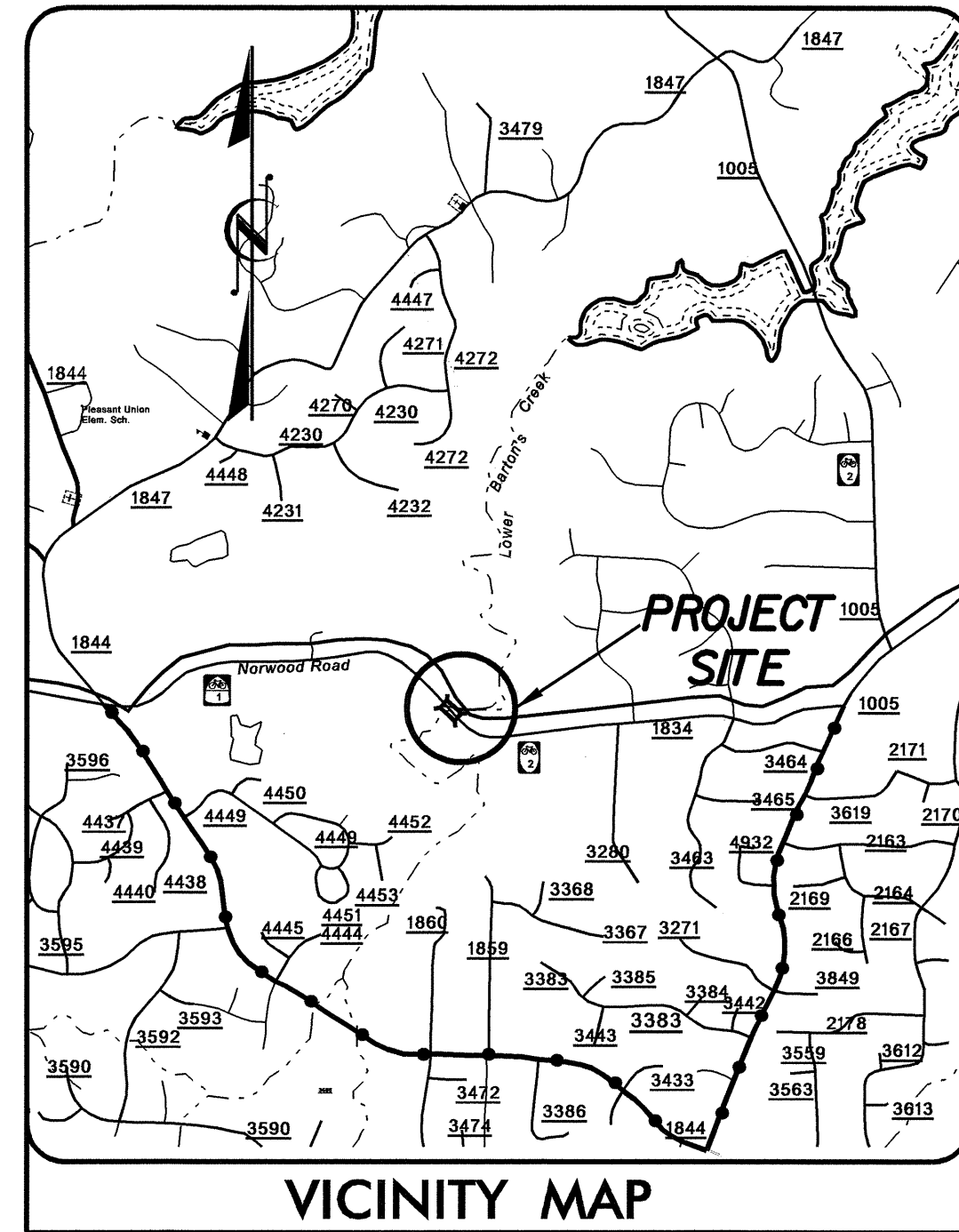

VICINITY MAP
OFFSITE DETOUR ROUTE

CONTRACT: C200928 TIP: B-3704

STRUCTURE

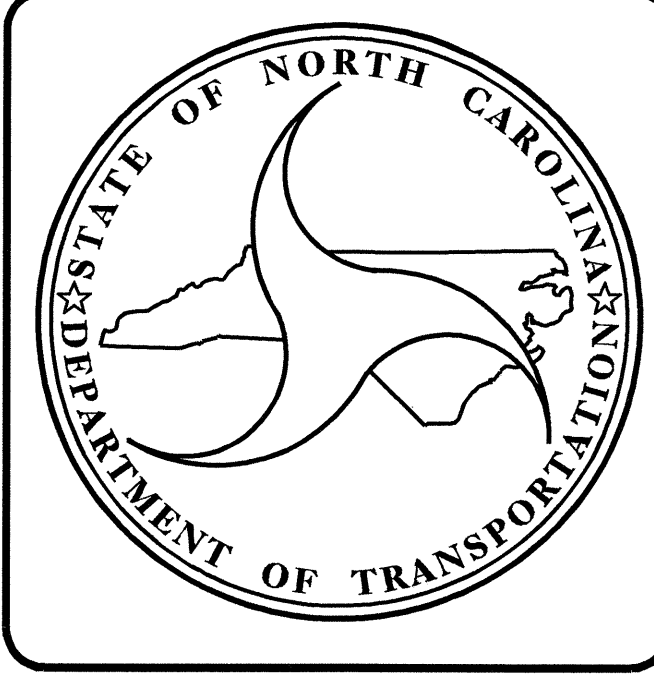
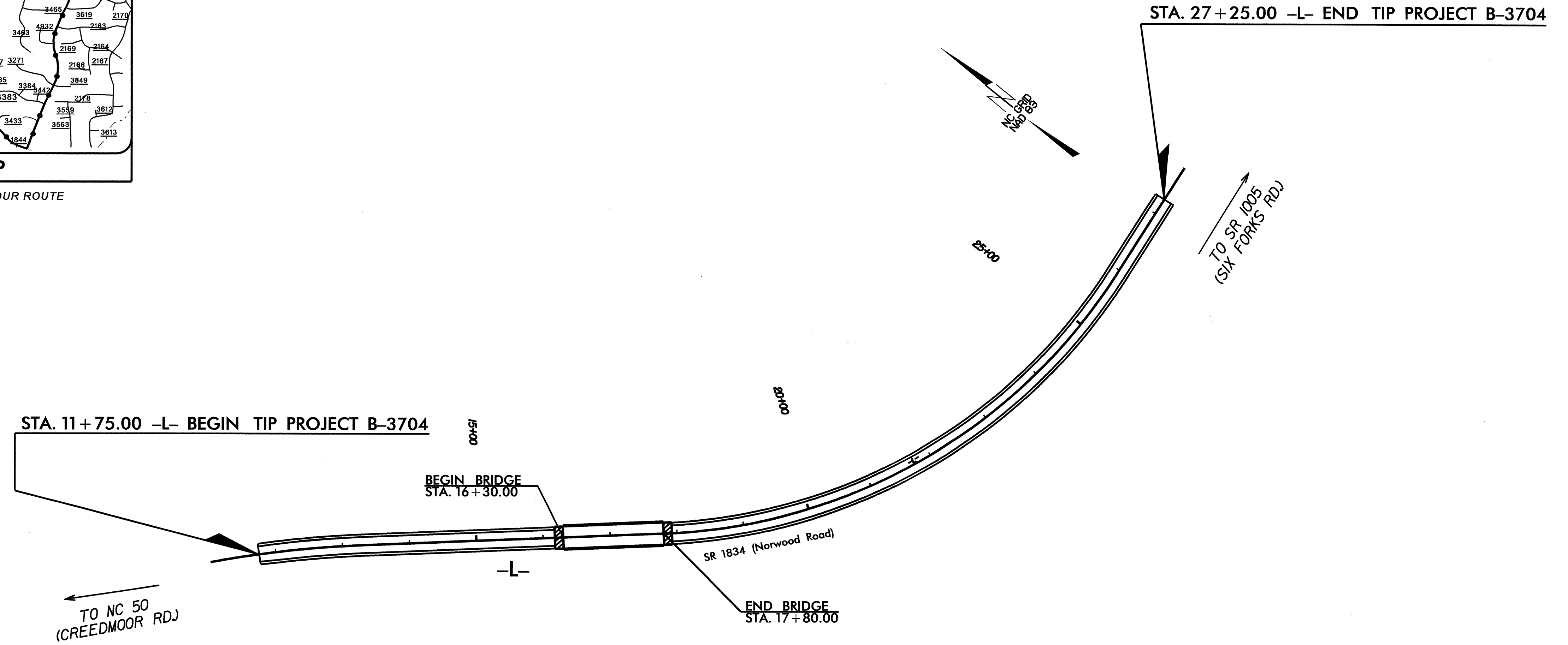

DESIGN DATA

ADT 2004 =	1700
ADT 2024 =	5320
DHV =	10 %
D =	60 %
T =	3 % *
V =	50 MPH

* (TTST 1% + DUAL 2%)

PROJECT LENGTH

LENGTH ROADWAY TIP PROJECT B-3704 =	0.266 mi.
LENGTH STRUCTURE TIP PROJECT B-3704 =	0.028 mi.
TOTAL LENGTH TIP PROJECT B-3704 =	0.294 mi.

Prepared In the Office of:
DIVISION OF HIGHWAYS
1000 BIRCH RIDGE DR., RALEIGH NC 27610

2002 STANDARD SPECIFICATIONS

LETTING DATE:
DECEMBER 21, 2004

ROY GIROLAMI, P. E.
PROJECT ENGINEER

DAVID ANDERSON, P. E.
PROJECT DESIGN ENGINEER

STRUCTURE DESIGN UNIT

10-28-04

DIVISION OF HIGHWAYS
STATE OF NORTH CAROLINA

STATE DESIGN ENGINEER

DEPARTMENT OF TRANSPORTATION
FEDERAL HIGHWAY ADMINISTRATION

APPROVED
DIVISION ADMINISTRATOR

DATE

03 SEP 2004 10:55
*****DIGN*****
