

BRIDGE 108 OVER LOWER BARTON'S CREEK

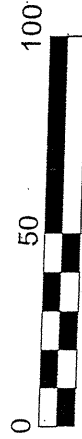

Graphic Scale (Feet)

BENCHMARK: BL-103 (N 798606.34, E 2100668.96)
 REBAR & CAP
 STA 16+43.47 -L-, 15.53' RT
 EL. 280.53 FT.

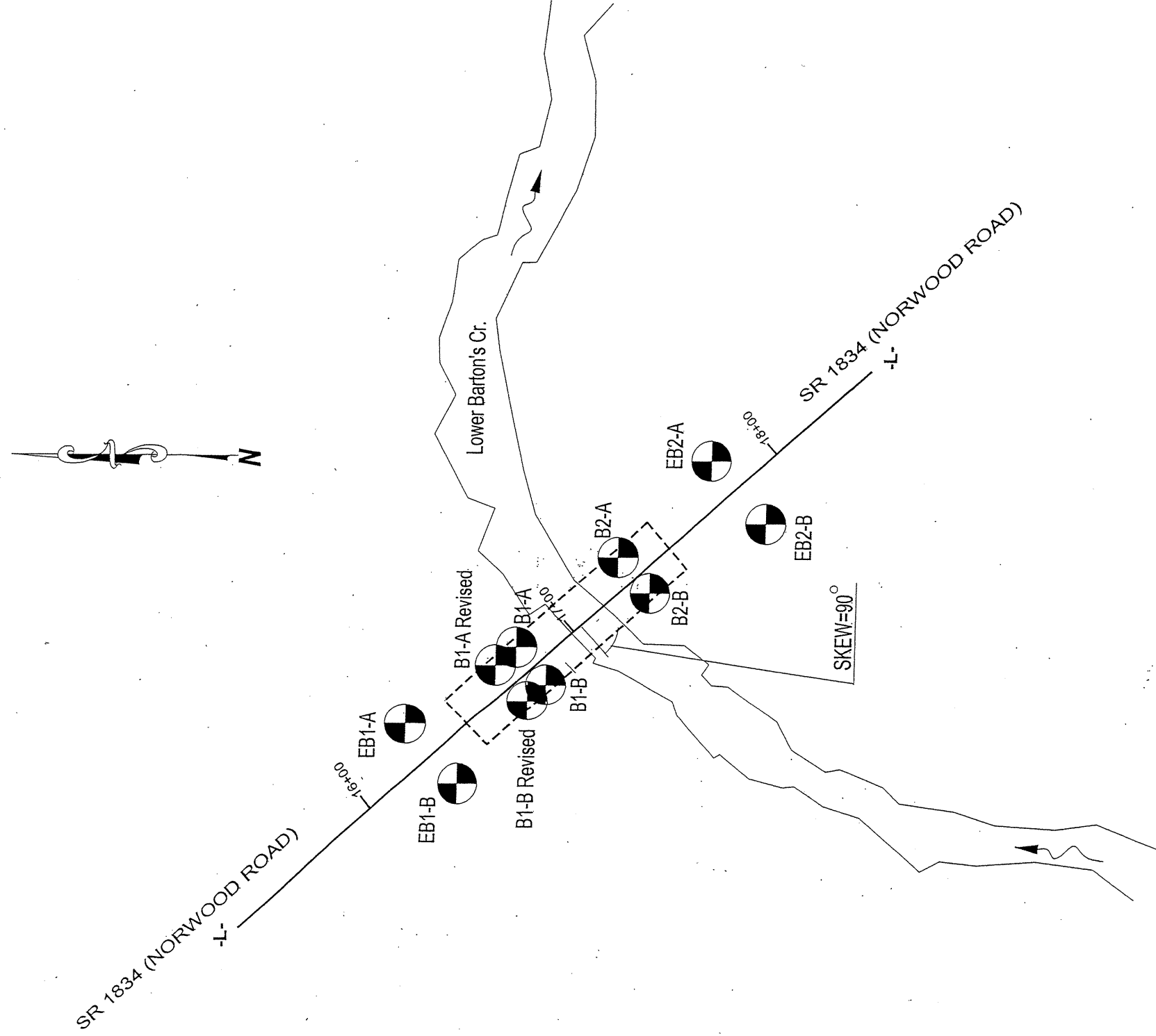
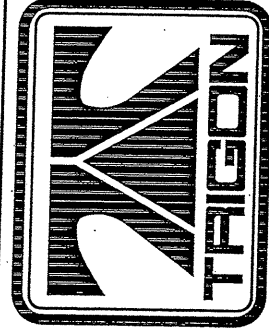

ENGINEERING CONSULTANTS, INC.

BORING IDENTIFICATION DIAGRAM

BRIDGE 108 OVER LOWER BARTON'S CREEK ON SR 1834
 WAKE COUNTY

Project No.: 8.2407901

Tip No.: B-3704

Federal No.: BRZ-1834 (2)

Vert. Scale: 1" = 50 FEET

Date: OCTOBER 2003

Horiz. Scale: 1" = 50 FEET

Drawn By: DJG

Drawing No.: 2