

TIP PROJECT: B-4270

CONTRACT: C200968

STRUCTURE

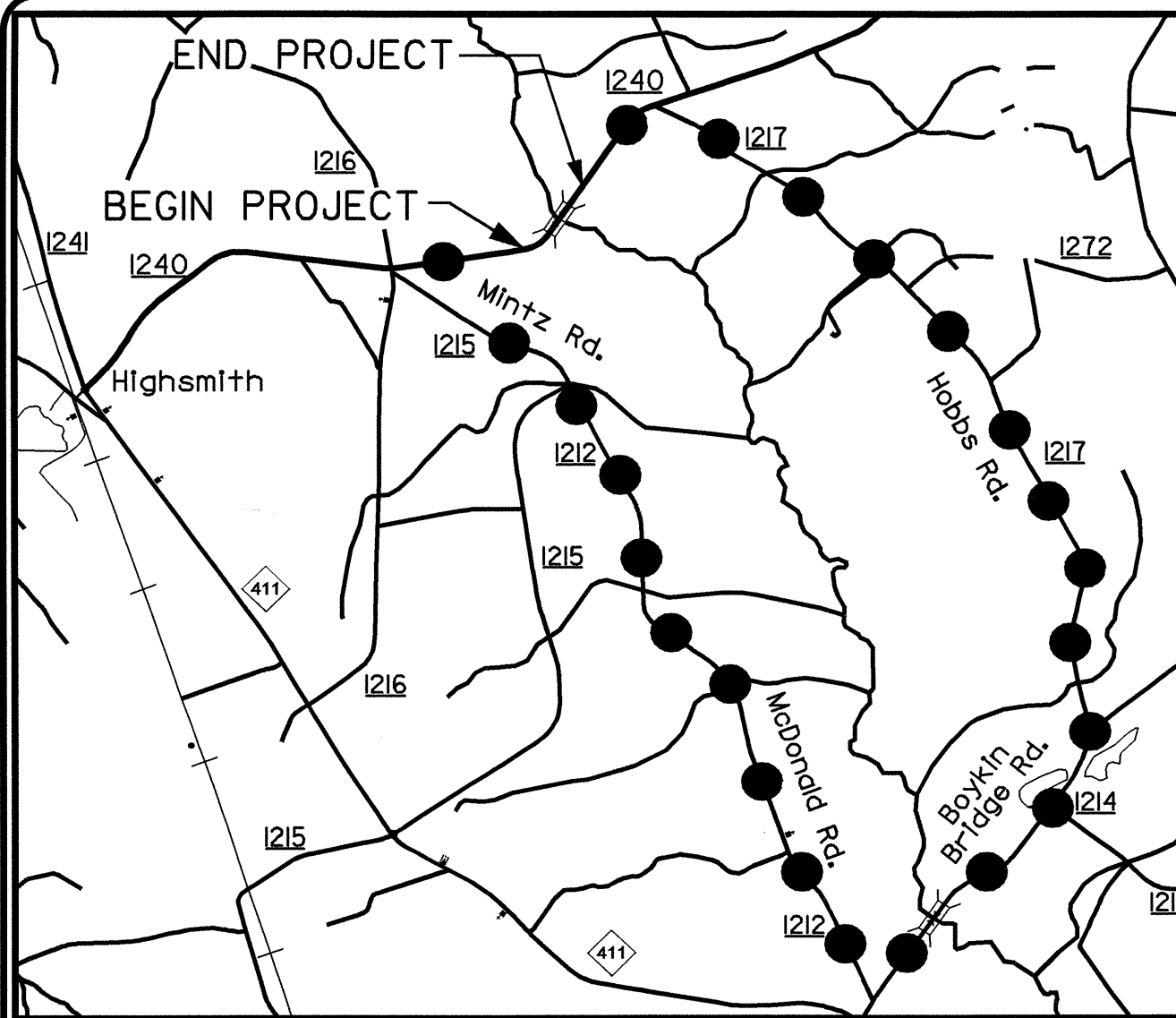

VICINITY MAP
SAMPSON COUNTY

DENOTES OFF-SITE DETOUR ●●●●●

STATE OF NORTH CAROLINA

DIVISION OF HIGHWAYS

SAMPSON COUNTY

**LOCATION: REPLACE BRIDGE NO. 93 AND APPROACHES
ON SR 1240 OVER LITTLE COHARIE CREEK**

TYPE OF WORK: GRADING, PAVING, DRAINAGE AND STRUCTURE

| STATE | STATE PROJECT REFERENCE NO. | SHEET NO. | TOTAL SHEETS |
|-----------------|-----------------------------|-------------|--------------|
| N.C. | B-4270 | | |
| STATE PROJ. NO. | F.A. PROJ. NO. | DESCRIPTION | |
| 33611.1.1 | BRZ-1240(1) | P.E. | |
| 33611.2.2 | BRZ-1240(1) | R/W & UTIL | |
| 33611.3.1 | BRZ-1240(2) | CONSTR. | |
| | | | |
| | | | |
| | | | |

STA 9+40.00 -L- POT BEGIN TIP PROJECT B-4270

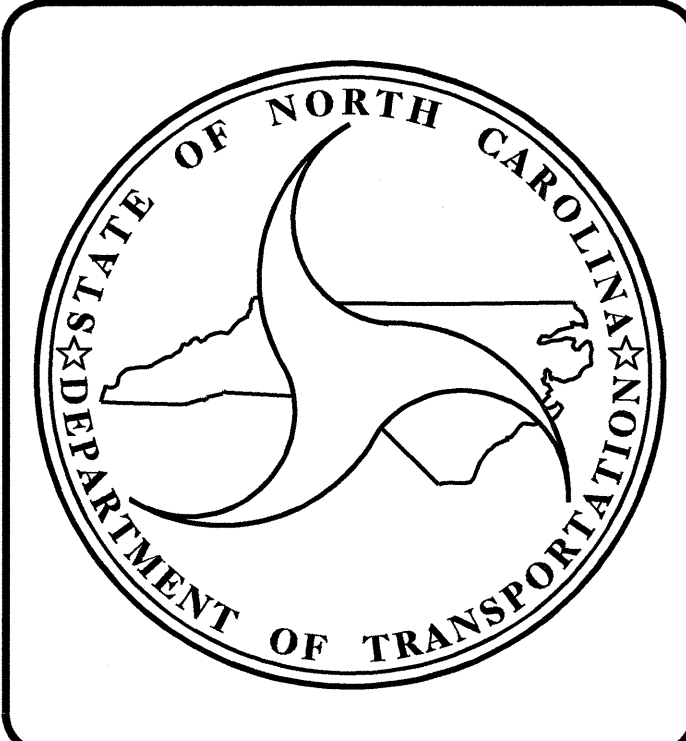
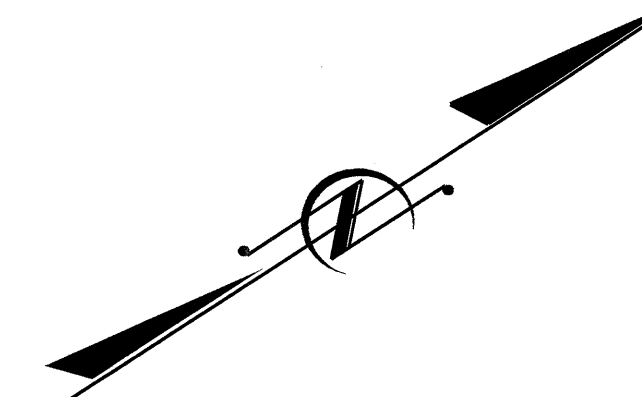
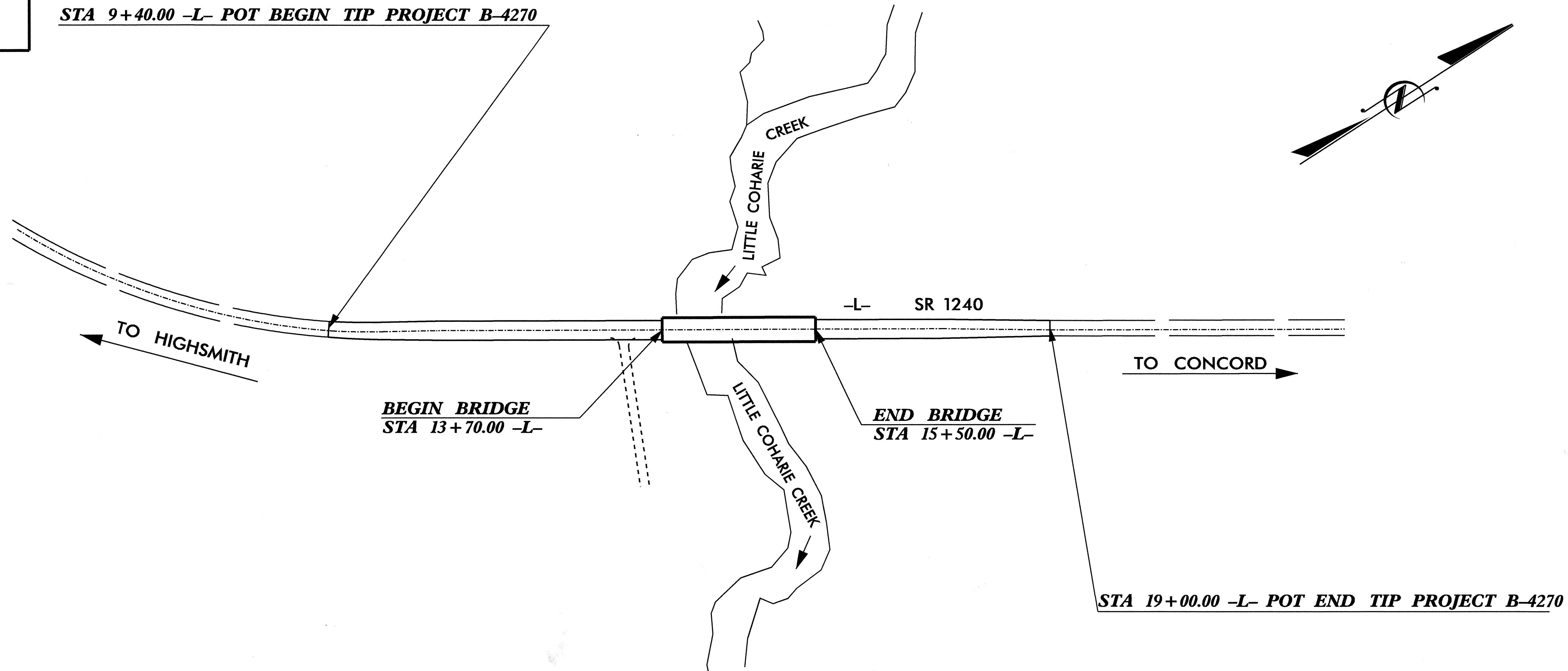

DESIGN DATA

| | |
|------------|----------|
| ADT 2004 = | 650 |
| ADT 2025 = | 1000 |
| DHV = | 12 % |
| D = | 60 % |
| T = | 4 % * |
| V = | 60 MPH |
| * TTST 1 % | DUAL 3 % |

PROJECT LENGTH

| | |
|---------------------------------------|----------|
| LENGTH ROADWAY TIP PROJECT B-4270 = | 0.148 MI |
| LENGTH STRUCTURE TIP PROJECT B-4270 = | 0.034 MI |
| TOTAL LENGTH TIP PROJECT B-4270 = | 0.182 MI |

Prepared In the Office of:

DIVISION OF HIGHWAYS

2002 STANDARD SPECIFICATIONS

| | |
|-------------------|---|
| LETTING DATE : | B. S. COX, P. E. PROJECT ENGINEER |
| DECEMBER 21, 2004 | D. E. PETREY, P. E. PROJECT DESIGN ENGINEER |

STRUCTURE DESIGN UNIT
1000 BIRCH RIDGE DR.
RALEIGH, N.C. 27610

Gregory R. Perpetti
10.29.04

DIVISION OF HIGHWAYS
STATE OF NORTH CAROLINA

STATE DESIGN ENGINEER _____ P.E.
DEPARTMENT OF TRANSPORTATION
FEDERAL HIGHWAY ADMINISTRATION

APPROVED _____ DATE _____
DIVISION ADMINISTRATOR