

UTILITY CONSTRUCTION

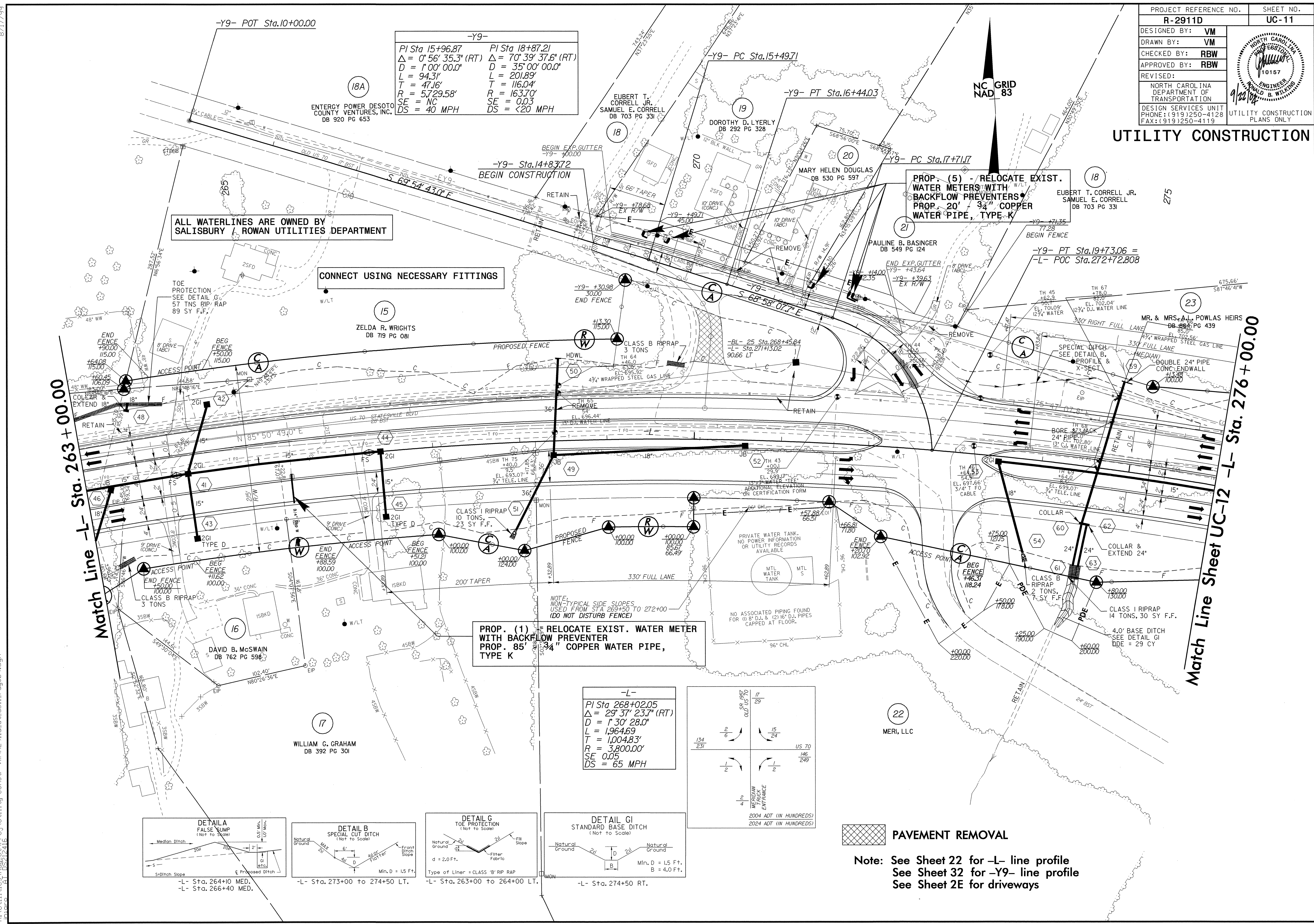

-Y9-	
PI Sta 15+96.87	PI Sta 18+87.21
$\Delta = 0^{\circ} 56' 35.3''$ (RT)	$\Delta = 7^{\circ} 39' 37.6''$ (RT)
$D = 1^{\circ} 00' 00.0''$	$D = 35^{\circ} 00' 00.0''$
$L = 94.3'$	$L = 201.89'$
$T = 47.16'$	$T = 116.04'$
$R = 5,729.58'$	$R = 163.70'$
SE = NC	SE = 0.03
DS = 40 MPH	DS = <20 MPH

-L-	
PI Sta 268+02.05	
$\Delta = 29^{\circ} 37' 23.7''$ (RT)	
$D = 1^{\circ} 30' 28.0''$	
$L = 1,964.69'$	
$T = 1,004.83'$	
$R = 3,800.00'$	
SE 0.05	
DS = 65 MPH	

ALL WATERLINES ARE OWNED BY SALISBURY / ROWAN UTILITIES DEPARTMENT

CONNECT USING NECESSARY FITTINGS

PROP. (1) - RELOCATE EXIST. WATER METER WITH BACKFLOW PREVENTER
 PROP. 85' 3/4" COPPER WATER PIPE, TYPE K

PROP. (5) - RELOCATE EXIST. WATER METERS WITH BACKFLOW PREVENTERS
 PROP. 20' 3/4" COPPER WATER PIPE, TYPE K

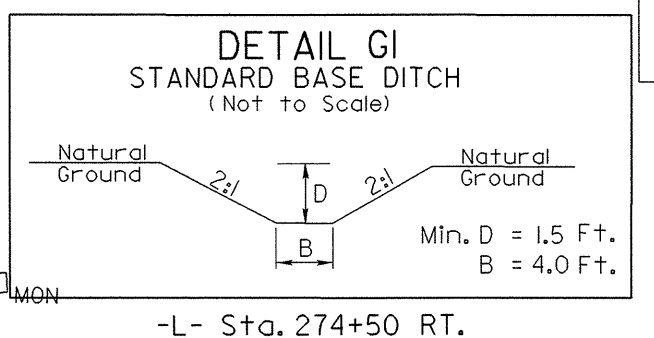
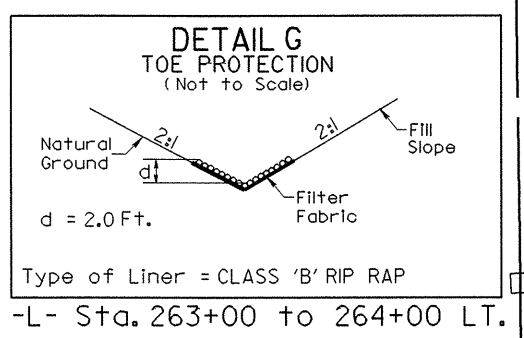
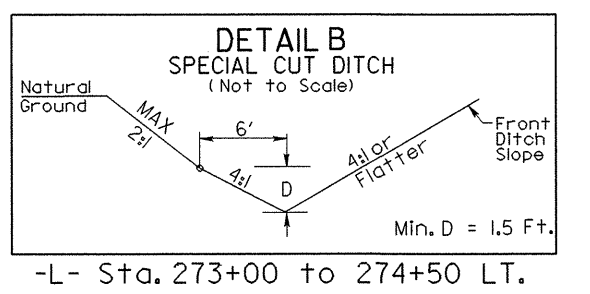
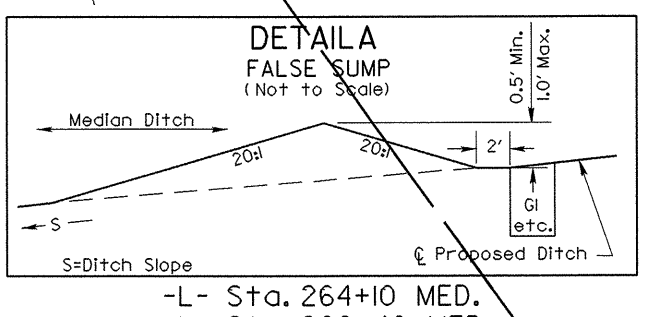

PAVEMENT REMOVAL

Note: See Sheet 22 for -L- line profile
 See Sheet 32 for -Y9- line profile
 See Sheet 2E for driveways

8/17/09
 21-SEP-2004 14:24
 R:\Utilities\Reloc\2911d\ut.uc11_rdy\09.dgn
 vm\2911d\ut.uc11_rdy\09.dgn