

8/17/99

PROJECT REFERENCE NO.	SHEET NO.
R-2911D	UC-13
DESIGNED BY: VM	
DRAWN BY: VM	
CHECKED BY: RBW	
APPROVED BY: RBW	
REVISED:	NORTH CAROLINA DEPARTMENT OF TRANSPORTATION
DESIGN SERVICES UNIT PHONE: (919) 250-4128 FAX: (919) 250-4119	
UTILITY CONSTRUCTION PLANS ONLY	

# UTILITY CONSTRUCTION

-L-	
PI Sta 328+76.15	Pls Sta 331+27.18
$\Delta = 9^{\circ} 52' 31.8" (LT)$	$\Theta_s = 2^{\circ} 01' 30.0"$
$D = 2^{\circ} 30' 00.0"$	$L_s = 162.00'$
$L = 395.02'$	$LT = 108.01'$
$T = 198.00'$	$ST = 54.01'$
$R = 2,291.83'$	
$SE = 0.06$	
$DS = 60 \text{ MPH}$	

ALL WATERLINES ARE OWNED BY SALISBURY / ROWAN UTILITIES DEPARTMENT

CONNECT USING NECESSARY FITTINGS

ALL SEWERLINES ARE OWNED BY ROWAN - SALISBURY BOARD OF EDUCATION

Match Line -L- Sta. 328 + 00.00

Match Line -L- Sta. 341 + 00.00

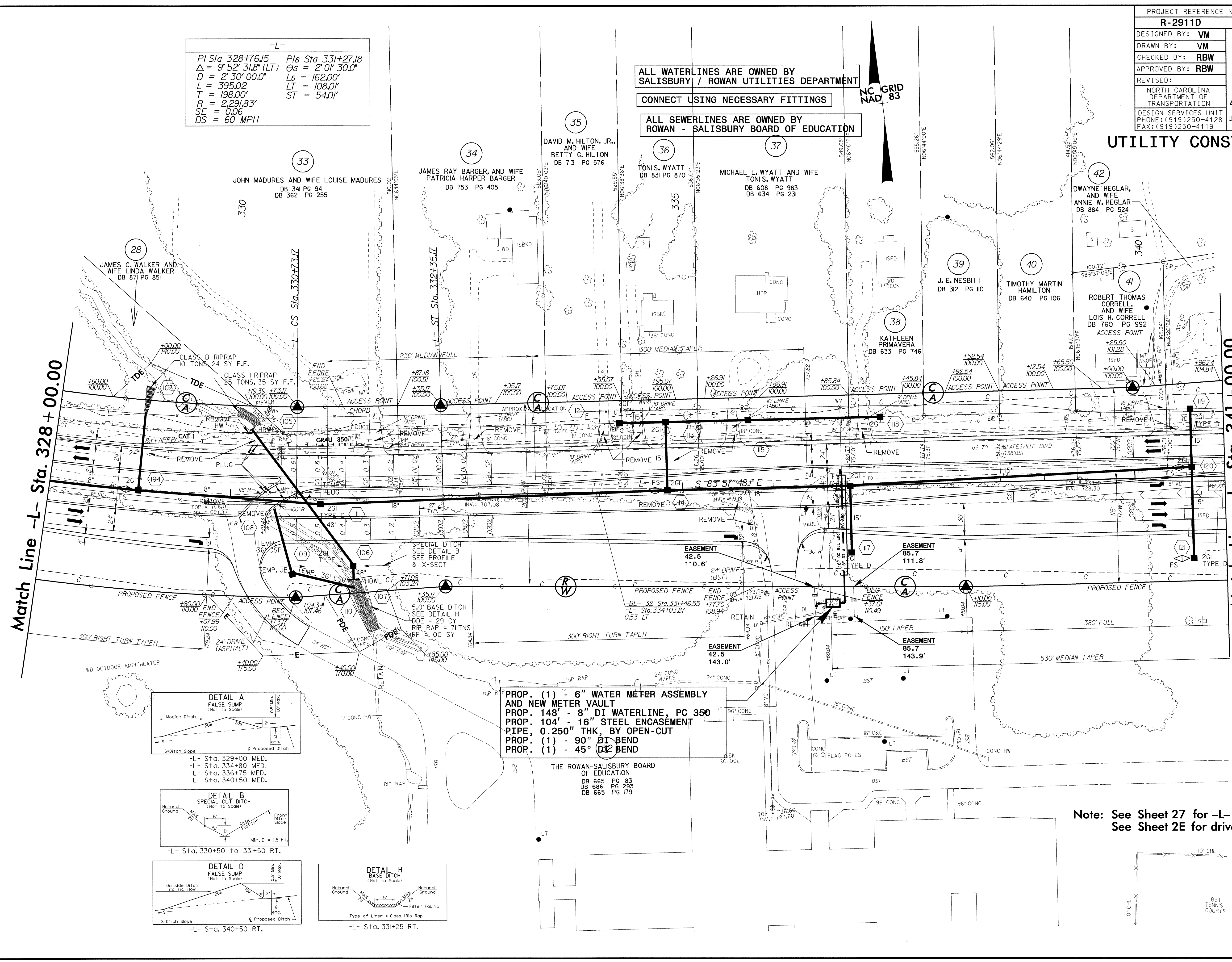

- PROP. (1) - 6" WATER METER ASSEMBLY AND NEW METER VAULT
- PROP. 148' - 8" DI WATERLINE, PC 350
- PROP. 104' - 16" STEEL ENCASEMENT PIPE, 0.250" THK, BY OPEN-CUT
- PROP. (1) - 90° BT BEND
- PROP. (1) - 45° BT BEND

THE ROWAN-SALISBURY BOARD OF EDUCATION  
 DB 665 PG 183  
 DB 686 PG 293  
 DB 665 PG 179

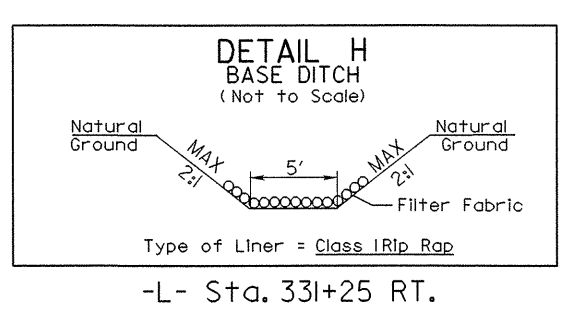
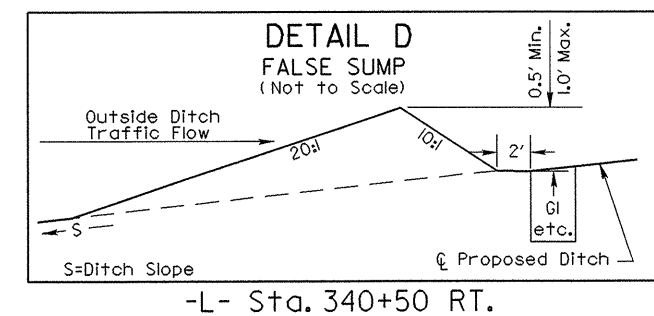
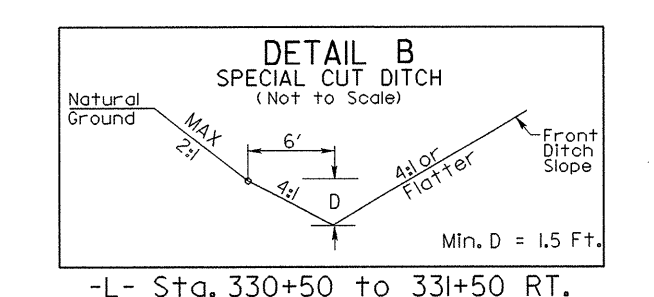
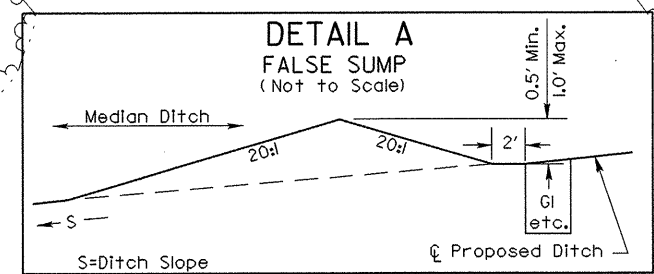

Note: See Sheet 27 for -L- line profile  
See Sheet 2E for driveway

23-SEP-2004 13:51 U:\P\o\Utility Constr. vm\2911d\ut.ut.uc13\_r\dys14.dgn