

UTILITIES BY OTHERS

NOTE:
ALL PROPOSED UTILITY WORK
SHOWN ON THIS SHEET WILL
BE DONE BY OTHERS

8/17/99
23-SEP-2004 09:28
R:\Utilities\Files\U0\Proj\Utilities\Others\vr2911d.ut.uo9_r.dys13.dgn
41 10212416

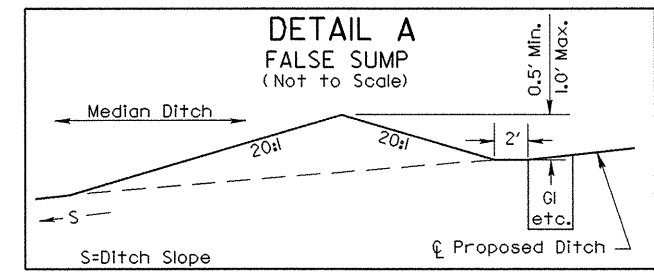
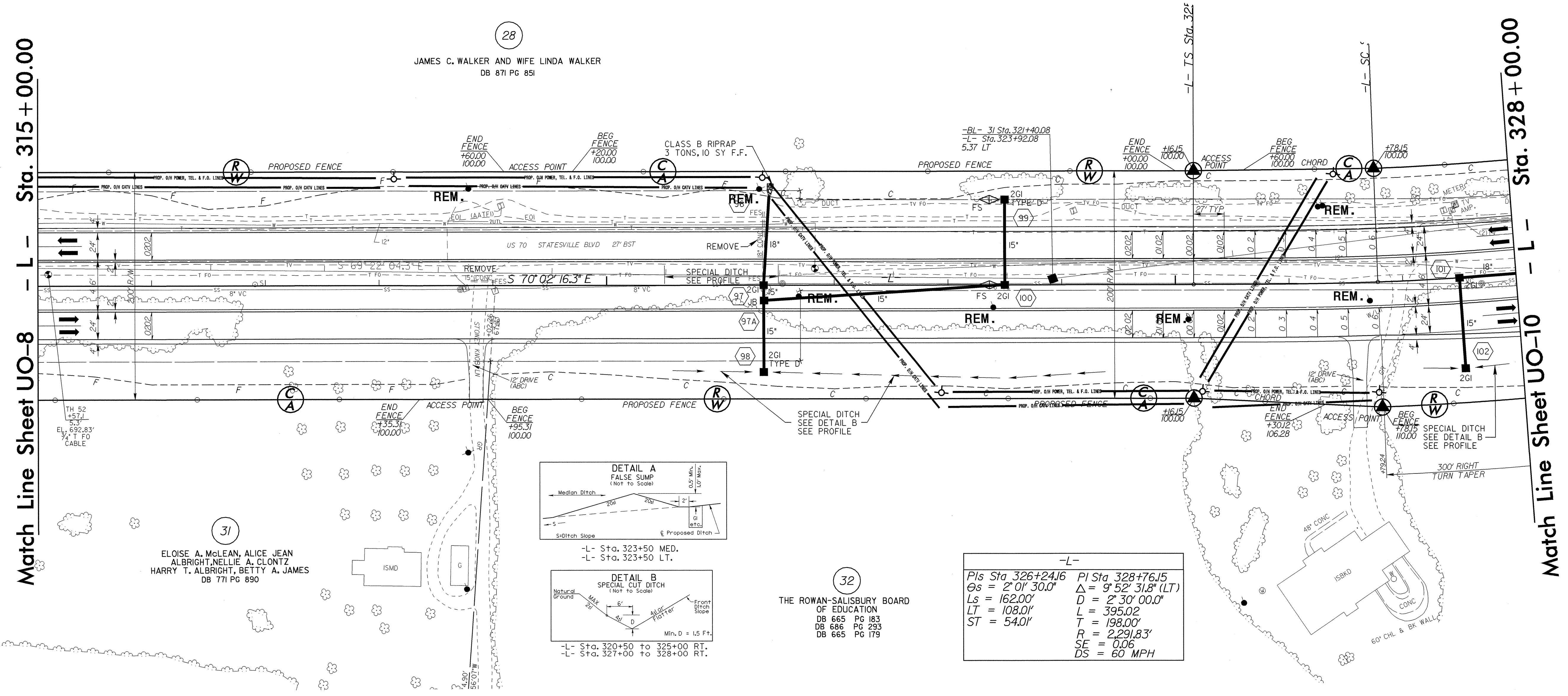

-L- Sta. 323+50 MED.
-L- Sta. 323+50 LT.

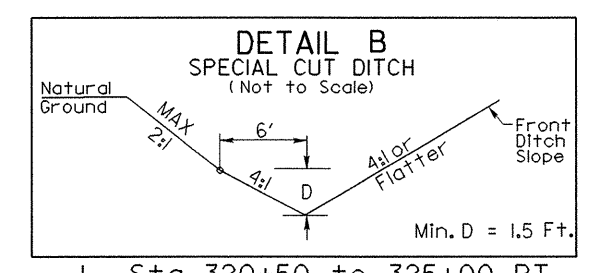

-L- Sta. 320+50 to 325+00 RT.
-L- Sta. 327+00 to 328+00 RT.

-L-

PIs Sta 326+24.16	PI Sta 328+76.15
$\Theta s = 2^{\circ} 01' 30.0''$	$\Delta = 9^{\circ} 52' 31.8''$ (LT)
$Ls = 162.00'$	$D = 2^{\circ} 30' 00.0''$
$LT = 108.01'$	$L = 395.02'$
$ST = 54.01'$	$T = 198.00'$
	$R = 2,291.83'$
	$SE = 0.06$
	$DS = 60$ MPH

32
THE ROWAN-SALISBURY BOARD
OF EDUCATION
DB 665 PG 183
DB 686 PG 293
DB 665 PG 179

31
ELOISE A. McLEAN, ALICE JEAN
ALBRIGHT, NELLIE A. CLONTZ
HARRY T. ALBRIGHT, BETTY A. JAMES
DB 771 PG 890

28
JAMES C. WALKER AND WIFE LINDA WALKER
DB 871 PG 851

NC GRID
MAD 83

Match Line Sheet UO-8 - L - Sta. 315+00.00

Match Line Sheet UO-10 - L - Sta. 328+00.00