

5/28/99

DITCH LEGEND
RIGHT DITCH - - - - -

PROJECT REFERENCE NO. R-2911D	SHEET NO. 27
ROADWAY DESIGN ENGINEER NORTH CAROLINA PROFESSIONAL SEAL DAVID W. BASS 10/4/04	HYDRAULICS ENGINEER NORTH CAROLINA PROFESSIONAL SEAL 18462 JAMES K. HAYES 10/6/04
PBSJ POST, BUCKLEY, SCHUH & JERNIGAN, INC. 1616 EAST MILLBROOK ROAD, SUITE 310 RALEIGH, NORTH CAROLINA 27609	

PIPE HYDRAULIC DATA
DRAINAGE STRUCTURE NO. 105

DRAINAGE AREA	= 28 AC
DESIGN FREQUENCY	= 50 YRS
DESIGN DISCHARGE	= 95 CFS
DESIGN HW ELEVATION	= 702.0 FT
100 YEAR DISCHARGE	= 110 CFS
100 YEAR HW ELEVATION	= 702.6 FT
OVERTOPPING FREQUENCY	= 500 YRS
OVERTOPPING DISCHARGE	= 190 CFS
OVERTOPPING ELEVATION	= 706.9 FT

PI = 344+25.00
 EL = 756.22'
 VC = 1,430'
 K = 151
 DS = 60 MPH
 (+)3.4891%

PI = 330+00.00
 EL = 706.50'
 VC = 530'
 K = 137
 DS = 60 MPH

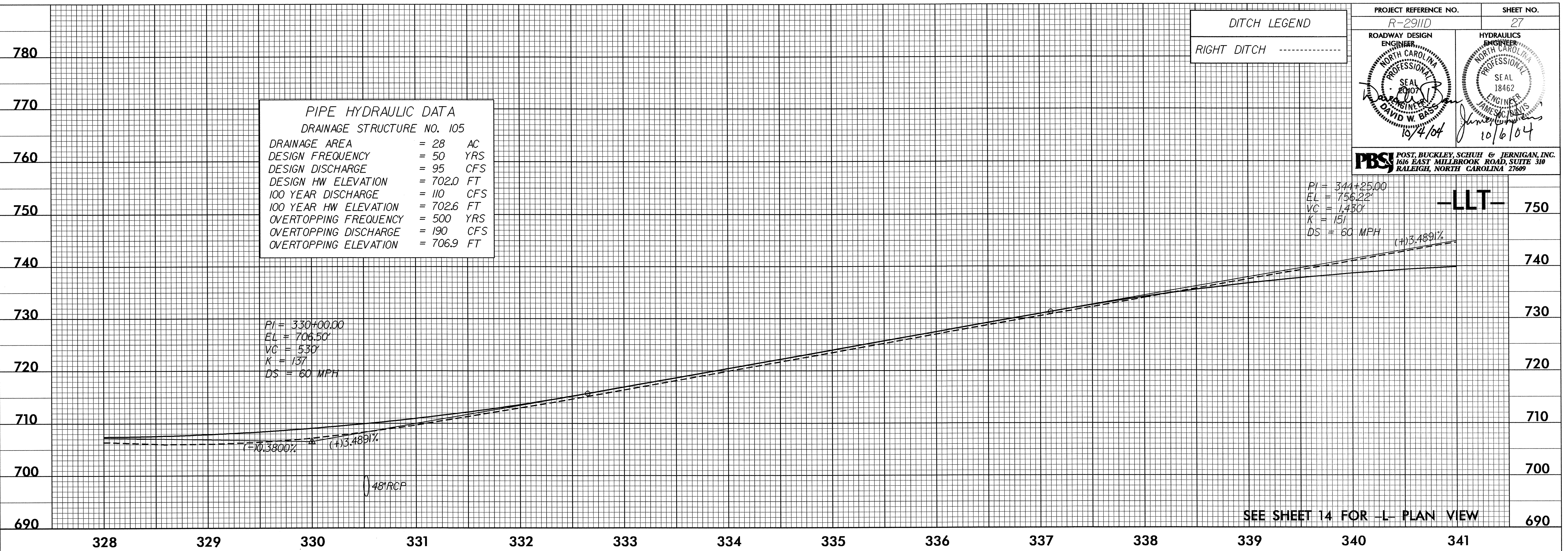

SEE SHEET 14 FOR -L- PLAN VIEW

-LRT-

PI = 344+25.00
 EL = 756.22'
 VC = 1,430'
 K = 152
 DS = 60 MPH

PI = 330+00.00
 EL = 706.70'
 VC = 540'
 K = 137
 DS = 60 MPH

BEGIN SPECIAL DITCH RT.
 STA 330+50.000
 EL = 707.68
 STA 331+35.000
 EL = 707.42
 END SPECIAL DITCH RT.
 STA 331+50.000
 EL = 709.25

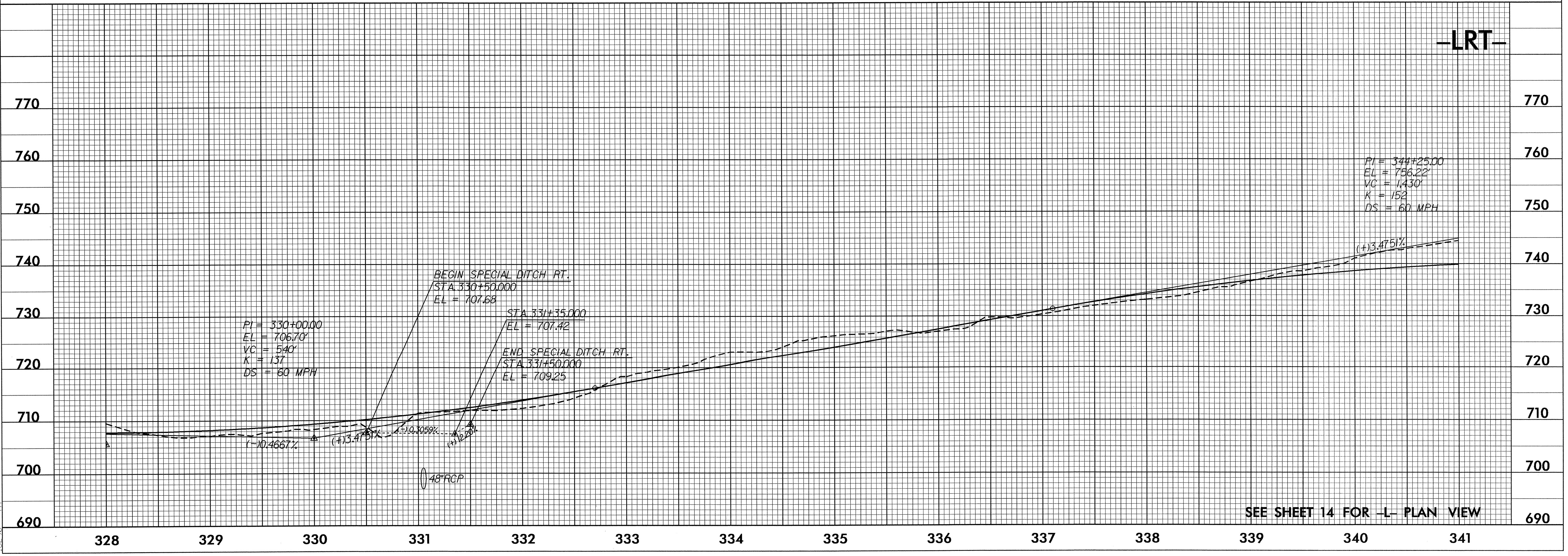

SEE SHEET 14 FOR -L- PLAN VIEW

04-OCT-2004 18:49
R:\Roadway\Proj\2911d_rdy_of_1.psh.dgn
16230