

TIP NO. R-2911D	SHEET NO. SIGN-10
--------------------	----------------------

9/22/04
 NORTH CAROLINA
 PROFESSIONAL
 SEAL
 028387
 ENGINEER
 W. L. BRADSHAW

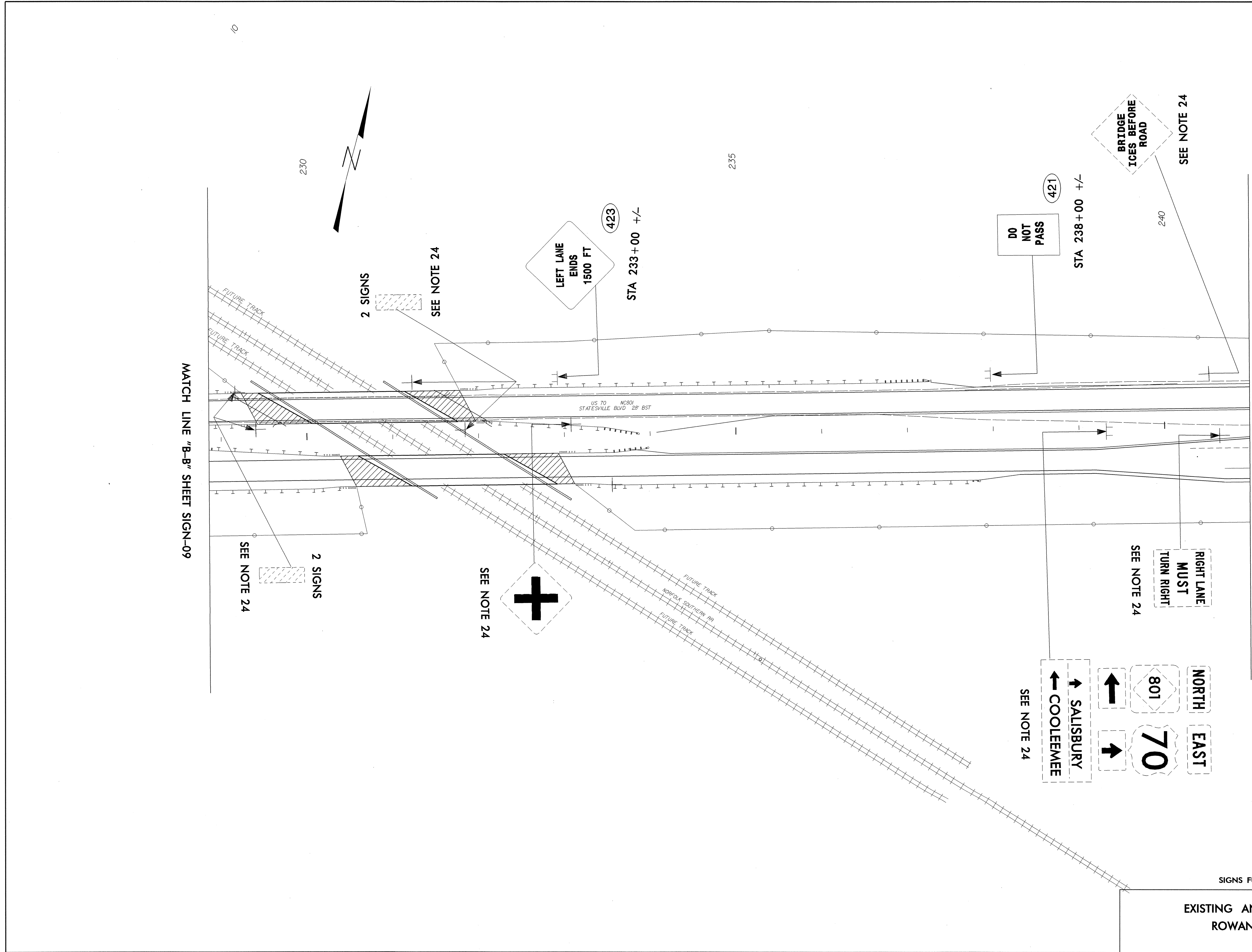

MATCH LINE "B-B" SHEET SIGN-09

MATCH LINE "C-C" SHEET SIGN-11

SIGNS FURNISHED BY STATE

EXISTING AND PROPOSED SIGNS
 ROWAN COUNTY US 70