

PROJECT REFERENCE NO.		SHEET NO.	
R-2911D		EC-19/CONST.17	
RW SHEET NO.			
ROADWAY DESIGN ENGINEER		HYDRAULICS ENGINEER	

-L-	
PI Sta 363+48.44	PI Sta 376+13.26
$\Delta = 5^{\circ} 10' 02.1''$ (LT)	$\Delta = 7^{\circ} 27' 56.5''$ (RT)
$D = 0^{\circ} 29' 58.8''$	$D = 0^{\circ} 29' 58.8''$
$L = 1,034.12'$	$L = 1,494.10'$
$T = 517.41'$	$T = 748.11'$
$R = 11,466.51'$	$R = 11,466.53'$
$SE = 0.02$	$SE = 0.02$
$S = 70$ MPH+	$S = 70$ MPH+

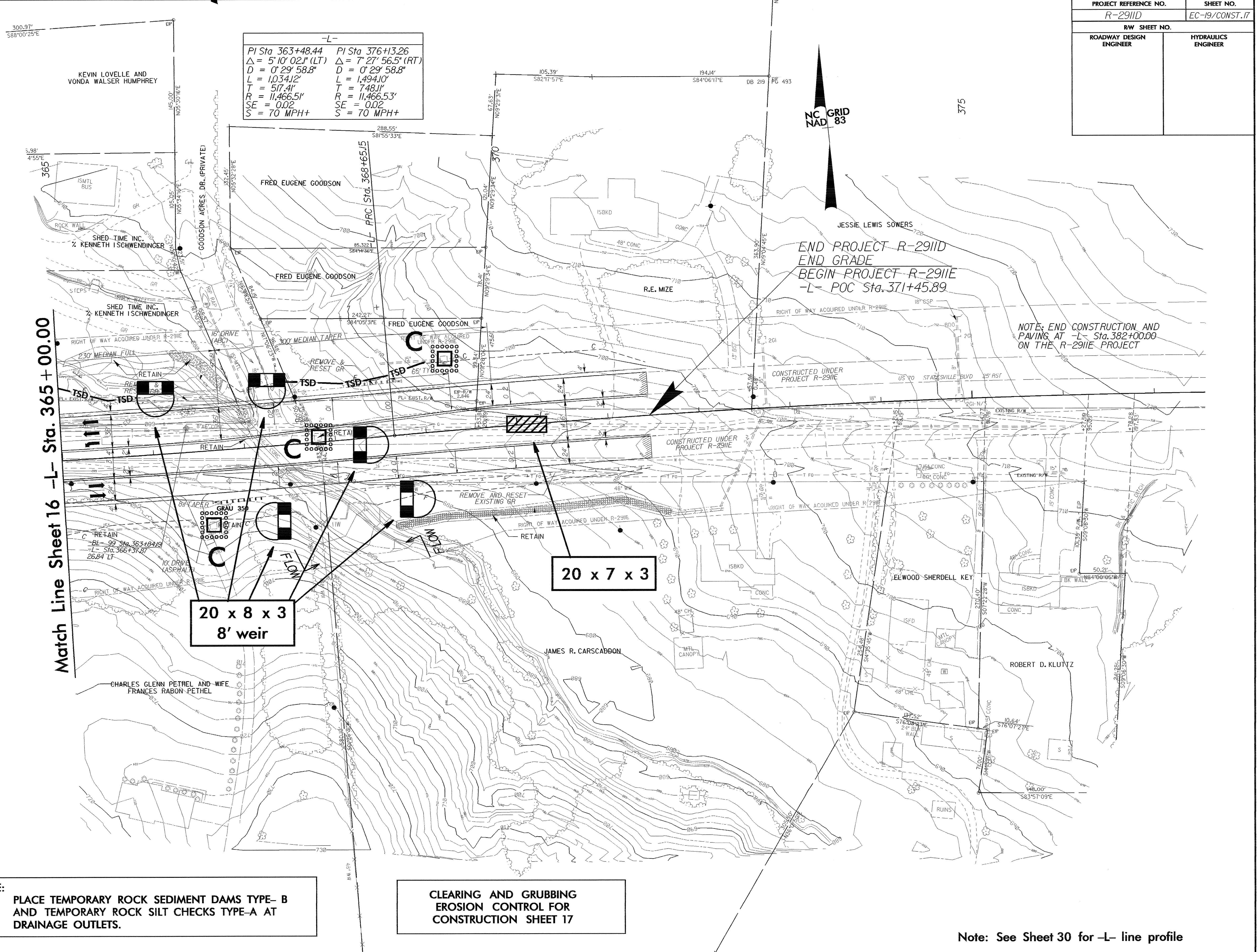
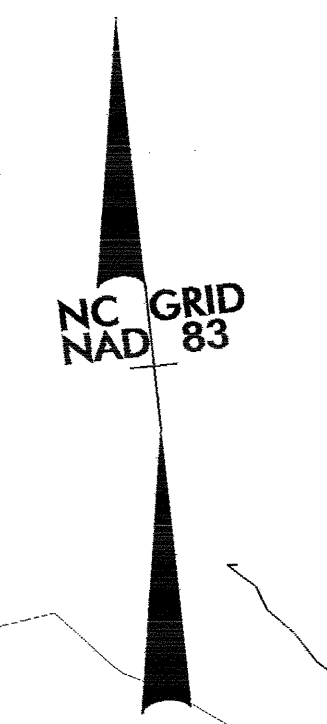

NOTE:
PLACE TEMPORARY ROCK SEDIMENT DAMS TYPE- B AND TEMPORARY ROCK SILT CHECKS TYPE-A AT DRAINAGE OUTLETS.

CLEARING AND GRUBBING EROSION CONTROL FOR CONSTRUCTION SHEET 17

Note: See Sheet 30 for -L- line profile