

PROJECT REFERENCE NO.	SHEET NO.
R-2911D	EC-26/CONST.9
RW SHEET NO.	
ROADWAY DESIGN ENGINEER	HYDRAULICS ENGINEER

-Y9-	
PI Sta 15+96.87	PI Sta 18+87.21
$\Delta = 0^{\circ} 56' 35.3"$ (RT)	$\Delta = 70^{\circ} 39' 37.6"$ (RT)
D = 1'00' 00.0"	D = 35' 00' 00.0"
L = 94.31'	L = 201.89'
T = 47.16'	T = 116.04'
R = 5,729.58'	R = 163.70'
SE = NC	SE = 0.03
DS = 40 MPH	DS = <20 MPH

NC GRID NAD 83

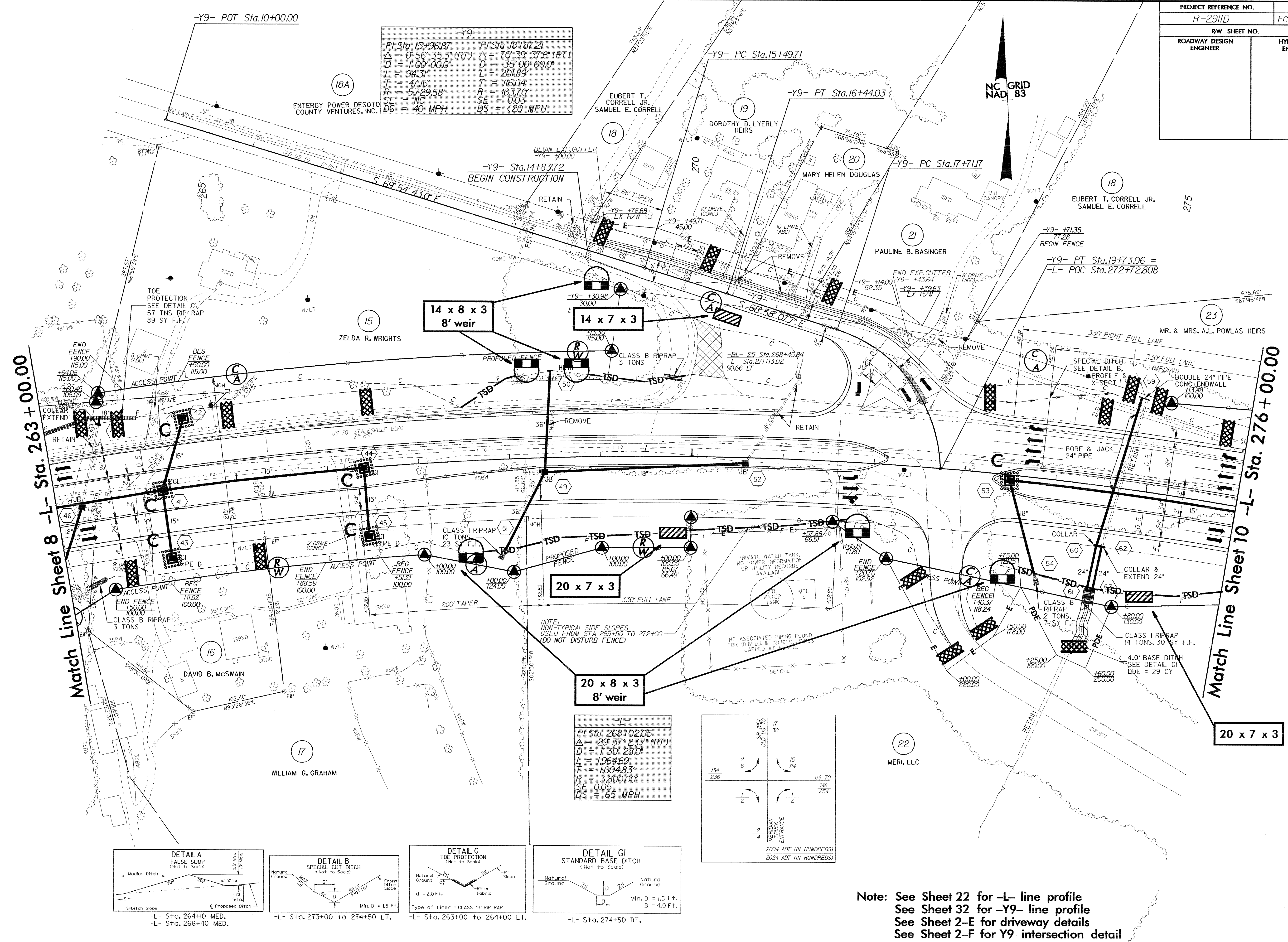

NOTE:  
NON-TYPICAL SIDE SLOPES  
USED FROM STA 269+50 TO 272+00  
(DO NOT DISTURB FENCE)

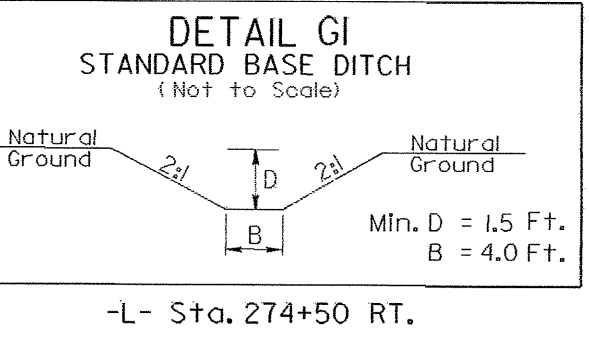
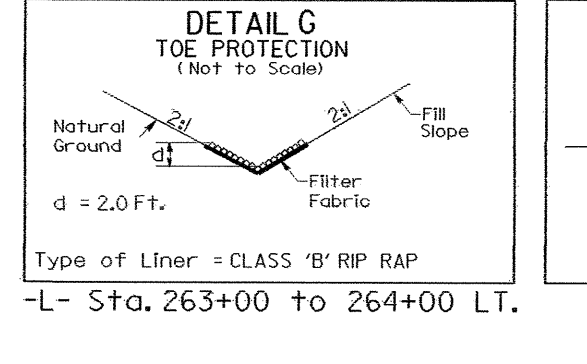
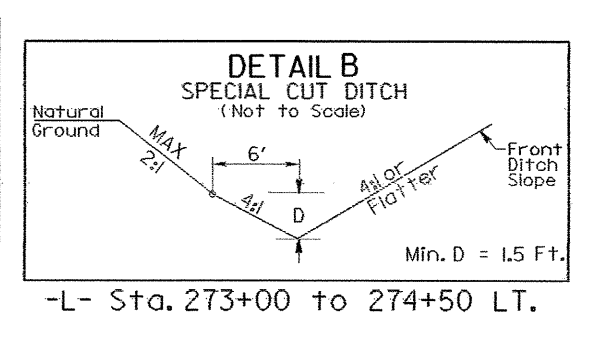
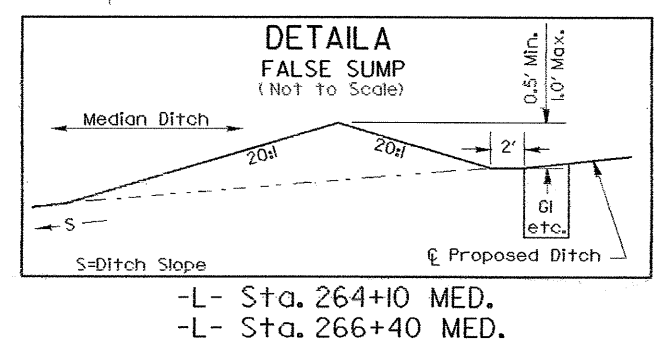
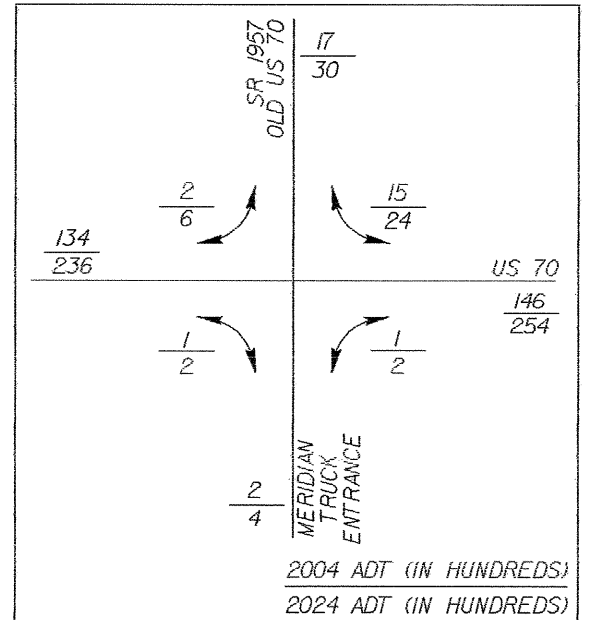

Note: See Sheet 22 for -L- line profile  
See Sheet 32 for -Y9- line profile  
See Sheet 2-E for driveway details  
See Sheet 2-F for Y9 intersection detail