

PROJECT REFERENCE NO.	SHEET NO.
R-2911D	EC-34/CONST.16
RW SHEET NO.	
ROADWAY DESIGN ENGINEER	HYDRAULICS ENGINEER

**20 x 8 x 3  
8' weir**

**20 x 8 x 3  
8' weir**

**20 x 8 x 3  
8' weir**

**20 x 8 x 3  
8' weir**

Match Line Sheet 15 -L- Sta. 353+00.00

Match Line Sheet 17 -L- Sta. 365+00.00

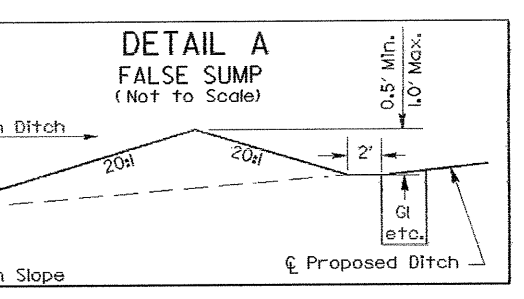
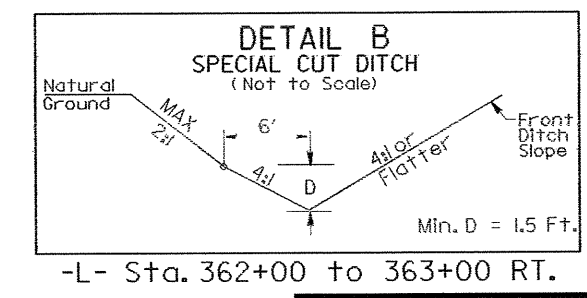
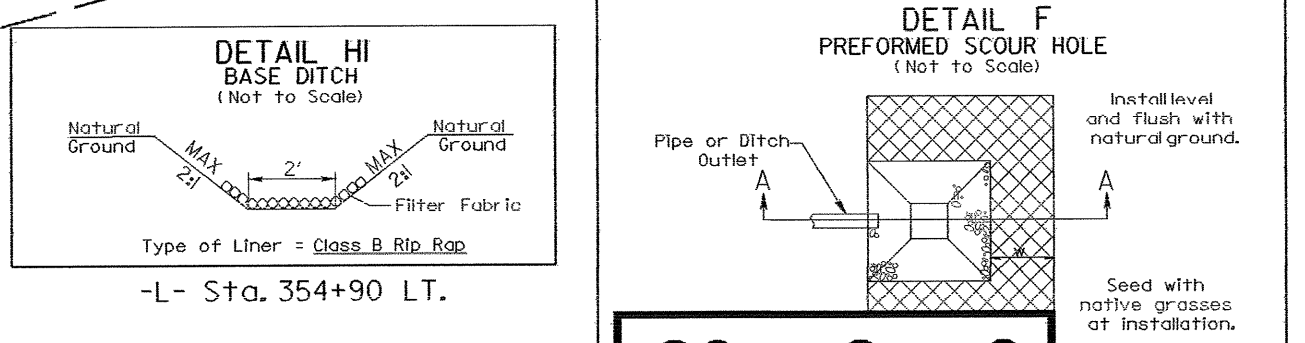
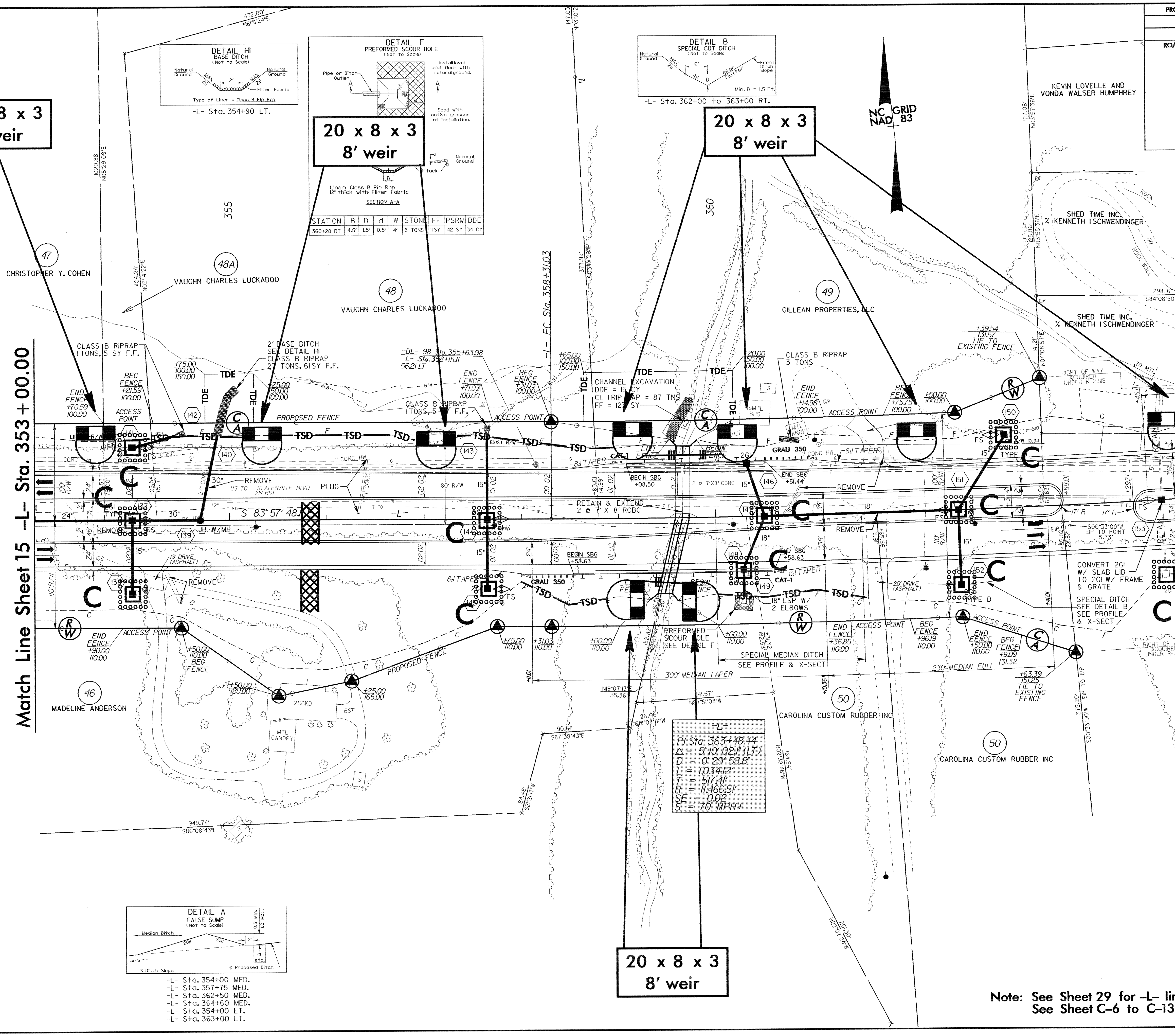

STATION	B	D	d	W	STONS	FF	PSRM	DDE
360+28 RT	4.5'	1.5'	0.5'	4'	5 TONS	12 SY	42 SY	34 CY

-L-  
PI Sta. 363+48.44  
Δ = 5'10" 02' (LT)  
D = 0'29" 58.8"  
L = 1034.12'  
T = 517.41'  
R = 11,466.51'  
SE = 0.02  
S = 70 MPH+

-L- Sta. 354+00 MED.  
-L- Sta. 357+75 MED.  
-L- Sta. 362+50 MED.  
-L- Sta. 364+60 MED.  
-L- Sta. 354+00 LT.  
-L- Sta. 363+00 LT.

Note: See Sheet 29 for -L- line profile  
See Sheet C-6 to C-13 for Culvert Plans