

PROJECT REFERENCE NO.	SHEET NO.
R-2911C	UC-4
DESIGNED BY: JH	
DRAWN BY: JH	
CHECKED BY: CDB	
APPROVED BY: CDB	
REVISED:	
NORTH CAROLINA DEPARTMENT OF TRANSPORTATION	
DESIGN SERVICES UNIT PHONE: (919) 250-4128 FAX: (919) 250-4119	
UTILITY CONSTRUCTION PLANS ONLY	

UTILITY CONSTRUCTION

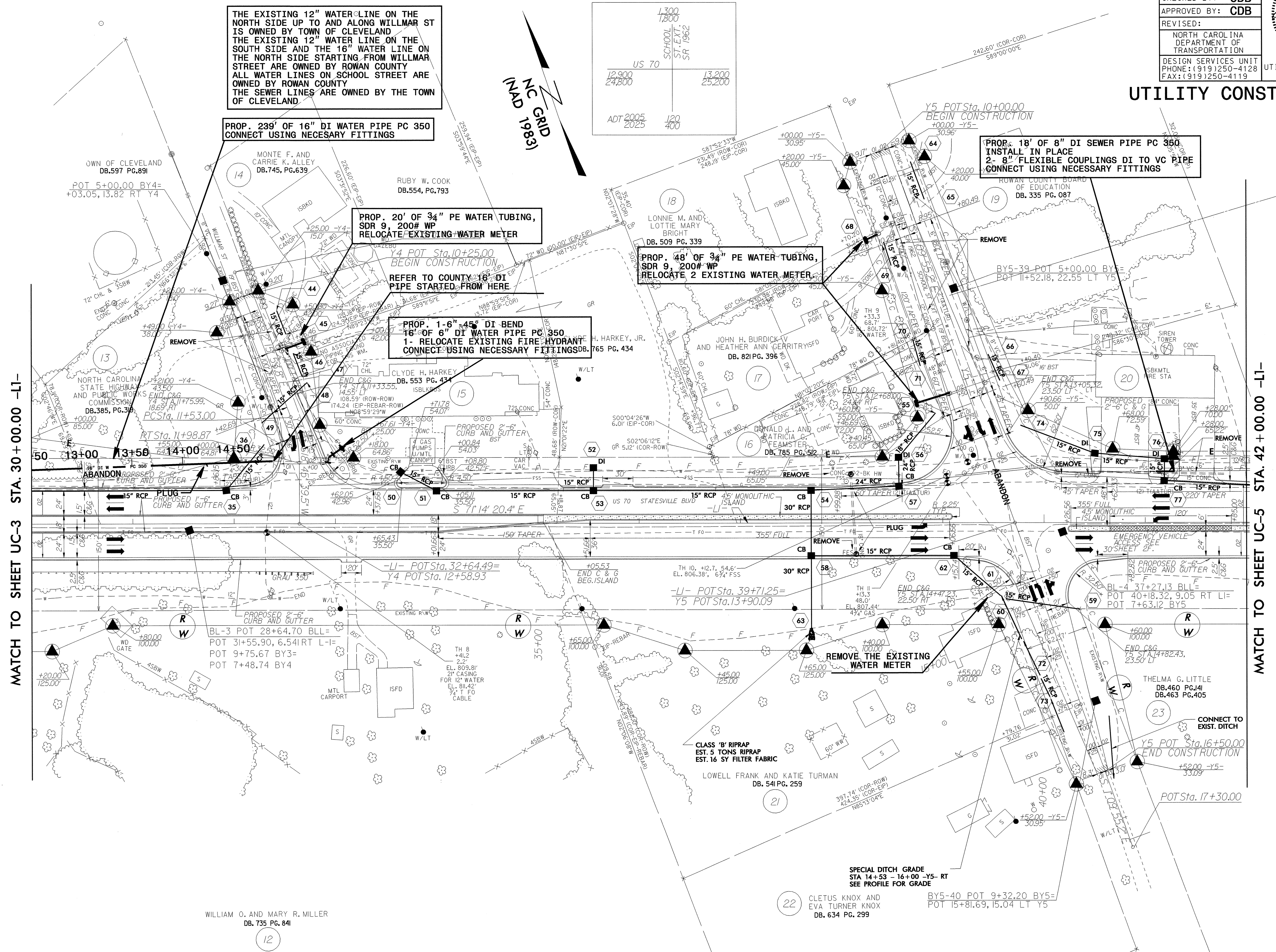

MATCH TO SHEET UC-3 STA. 30+00.00 -LI-

MATCH TO SHEET UC-5 STA. 42+00.00 -LI-

THE EXISTING 12" WATER LINE ON THE NORTH SIDE UP TO AND ALONG WILLMAR ST IS OWNED BY TOWN OF CLEVELAND THE EXISTING 12" WATER LINE ON THE SOUTH SIDE AND THE 16" WATER LINE ON THE NORTH SIDE STARTING FROM WILLMAR STREET ARE OWNED BY ROWAN COUNTY ALL WATER LINES ON SCHOOL STREET ARE OWNED BY ROWAN COUNTY THE SEWER LINES ARE OWNED BY THE TOWN OF CLEVELAND

PROP. 239' OF 16" DI WATER PIPE PC 350 CONNECT USING NECESSARY FITTINGS

PROP. 20' OF 3/4" PE WATER TUBING, SDR 9, 200# WP RELOCATE EXISTING WATER METER

REFER TO COUNTY 16" DI PIPE STARTED FROM HERE

PROP. 1-6" 45" DI BEND 16" OF 6" DI WATER PIPE PC 350 1- RELOCATE EXISTING FIRE HYDRANT CONNECT USING NECESSARY FITTINGS

PROP. 48' OF 3/4" PE WATER TUBING, SDR 9, 200# WP RELOCATE 2 EXISTING WATER METER

PROP. 18' OF 8" DI SEWER PIPE PC 350. INSTALL IN PLACE 2- 8" FLEXIBLE COUPLINGS DI TO VC PIPE CONNECT USING NECESSARY FITTINGS

REMOVE THE EXISTING WATER METER

SPECIAL DITCH GRADE STA 14+53 - 16+00 -Y5- RT SEE PROFILE FOR GRADE

CLEVELAND CO VOLUNTEER DEPARTMENT DB. 762 PG. DB. 544 PG

20