

5/28/99

BM 11  
CHISELED CROSS ON WESTERN END  
OF 12" RCP UNDER WILMAR STREET  
-L- STA. 31+13.20, 428.68' LT. =  
BL STA. 28+29.00, 435.90' LT. =  
EL. 818.05

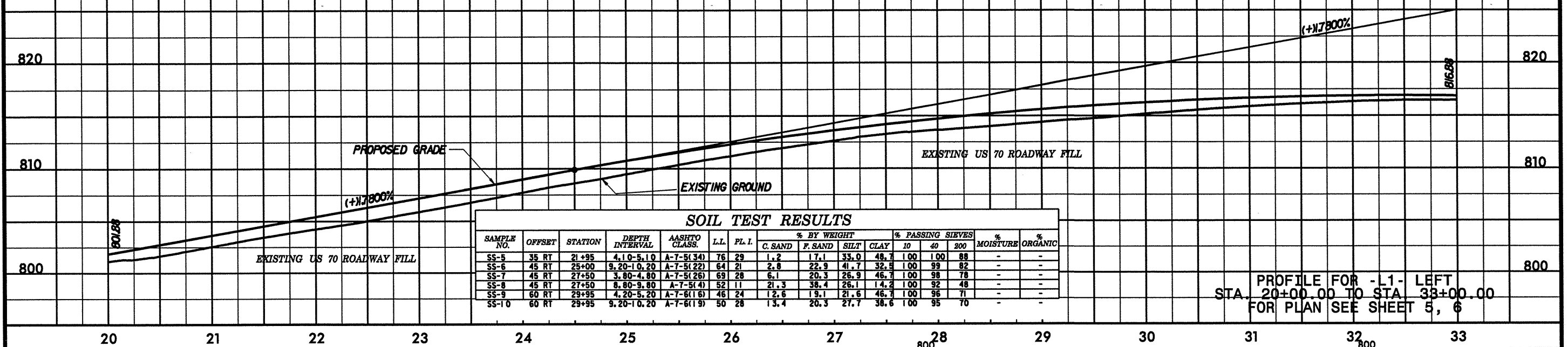

**SOIL TEST RESULTS**

SAMPLE NO.	OFFSET	STATION	DEPTH INTERVAL	AASHTO CLASS.	L.L.	P.L.I.	% BY WEIGHT				% PASSING SIEVES			% MOISTURE	% ORGANIC
							C. SAND	F. SAND	SILT	CLAY	10	40	200		
SS-5	35 RT	21+95	4.10-5.10	A-7-5(34)	76	29	1.2	17.1	33.0	48.7	100	100	88	-	-
SS-6	45 RT	25+00	9.20-10.20	A-7-5(22)	64	21	2.8	22.9	41.7	32.5	100	99	82	-	-
SS-7	45 RT	27+50	3.80-4.80	A-7-5(26)	69	28	6.1	20.3	26.9	46.7	100	98	78	-	-
SS-8	45 RT	27+50	8.80-9.80	A-7-5(4)	52	11	21.3	38.4	26.1	14.2	100	92	48	-	-
SS-9	60 RT	29+95	4.20-5.20	A-7-6(16)	46	24	12.6	19.1	21.6	46.7	100	96	71	-	-
SS-10	60 RT	29+95	9.20-10.20	A-7-6(19)	50	28	13.4	20.3	27.7	38.6	100	95	70	-	-

PROFILE FOR -L1- LEFT  
STA. 20+00.00 TO STA. 33+00.00  
FOR PLAN SEE SHEET 5, 6

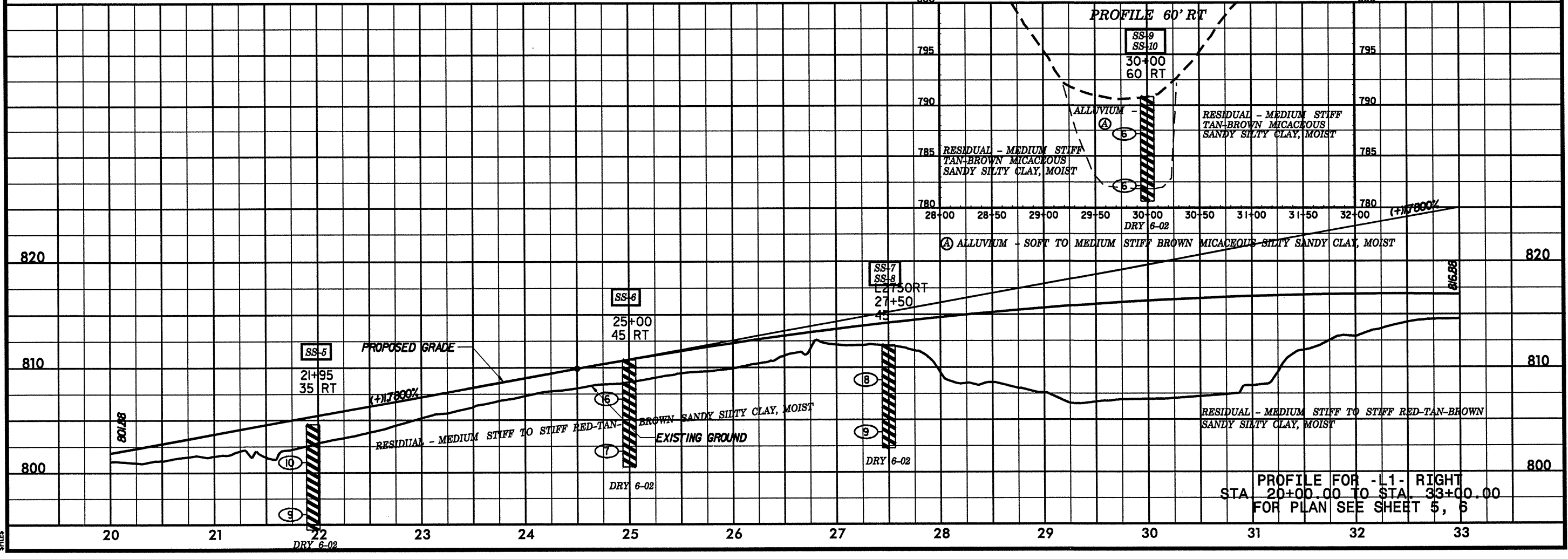

PROFILE FOR -L1- RIGHT  
STA. 20+00.00 TO STA. 33+00.00  
FOR PLAN SEE SHEET 5, 6

DATE: 5/28/99  
TIME: 11:00 AM  
FILES: