

BM 2
 RR SPIKE IN ROOT OF 12" OAK
 -L- STA. 64+48.05, 536.98 LT. =
 BL STA. 61+60.26, 542.04 LT. =
 EL. 774.09

POT STA 70+89.80 -12- LA-
 POT STA 70+89.80 -11- LB-
 ELEV. 757.34

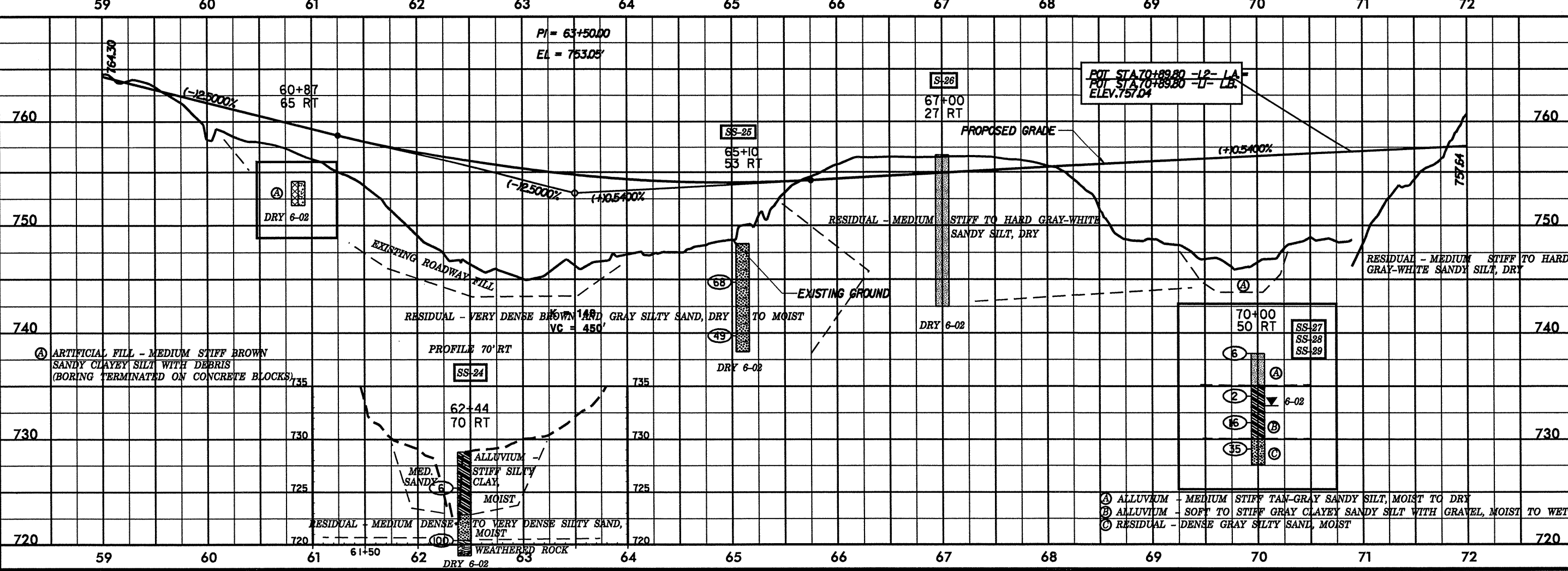
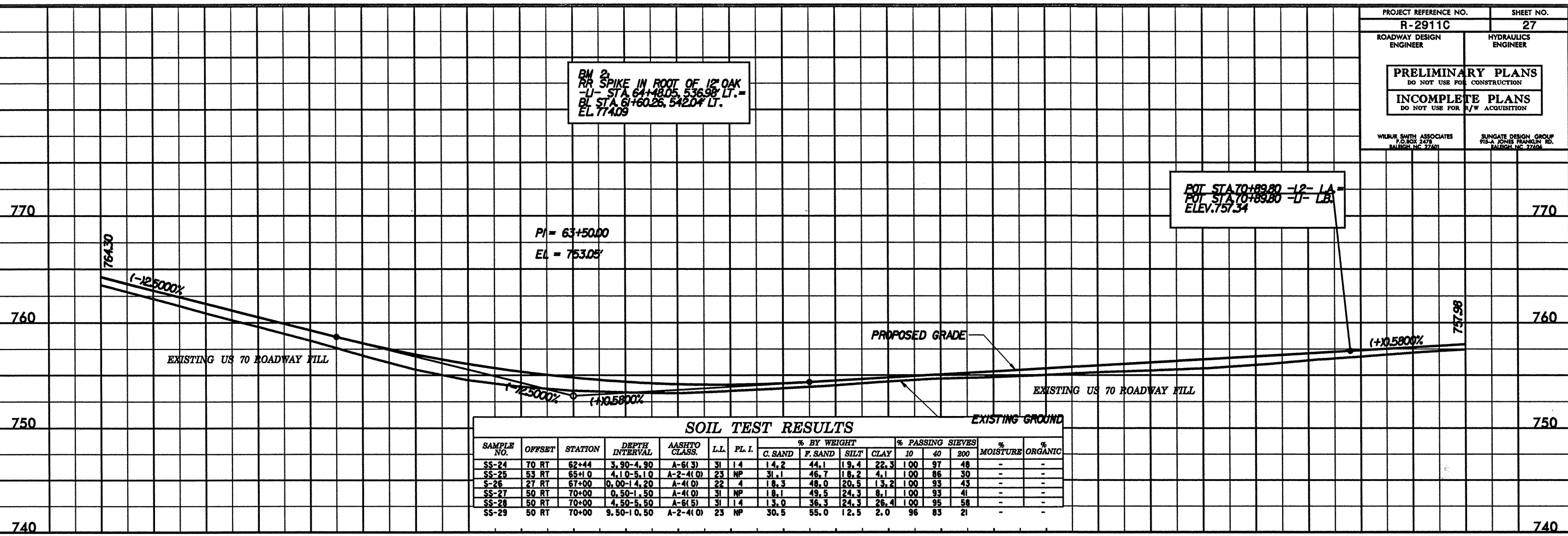

(A) ARTIFICIAL FILL - MEDIUM STIFF BROWN SANDY CLAYEY SILT WITH DEBRIS (BORING TERMINATED ON CONCRETE BLOCKS)

(A) ALLUVIUM - MEDIUM STIFF TAN-GRAY SANDY SILT, MOIST TO DRY
 (B) ALLUVIUM - SOFT TO STIFF GRAY CLAYEY SANDY SILT WITH GRAVEL, MOIST TO WET
 (C) RESIDUAL - DENSE GRAY SILTY SAND, MOIST

DATE: 5/28/99 TIME: 11:00 AM