

BM 6  
 RR SPIKE IN BASE OF 2" OAK  
 -L2- STA. 203+55.92, 318.34 LT. =  
 EL. 719.23  
 BL STA. 200+47.46, 296.76 LT.

BM E-186  
 USGS MONUMENT E-186  
 -L2- STA. 212+50.29, 1500.07 LT. =  
 EL. 743.80  
 BL STA. 209+29.41, 1465.73 LT.

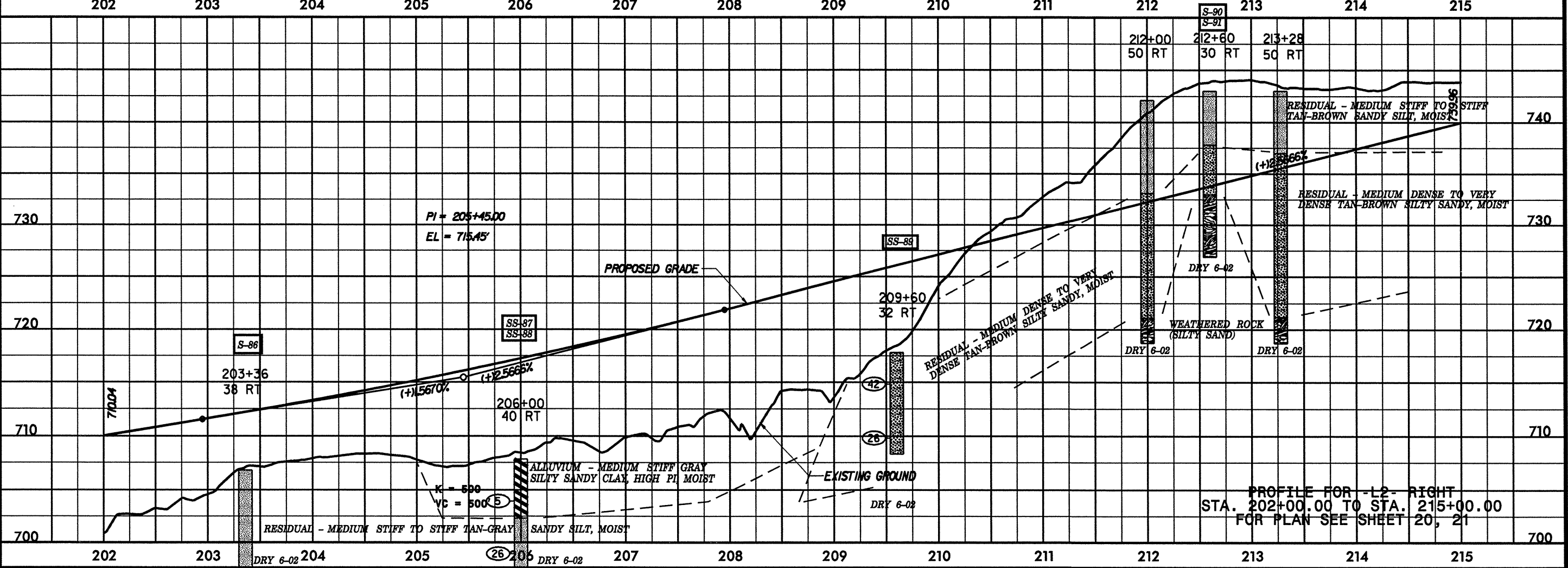
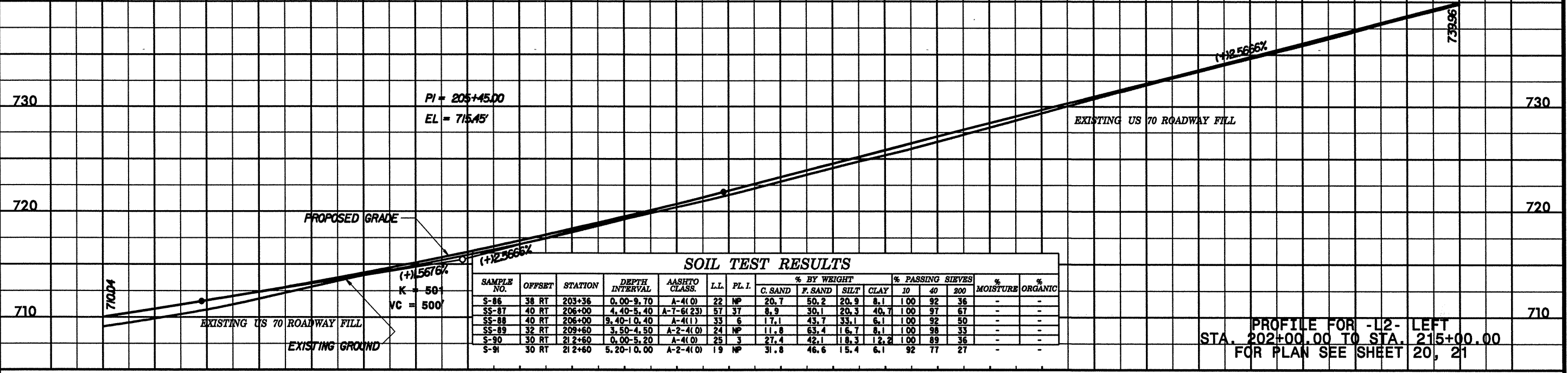

DATE: 5/28/99 TIME: 5:00 PM