

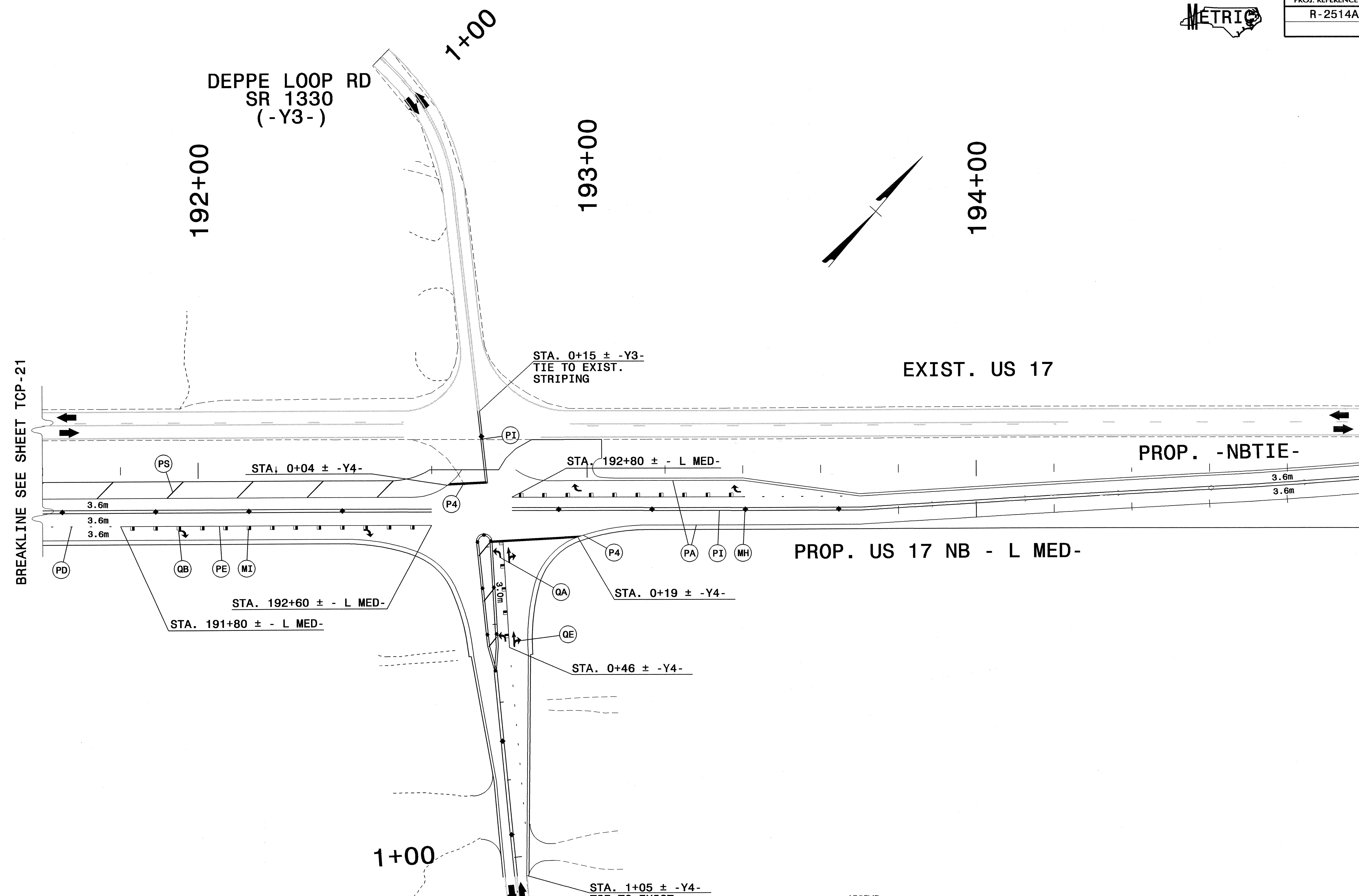

PROJ. REFERENCE NO. R-2514A	SHEET NO. TCP-22
--------------------------------	---------------------



BREAKLINE SEE SHEET TCP-21

MATCH LINE
STA. 195+00 ± -L MED-
SEE SHEET TCP-23

LEGEND

	REMOVAL OF EXISTING PAVEMENT
	PROPOSED CONSTRUCTION
	TEMPORARY PAVEMENT
	WEDGING & WIDENING

APPROVED:	DATE:	PHASE I TEMPORARY PAVEMENT MARKINGS AND MARKERS				
SCALE: NONE	DATE: 11/18/03	<table border="1"> <thead> <tr> <th>REVISIONS</th> </tr> </thead> <tbody> <tr><td> </td></tr> <tr><td> </td></tr> <tr><td> </td></tr> </tbody> </table>	REVISIONS			
REVISIONS						
DWG. BY: KWD	DESIGN BY: KWD					
REVIEWED BY: JHJ						

I:\NOV-2003\9:21
 0:\CAD\7054\H00\N-2514A\TrafficControl\TCP\R-2514A-TC-TCP22.dgn
 williams A.L. WILLIAMS