

ROADWAY DESIGN BY:
TAYLOR • WISEMAN & TAYLOR
 ENGINEERS • SURVEYORS • PLANNERS
 G.P.S. • SUBSURFACE UTILITY ENGINEERING
 3500 REGENCY PARKWAY, SUITE H, CARY, N.C. 27511
 TELEPHONE NO. (919)297-0085 FAX NO. (919)297-0090

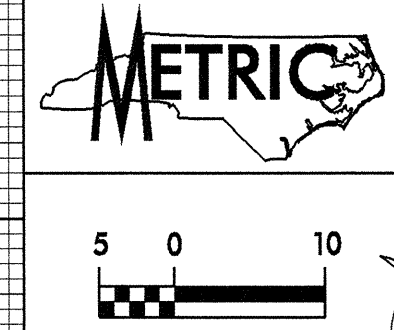

| | |
|---|--|
| PROJECT REFERENCE NO. R-2514A | SHEET NO. 44 |
| ROADWAY DESIGN ENGINEER JAMES H. JATKO | HYDRAULICS ENGINEER RAY D. LOVINGGOOD |
| Professional Engineer Seal 022950 10/03 | Professional Engineer Seal 19775 13 Dec 03 |

CONST. REV.
 R / W REV.

HYDRAULIC DESIGN :
TS&S SYSTEMS CORPORATION
 4917 Waters Edge Drive, Suite 235
 Raleigh, NC 27606 (919) 233-8125

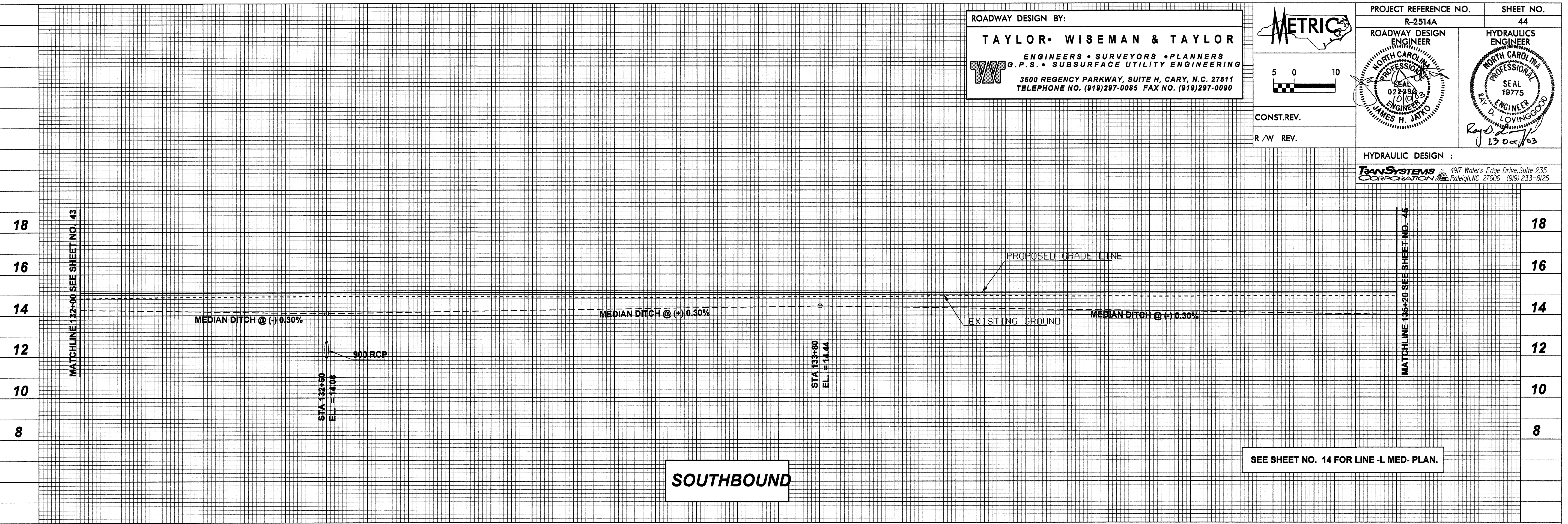

| PLAN SUMMARY DATA | | |
|-----------------------|---------|-----|
| STA. 132+60 -L MED- | | |
| DRAINAGE AREA | = 2.9 | HA |
| DESIGN FREQUENCY | = 50 | YRS |
| DESIGN DISCHARGE | = 0.70 | CMS |
| DESIGN HW ELEVATION | = 12.99 | M |
| 100 YEAR DISCHARGE | = 0.75 | CMS |
| 100 YEAR HW ELEVATION | = 12.99 | M |
| OVERTOPPING FREQUENCY | = 500+ | YRS |
| OVERTOPPING DISCHARGE | = 2.96 | CMS |
| OVERTOPPING ELEVATION | = 15.28 | M |

