

PLAN SUMMARY DATA		
STA. 189+25 -L MED-		
DRAINAGE AREA	= 2.5	HA
DESIGN FREQUENCY	= 50	YRS
DESIGN DISCHARGE	= 0.38	CMS
DESIGN HW ELEVATION	= 13.23	M
100 YEAR DISCHARGE	= 0.41	CMS
100 YEAR HW ELEVATION	= 13.26	M
OVERTOPPING FREQUENCY	= 500+	YRS
OVERTOPPING DISCHARGE	= 0.87	CMS
OVERTOPPING ELEVATION	= 14.07	M

BM 14 R/R SPIKE IN 12" PINE LOCATED  
15.48M LT. OF BL STA 91+58.23  
Elev. = 13.77

ROADWAY DESIGN BY:  
**TAYLOR • WISEMAN & TAYLOR**  
ENGINEERS • SURVEYORS • PLANNERS  
G.P.S. • SUBSURFACE UTILITY ENGINEERING  
3500 REGENCY PARKWAY, SUITE H, CARY, N.C. 27511  
TELEPHONE NO. (919)297-0085 FAX NO. (919)297-0090

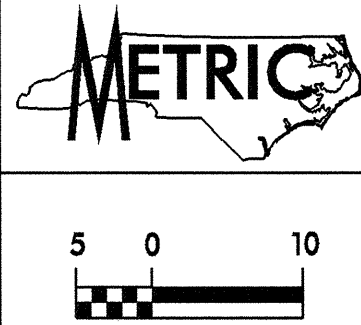

PROJECT REFERENCE NO. R-2514A	SHEET NO. 61
ROADWAY DESIGN ENGINEER JAMES H. JAYO	HYDRAULICS ENGINEER R. D. LOVINGS

HYDRAULIC DESIGN :  
**TAN SYSTEMS CORPORATION**  
4917 Waters Edge Drive, Suite 235  
Raleigh, NC 27606 (919) 233-8125

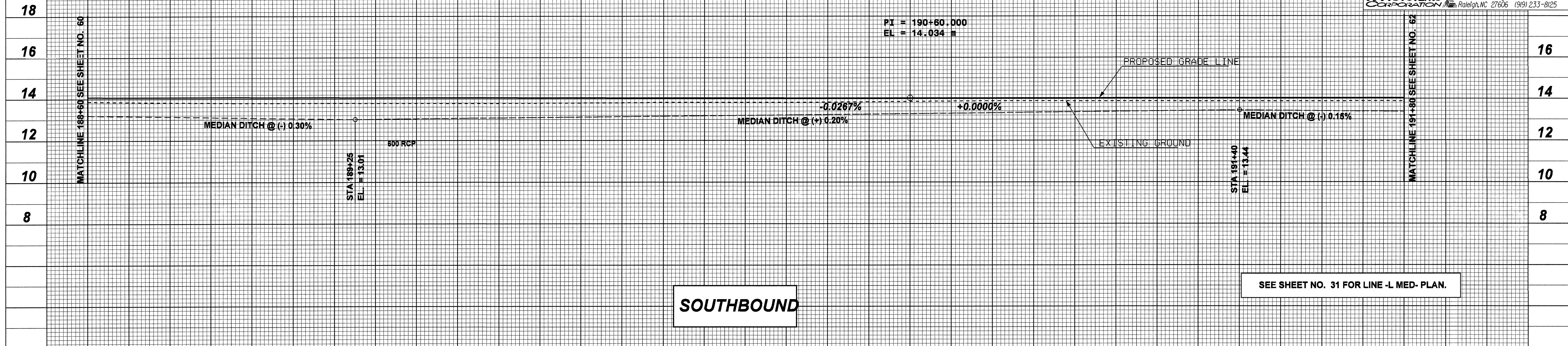

**SOUTHBOUND**

SEE SHEET NO. 31 FOR LINE -L MED- PLAN.

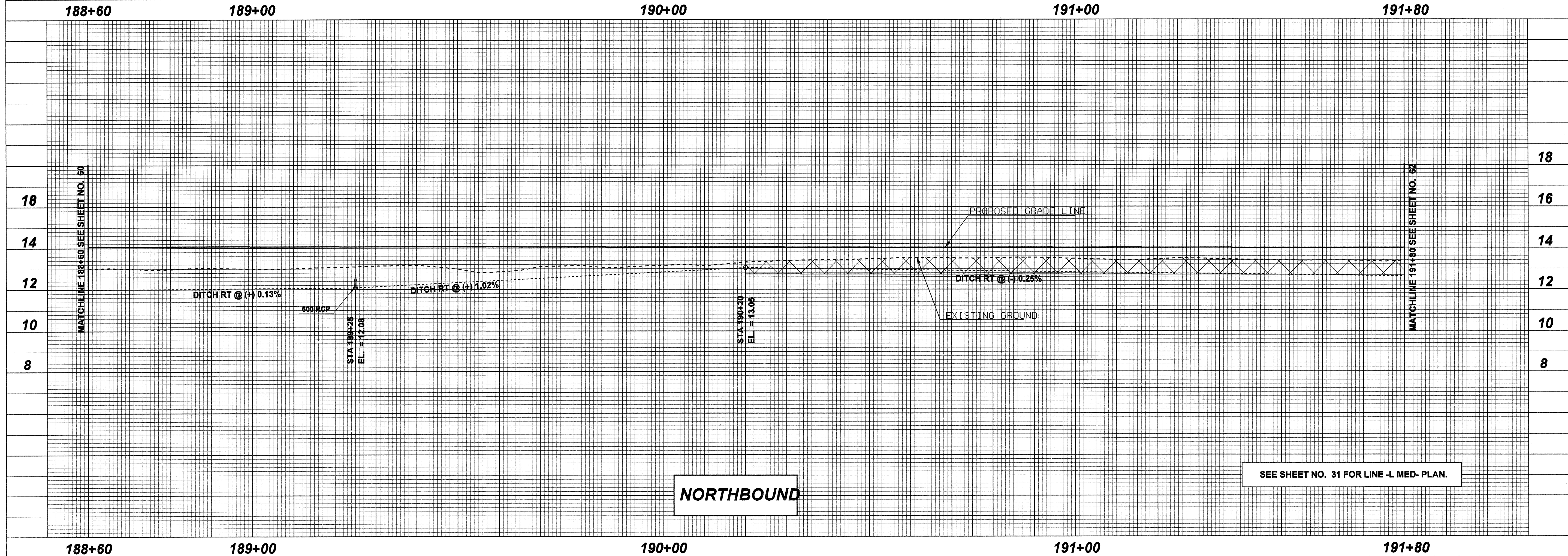

**NORTHBOUND**

SEE SHEET NO. 31 FOR LINE -L MED- PLAN.