

REVISIONS

TAYLOR WISEMAN & TAYLOR
ENGINEERS • SURVEYORS • PLANNERS
G.P.S. • SUBSURFACE UTILITY ENGINEERING
4912 WATERS EDGE DRIVE, SUITE 125, RALEIGH, N.C. 27606
TELEPHONE NO. (919)852-8232 FAX NO. (919)852-4235

METRIC

CONST. REV.
R/W REV.

PROJECT REFERENCE NO. R2514-A	SHEET NO. 20
R/W SHEET NO.	HYDRAULICS ENGINEER
ROADWAY DESIGN ENGINEER	

HOFFMAN FOREST
BOARD OF TRUSTEES N.C.S.U.
DB.170, PG.263
MB 1, PG.11

3.6m BASE CHANNEL
20m ALONG EXISTING SLOPE
SEE CHANNEL IMPROVEMENT
DETAIL "AT OUTLET"

CLASS I RIPRAP
EST. 50 METRIC TONS
FOR 8m W/ F.F.
EACH BANK

MATCHLINE STA 159 + 60 SEE SHEET 19

MATCHLINE STA 133 + 40 SEE SHEET 21

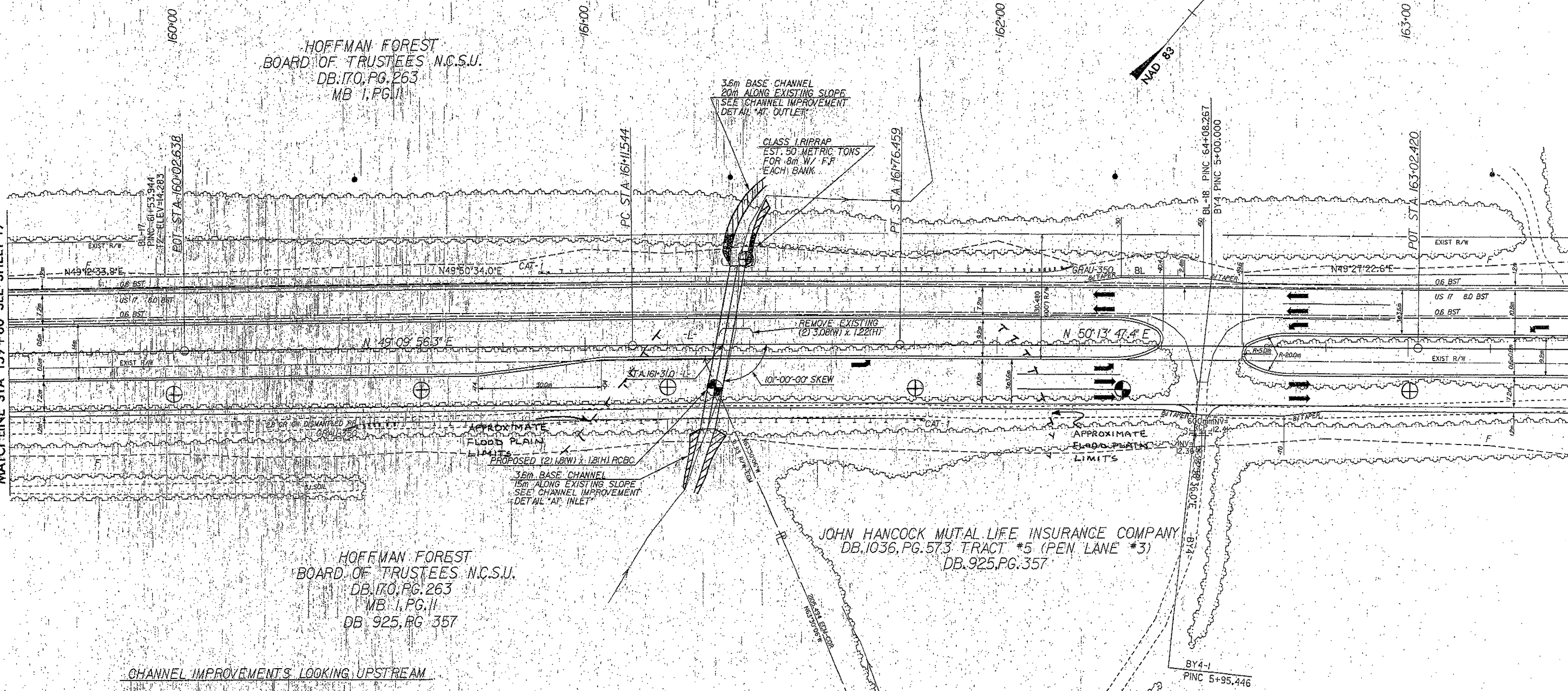

HOFFMAN FOREST
BOARD OF TRUSTEES N.C.S.U.
DB.170, PG.263
MB 1, PG.11
DB 925, PG 357

JOHN HANCOCK MUTUAL LIFE INSURANCE COMPANY
DB.1036, PG.573 TRACT #5 (PEN. LANE #3)
DB.925, PG.357

CHANNEL IMPROVEMENTS LOOKING UPSTREAM



-L-
PI Sta: 161+44.003
Δ = 1.03' 51" (RT)
L = 649.15'
T = 32.459'
R = 3,495.000'
SE = NC

SEE SHEET NO. 47 FOR NB & SB GRADES AND PROFILES.

19-MAR-1998 16:43
C:\p01\151\1001\cgm\p1520.dgn
car