	PROJECT REFERENCE NO.	SHEET NO.
	R-2514A	EC-53/CONST. 22
ROADWAY DESIGN ENGINEER		HYDRAULICS ENGINEER
CONST. REV.		
R/W REV.		

NOTE:
TEMPORARY SILT FENCE SHALL BE INSTALLED A MINIMUM OF 1 METER FROM TOE OF FILL IN WETLAND AREAS

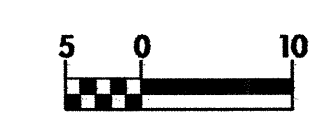

MATCHLINE STA 158+20 SEE SHEET 21

MATCHLINE STA 161+60 SEE SHEET 23

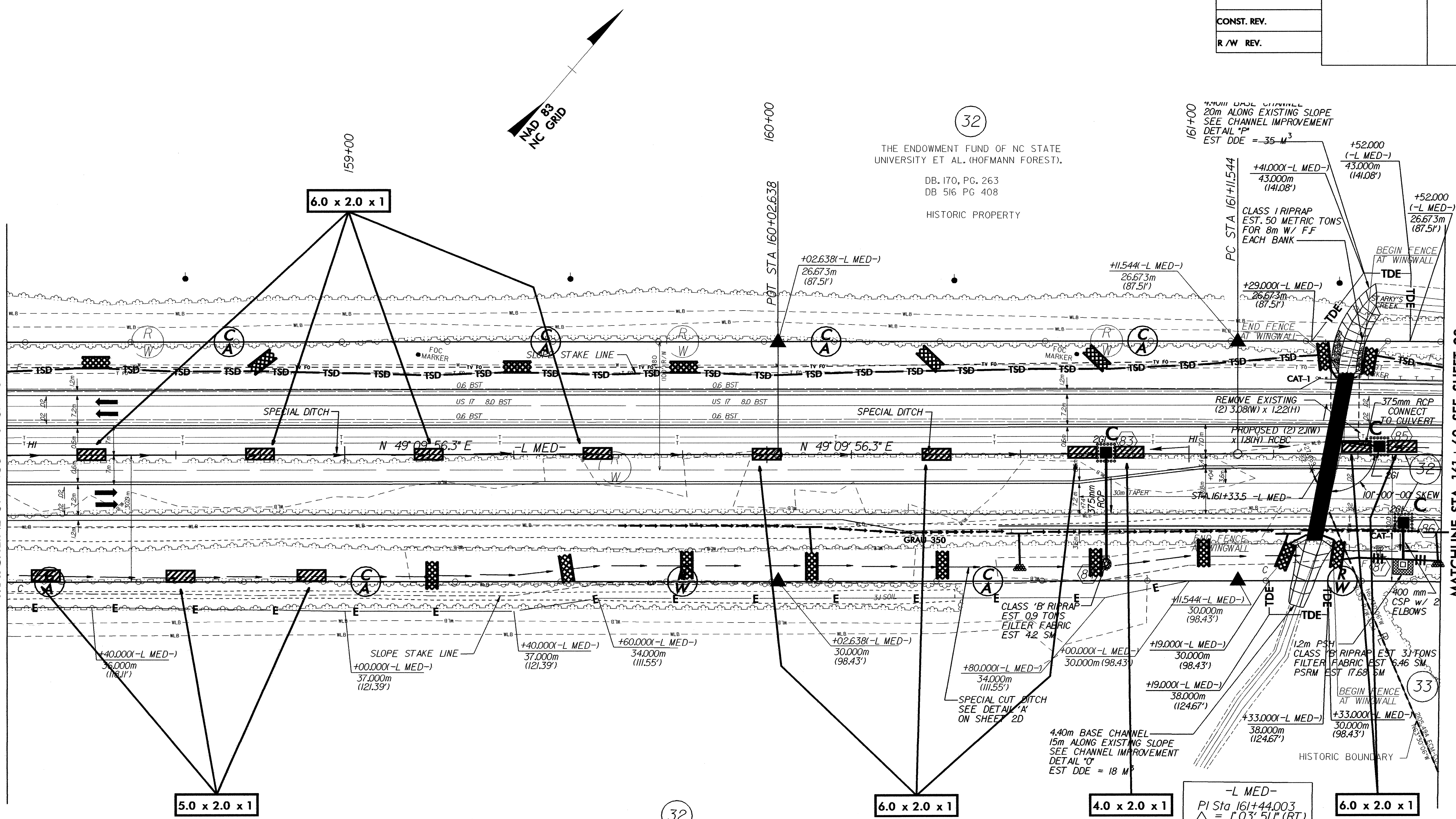

THE ENDOWMENT FUND OF NC STATE UNIVERSITY ET AL. (HOFMANN FOREST).
DB. 170, PG. 263
DB 516 PG 408
HISTORIC PROPERTY

4.40M BASE CHANNEL
15m ALONG EXISTING SLOPE
SEE CHANNEL IMPROVEMENT
DETAIL 'O'
EST DDE = 18 M³

4.40M BASE CHANNEL
20m ALONG EXISTING SLOPE
SEE CHANNEL IMPROVEMENT
DETAIL 'P'
EST DDE = 35 M³

CLASS 1 RIPRAP
EST. 50 METRIC TONS
FOR 8m W/ F.F
EACH BANK

CLASS 'B' RIPRAP
EST. 0.9 TONS
FILTER FABRIC
EST. 4.2 SM

CLASS 'B' RIPRAP
EST. 3.1 TONS
FILTER FABRIC
EST. 6.46 SM
PSRM
EST. 17.68 SM

400 mm
CSP w/ 2
ELBOWS

1.2m PSH
CLASS 'B' RIPRAP
EST. 3.1 TONS
FILTER FABRIC
EST. 6.46 SM
PSRM
EST. 17.68 SM

-L MED-
PI Sta 161+44.003
Δ = 1° 03' 51" (RT)
L = 64.915
T = 32.459
R = 3,495.000
SE = NC

THE ENDOWMENT FUND OF NC STATE UNIVERSITY ET AL. (HOFMANN FOREST).
DB. 170, PG. 263
DB 516 PG 408
HISTORIC PROPERTY

SEE SHEET C- THROUGH SHEET C- FOR CULVERT DETAILS

SEE SHEET NO. 2D FOR ALL DITCH DETAILS.

SEE SHEET NO. 2D FOR ALL DRIVEWAY DETAILS.

SEE SHEET NO. 52 FOR NBL & SBL GRADES AND PROFILES AND ALL DITCH GRADES AND PROFILES.