

SECTION A-A

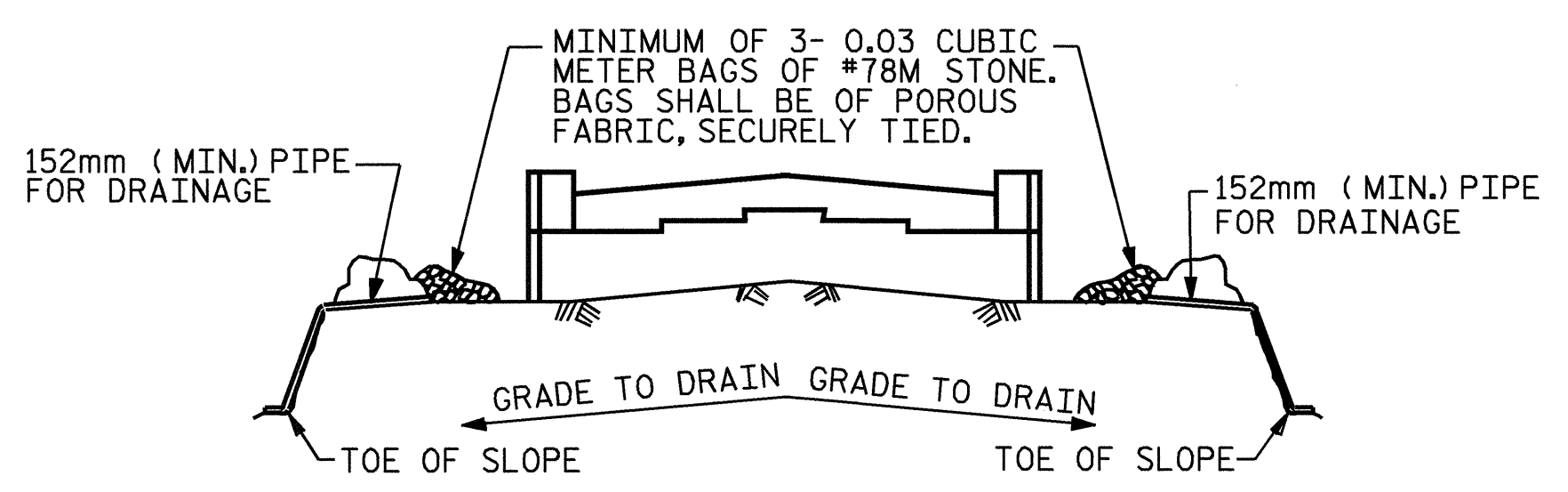

BAGGED STONE AND PIPE SHALL BE PLACED IMMEDIATELY AFTER COMPLETION OF END BENT EXCAVATION. PIPE MAY BE EITHER CONCRETE, CORRUGATED STEEL, CORRUGATED ALUMINUM ALLOY, OR CORRUGATED PLASTIC. PERFORATED PIPE WILL NOT BE ALLOWED.

BAGGED STONE SHALL REMAIN IN PLACE UNTIL THE ENGINEER DIRECTS THAT IT BE REMOVED. THE CONTRACTOR SHALL REMOVE AND DISPOSE OF SILT ACCUMULATIONS AT BAGGED STONE WHEN SO DIRECTED BY THE ENGINEER. BAGS SHALL BE REMOVED AND REPLACED WHENEVER THE ENGINEER DETERMINES THAT THEY HAVE DETERIORATED AND LOST THEIR EFFECTIVENESS.

NO SEPARATE PAYMENT WILL BE MADE FOR THIS WORK AND THE ENTIRE COST OF THIS WORK SHALL BE INCLUDED IN THE UNIT CONTRACT PRICE FOR THE SEVERAL PAY ITEMS.

TEMPORARY DRAINAGE AT END BENT

DRAWN BY: A.K.P. & E.G.A. DATE: 5/25/04
CHECKED BY: A.L. MEADOWS DATE: 6/8/04

BAR TYPES

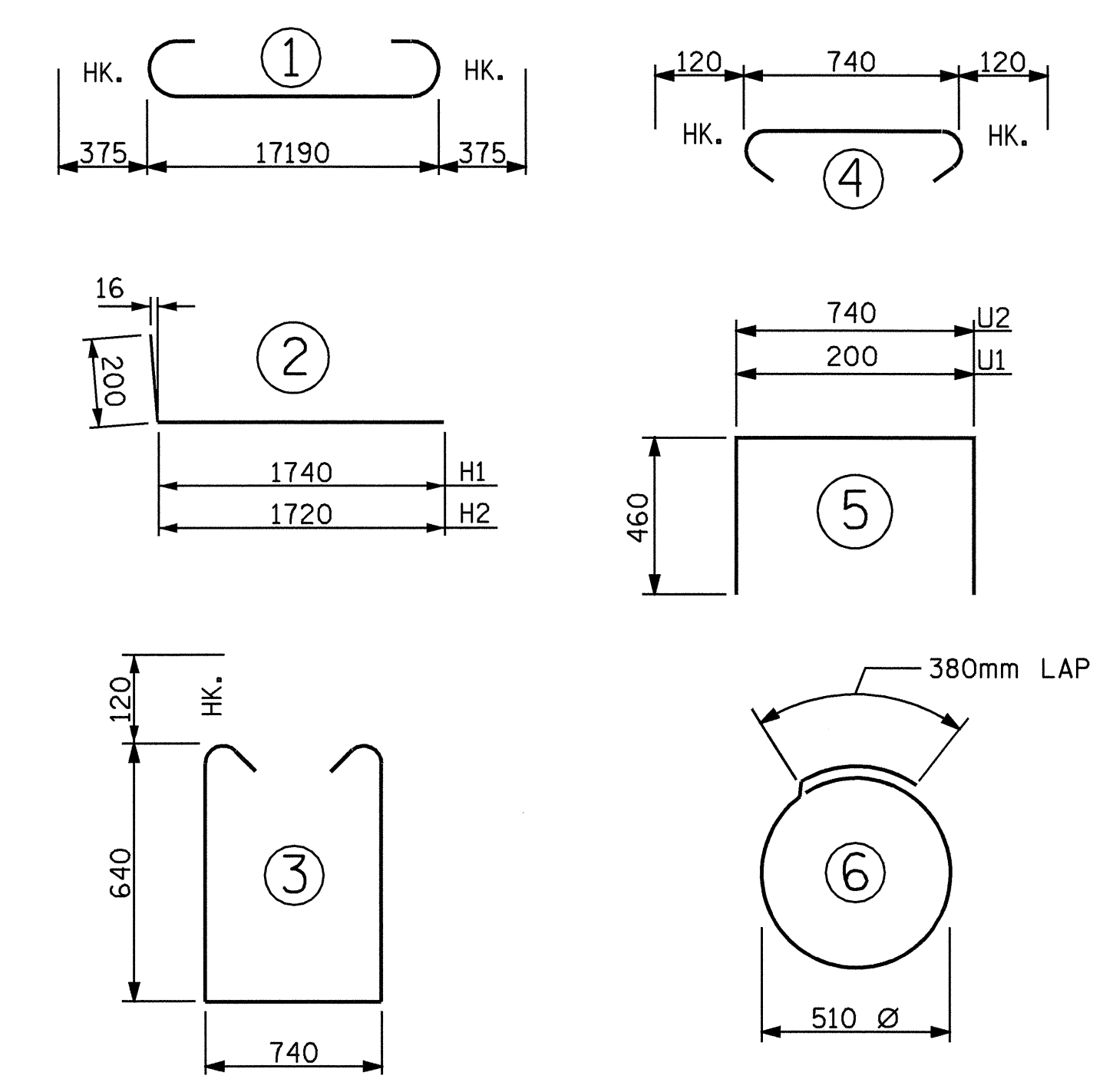

ALL BAR DIMENSIONS ARE OUT TO OUT.

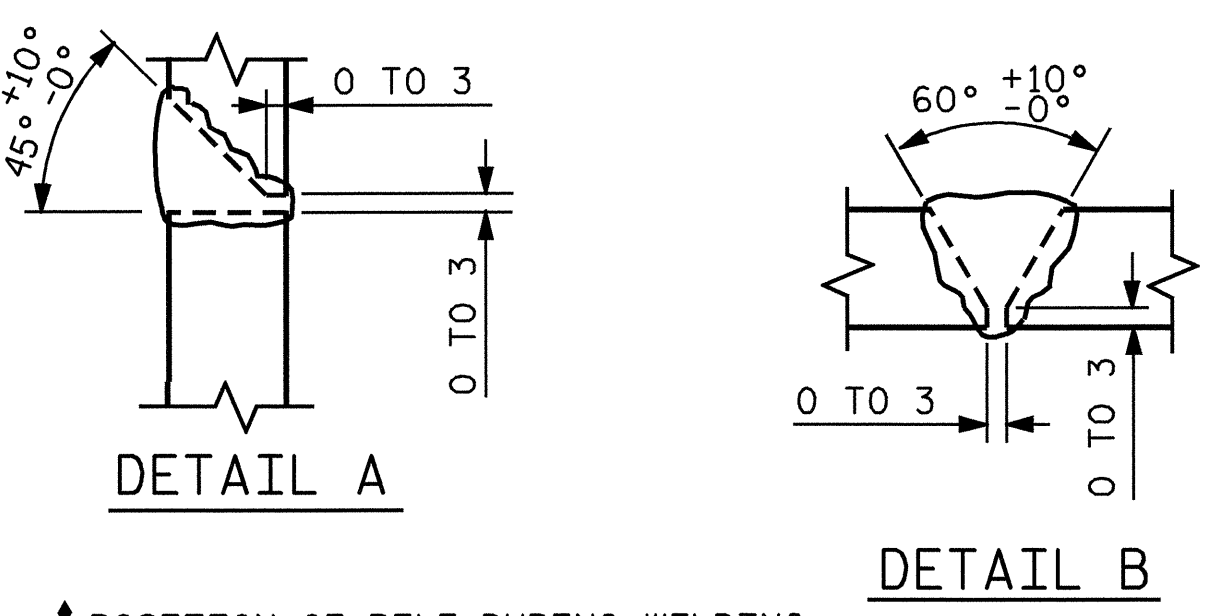
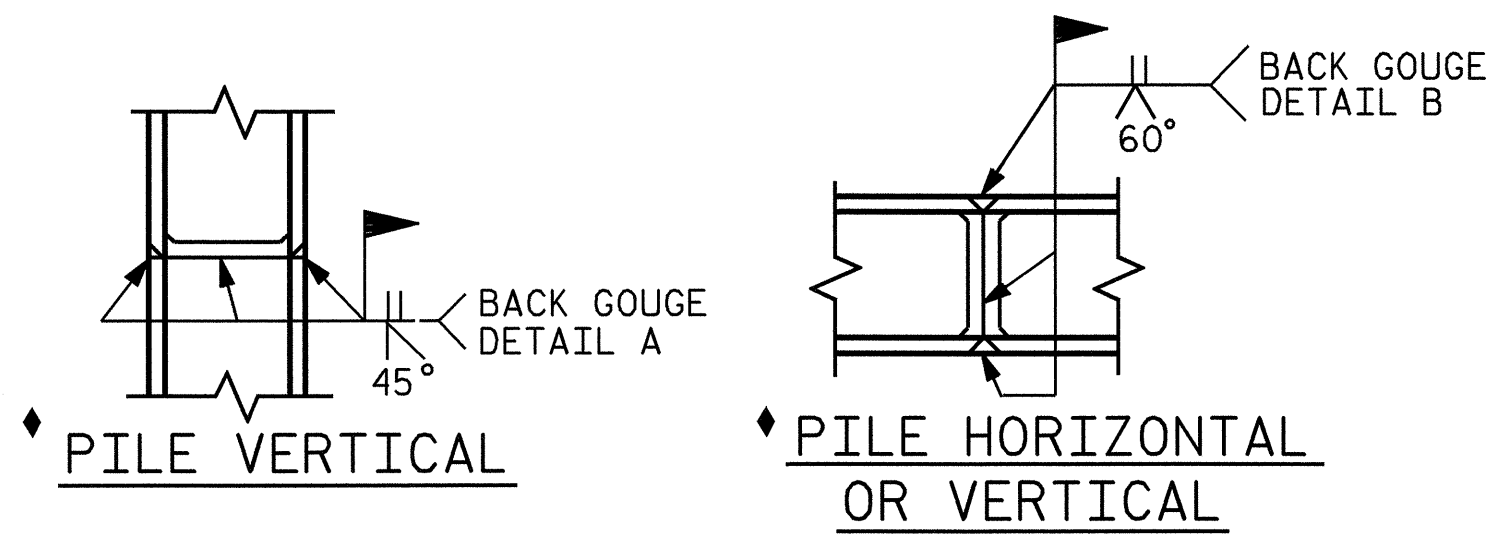

PILE SPLICE DETAILS

BILL OF MATERIAL					
END BENT 2					
BAR	NO.	SIZE	TYPE	LENGTH	WEIGHT
B1	8	29	1	17940	726
B2	2	16	STR	17200	52
B3	12	13	STR	6280	75
B4	15	13	STR	740	11
B5	4	13	STR	3580	14
B6	8	13	STR	900	7
H1	20	13	2	1940	39
H2	20	13	2	1920	38
K1	30	13	STR	6280	187
K2	8	13	STR	880	7
S1	64	13	3	2260	144
S2	64	13	4	980	62
S3	20	13	6	1980	39
U1	52	13	5	1120	58
U2	15	13	5	1660	25
V1	104	16	STR	1840	287
V2	40	13	STR	2240	88
TOTAL REINFORCING STEEL					Kg. 1860
CLASS A CONCRETE BREAKDOWN					
POUR 1 CAP & LOWER					
PART OF WINGS					12.8 m ³
POUR 2 BACKWALL & UPPER					
PART OF WINGS					8.1 m ³
TOTAL CLASS A CONCRETE					20.9 m ³
HP 310 x 79 STEEL PILES					
No. 10 80 METERS					

PROJECT NO. B-2583
MADISON COUNTY
STATION: 11+03.000 -Y1-

SHEET 3 OF 3

STATE OF NORTH CAROLINA
DEPARTMENT OF TRANSPORTATION
RALEIGH
**SUBSTRUCTURE
END BENT 2**

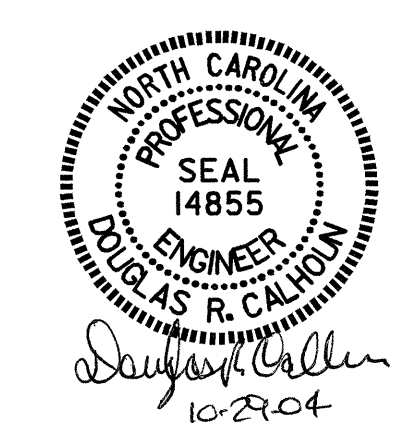

REVISIONS					
NO.	BY:	DATE:	NO.	BY:	DATE:
1			3		
2			4		

SHEET NO. **S-103**
TOTAL SHEETS **112**