

REVISIONS

-L-

<i>Pls Sta 31+16.313</i>	<i>Pl Sta 34+39.865</i>	<i>Pls Sta 37+60.237</i>
$\theta_s = 0^\circ 59' 01.0''$	$\Delta = 14^\circ 31' 22.5''$ (LT)	$\theta_s = 0^\circ 59' 01.0''$
$L_s = 80.000$	$L = 590.591$	$L_s = 80.000$
$LT = 53.334$	$T = 296.887$	$LT = 53.334$
$ST = 26.667$	$R = 2,330.000$	$ST = 26.667$
	$SE = 0.03$	
	$RO = 80.000$	

METRIC

5 0 10

CONST. REV.

R/W REV.

PROJECT REFERENCE NO. R-2206AA	SHEET NO. 10
R-2206A SHEET NO. 10	HYDRAULICS ENGINEER
ROADWAY DESIGN ENGINEER NORTH CAROLINA PROFESSIONAL SEAL 15356 RONALD DAVID ALLEN 10-8-04	HYDRAULICS ENGINEER NORTH CAROLINA PROFESSIONAL SEAL 3884 HENRY WELLS, JR. 10-21-04

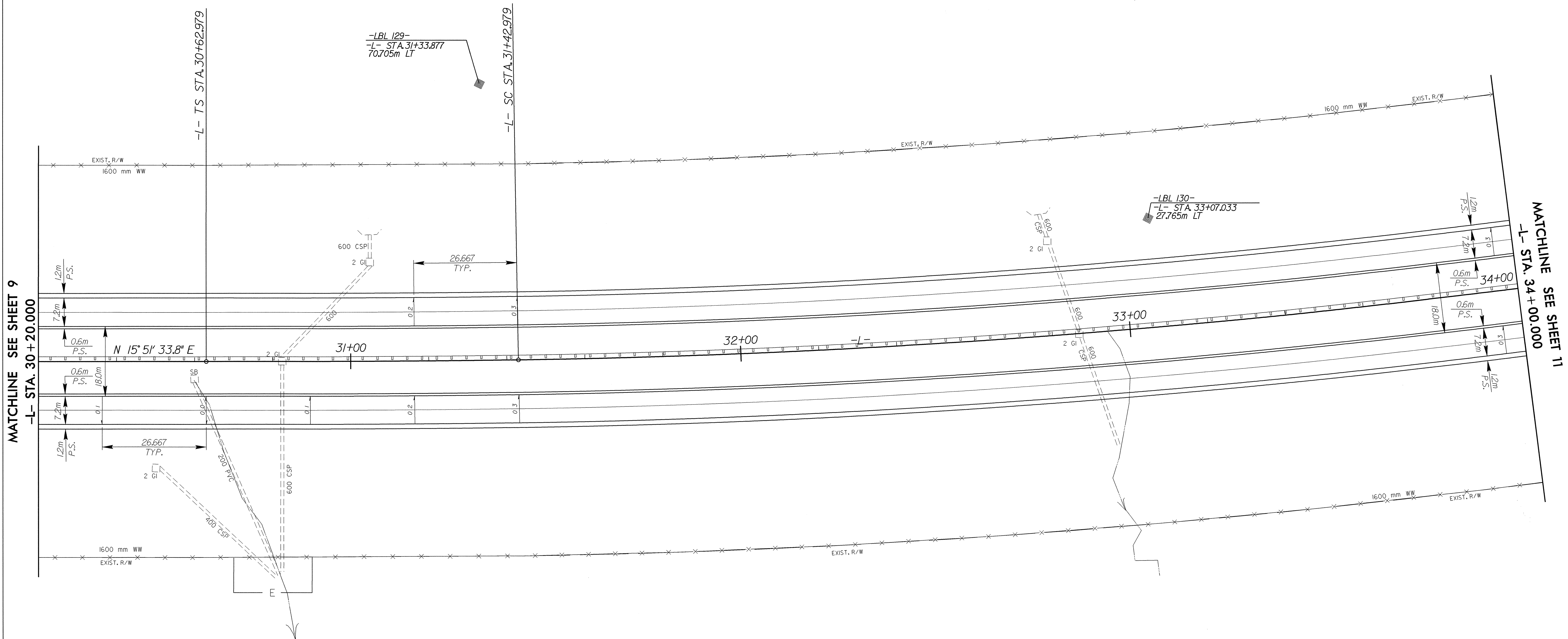
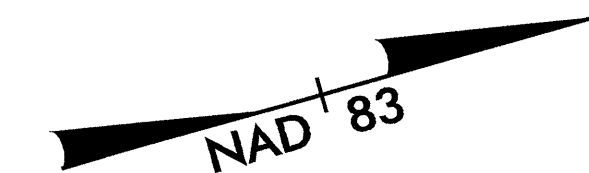

MATCHLINE SEE SHEET 9
-L- STA. 30+20.000

MATCHLINE SEE SHEET 11
-L- STA. 34+00.000

SEE SHEETS 37 & 38 FOR -L- PROFILE

30-SEP-2004 15:41 2286seal0.psh
SECalhoun AT RD192296