

REVISIONS

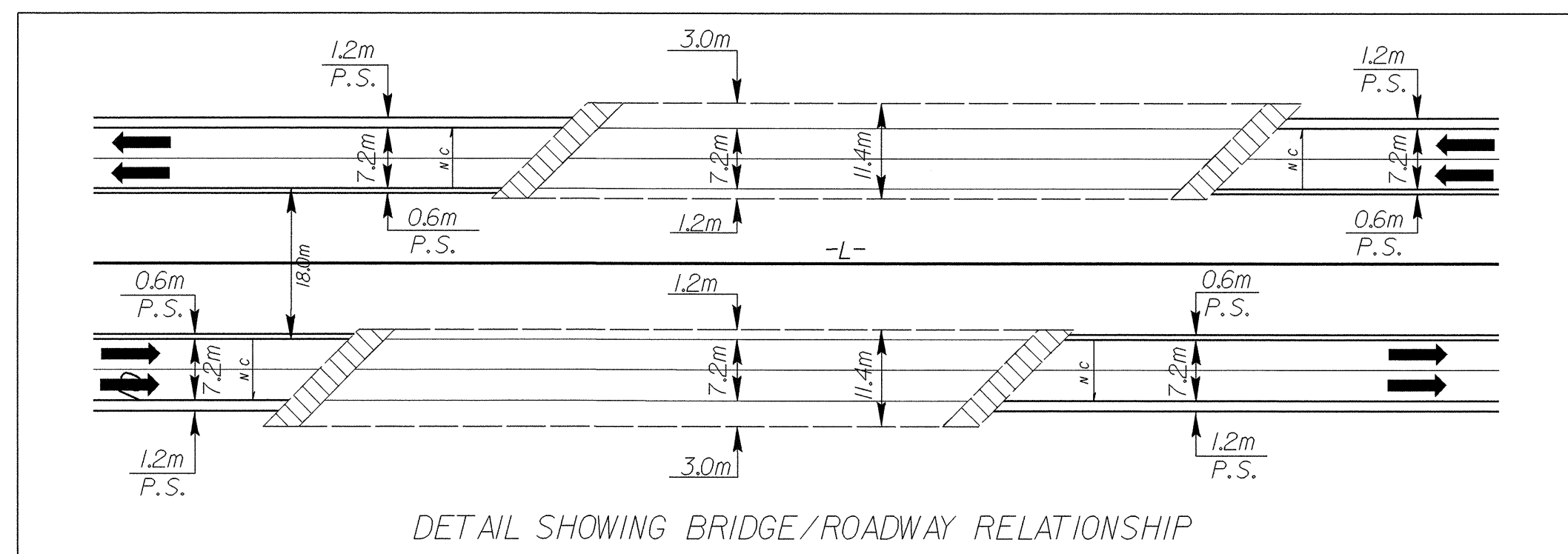

Pls Sta 69+96.316  
 $\Theta_s = 3^\circ 28' 43.2''$   
 $L_s = 85.000$   
 $LT = 56.678$   
 $ST = 28.343$

PI Sta 72+05.846  
 $\Delta = 29^\circ 01' 36.6'' (LT)$   
 $L = 354.630$   
 $T = 181.207$   
 $R = 700.000$   
 $SE = 0.07$   
 $RO = 85.000$

Pls Sta 74+07.611  
 $\Theta_s = 3^\circ 28' 43.2''$   
 $L_s = 85.000$   
 $LT = 56.678$   
 $ST = 28.343$

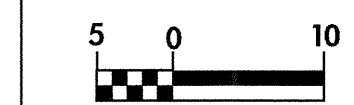

CONST. REV.  
 R / W REV.

PROJECT REFERENCE NO. R-2206AA	SHEET NO. 20
ROADWAY DESIGN ENGINEER NORTH CAROLINA PROFESSIONAL SEAL BEAR 45356 DAVID ALLEN	HYDRAULICS ENGINEER NORTH CAROLINA PROFESSIONAL SEAL 9334 HENRY WELLS, JR.

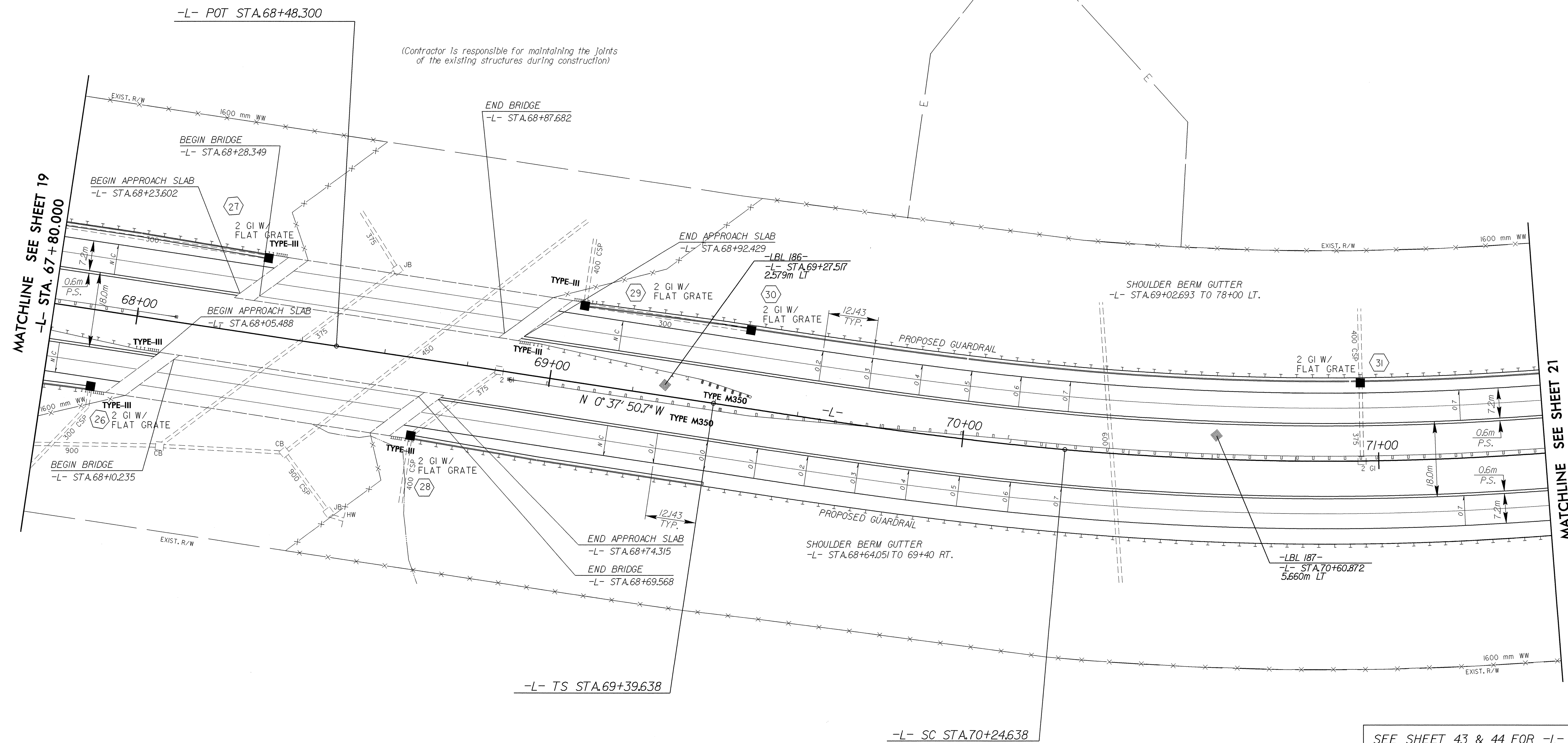

SEE SHEET 43 & 44 FOR -L- PROFILE

11-001-2004 1445 2206aa20.psh  
 SEC:calhoun 10/07/04 10:52:26